

TWD710P

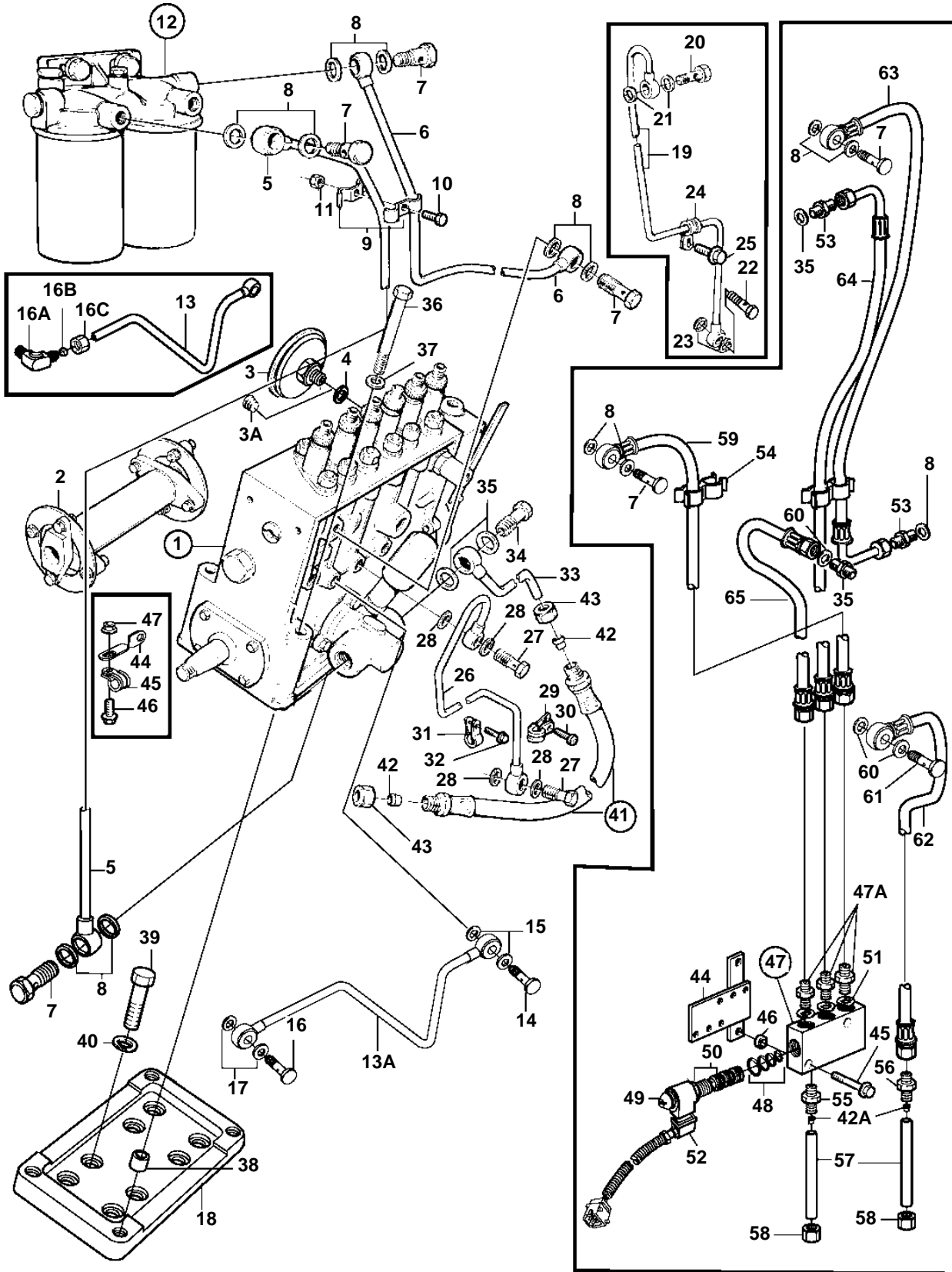

17541

A

TWD710P

REF	PART NO.	QTY	DESCRIPTION	SEE SEC.	NOTES
1	866382	1	Injection pump		REPL BY 3826154
			• Comps. not spec.		
	3826154	1	Injection pump		
	3803739	1	Injection pump, exch, exch		
				3242	
			• Comps. not spec.		
2		1	Pump companion	3852	
3	477173	1	Pressure equalizer		
3A	960630	1	Plug		
4	969011	1	Gasket		
5	471484	1	Fuel pipe		
6	471603	1	Fuel pipe		
7	25167	4	Hollow screw		
8	969011	8	Gasket		
9	404279	4	Clamp		
10	956095	2	Screw		
11	955781	2	Nut		
12		1	Fuel filter	2957	
13	471608	1	Oil feed pipe		EARLY TYPE
13A	477908	1	Oil feed pipe		SN-2071064646
13	477986	1	Oil feed pipe		SN2071064647-
14	48634	1	Hollow screw		
15	947281	2	Gasket		SN-2071064646
	11994	2	Gasket		SN2071064647-
16	48634	1	Hollow screw		SN-2071064646
	969299	1	Hollow screw		SN2071064647-
16A	479958	1	Elbow nipple		EARLY TYPE
16B	954364	1	Fitting		EARLY TYPE
16C	954356	1	Cap nut		EARLY TYPE
17	947281	2	Gasket		SN-2071064646
	11994	2	Gasket		SN2071064647-
18	477773	1	Shelf		
19	865274	1	Oil return pipe		SN2071074713-
20	48634	1	Hollow screw		SN2071074713-
21	907132	2	Gasket		SN2071074713-
22	25167	1	Hollow screw		SN2071074713-
23	969011	2	Gasket		SN2071074713-
24	947191	1	Clamp		SN2071074713-
25	946471	1	Screw		SN2071074713-
26	3826927	1	Oil return pipe		SN-2071074712
27	25167	2	Hollow screw		SN-2071074712
28	969011	4	Gasket		SN-2071074712
29	942542	1	Clamp		SN-2071074712
30	946471	1	Screw		SN-2071074712
31	18387	1	Clamp		SN-2071074712
32	944926	1	Flange screw		SN-2071074712
33	849229	1	Fuel pipe		
34	25167	1	Hollow screw		
35	969011	2	Gasket		
36	965189	4	Flange screw		
37	190509	4	Washer		
38	417588	3	Guide sleeve		
39	965185	4	Flange screw		
40	941908	4	Spring washer		
41	865737	2	Fuel hose		
42	956969	4	• Ferrule		
42A	956969	2	Ferrule		
43	956983	4	• Nut		
44	3826159	1	Bracket		
45	969313	2	Flange screw		
46	822779	2	Spacer sleeve		
47	3828983	1	Shut-off valve		

7745700 - 23 - 3844

17541

Upd: 2006-11-02

TWD610P, TWD710P, TAD730P

**VOLVO**  
**PENTA**

TWD710P

REF	PART NO.	QTY	DESCRIPTION	SEE SEC.	NOTES
47A	941754	4	· Nipple		
48	3828981	1	· O-ring kit		
49	3825240	1	· Magnet		
50	3828979	1	· Valve		
51	969011	4	· Gasket		
52	866927	1	Cable kit		
53	941754	2	Nipple		
54	866663	3	Clamp		
55	977677	1	Nipple		
56	957055	1	Nipple		
57	3825770	2	Fuel pipe		
58	956983	2	Nut		
59	3826284	1	Fuel hose		Fuel shut off valve - injection pump
60	969011	2	Gasket		
61	25167	1	Hollow screw		
62	3826284	1	Fuel hose		Fuel return line
63	3825721	1	Fuel hose		Fuel feed pump - fuel filter
64	3825722	1	Fuel hose		Fuel shut off valve - fuel filter
65	3825604	1	Fuel hose		Stop solenoid energized to run., Fuel shut off valve - fuel feed pump
	3825848	1	Fuel hose		Fuel shut off valve - fuel feed pump, Stop solenoid energized to stop.