

TID162AG, TID162AGP

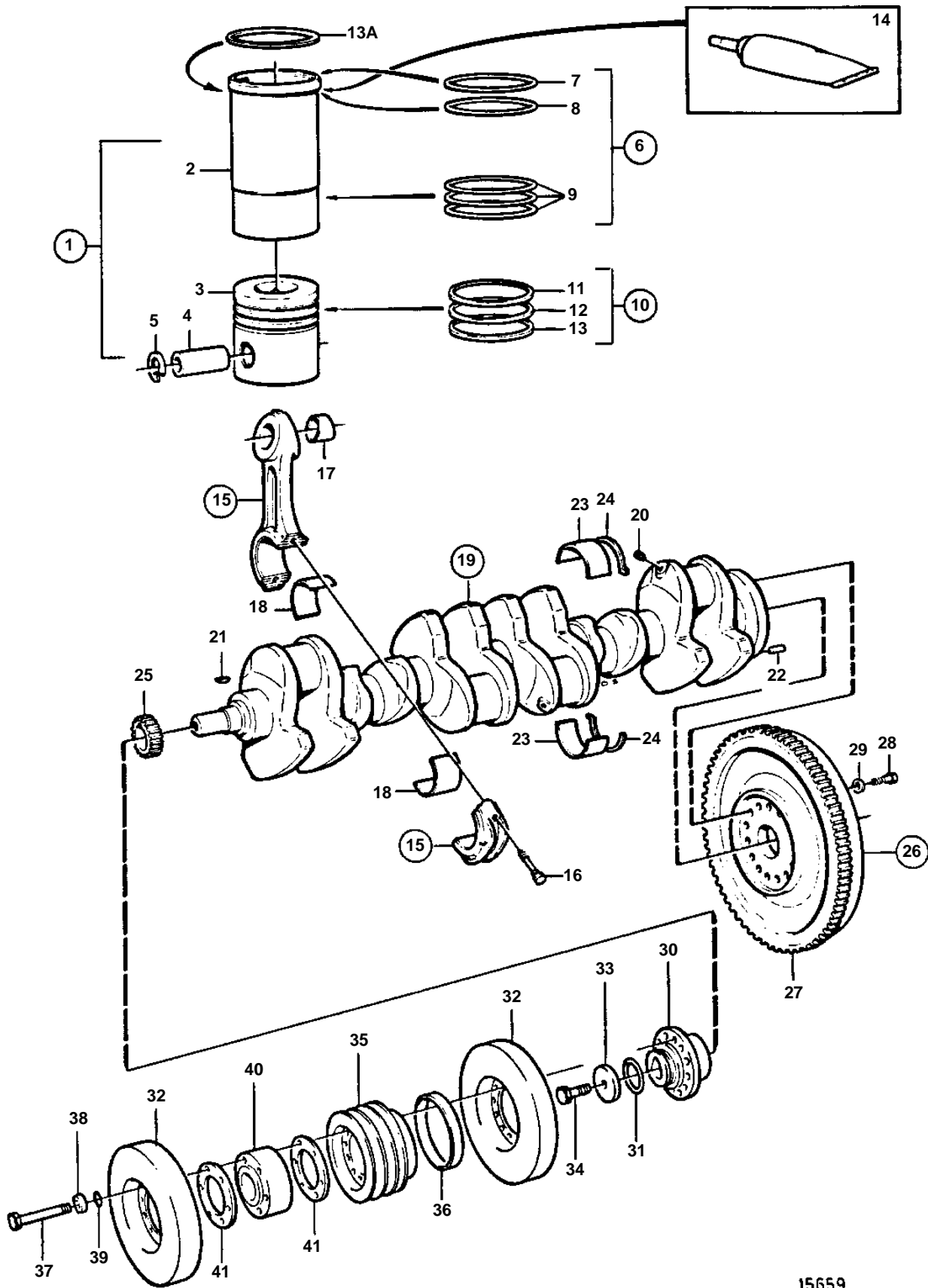

15659

TID162AG, TID162AGP

REF	PART NO.	QTY	DESCRIPTION	NOTES
1	876601	6	Cylinder liner kit	SN-XXXXXXXXXXXX/5894
	876595	6	Cylinder liner kit	SNXXXXXXXXXXXX/5895-
2		6	· Cylinder liner	SN-XXXXXXXXXXXX/5894
		6	· Cylinder liner	SNXXXXXXXXXXXX/5895-
3		6	· Piston	
4	1556940	6	· Piston pin	(1556200) L=120mm
5	914532	12	· Snap ring	
6	270935	6	· Sealing ring kit	
7		6	· · Sealing ring	
8		6	· · Sealing ring	
9		18	· · Sealing ring	
10	3826935	6	· Piston ring kit	
11		6	· · Compression ring	
12		6	· · Compression ring	
13		6	· · Oil scraper ring	
13A	1548125	X	Shim	TH=0,20mm
	1548126	X	Shim	TH = 0,30mm
	1548127	X	Shim	TH = 0,50mm
14	1161277	X	Sealant	10g
15	863794	6	Connecting rod	
16	1543035	12	· Screw	
17	1543034	6	· Bushing	
18	270796	6	Big end bearing kit	STD D
	270797	6	Big end bearing kit	U.S=0,25mm
	270798	6	Big end bearing kit	U.S=0,50mm
	270799	6	Big end bearing kit	U.S=0,75mm
19	863792	1	Crankshaft	
20	978130	6	· Plug	
21	422253	1	· Woodruff key	
22	950645	1	· Pin	
	270792	7	Main bearing kit	STD D
	270793	7	Main bearing kit	U.S=0,25mm
	270794	7	Main bearing kit	U.S=0,50mm
	270795	7	Main bearing kit	U.S=0,75mm
24	270929	1	Thrust washer kit	STD D
	270930	1	Thrust washer kit	O.S=0,10mm
	270931	1	Thrust washer kit	O.S=0,20mm
	270932	1	Thrust washer kit	O.S=0,30mm
25	1543444	1	Gear	
26	3825678	1	Flywheel	(849115)
27	8193939	1	· Gear ring	
28	849912	14	Screw	
29	1543563	14	Washer	
30	848851	1	Hub	
31	945512	1	O-ring	
32	1543834	2	Vibration damper	
33	422124	1	Washer	
34	862504	1	Screw	
35	3825893	1	V-belt pulley	3 GROOVE. Earlier production of 6 ea of screw is replaced by 12 ea screw.
36	3829683	1	· Wear ring	
37	973253	12	Screw	Earlier production of 6 ea of screw is replaced by 12 ea screw.
38	4956010	12	Washer	Earlier production of 6 ea of screw is replaced by 12 ea screw.
39	955974	12	O-ring	Earlier production of 6 ea of screw is replaced by 12 ea screw.
40	862616	1	Hub	Replaced by 1 ea 3825885 hub, 1 ea 3825893 pulley, 2 ea 3825886 gasket, 6 ea 973253 screw, 6 ea 4956010 washer and 12 ea 955974 o-ring.
	3825885	1	Hub	
41	3825886	2	Gasket	Earlier production of 6 ea of screw is replaced by 12 ea screw.