

TID120FG, TID120F PP

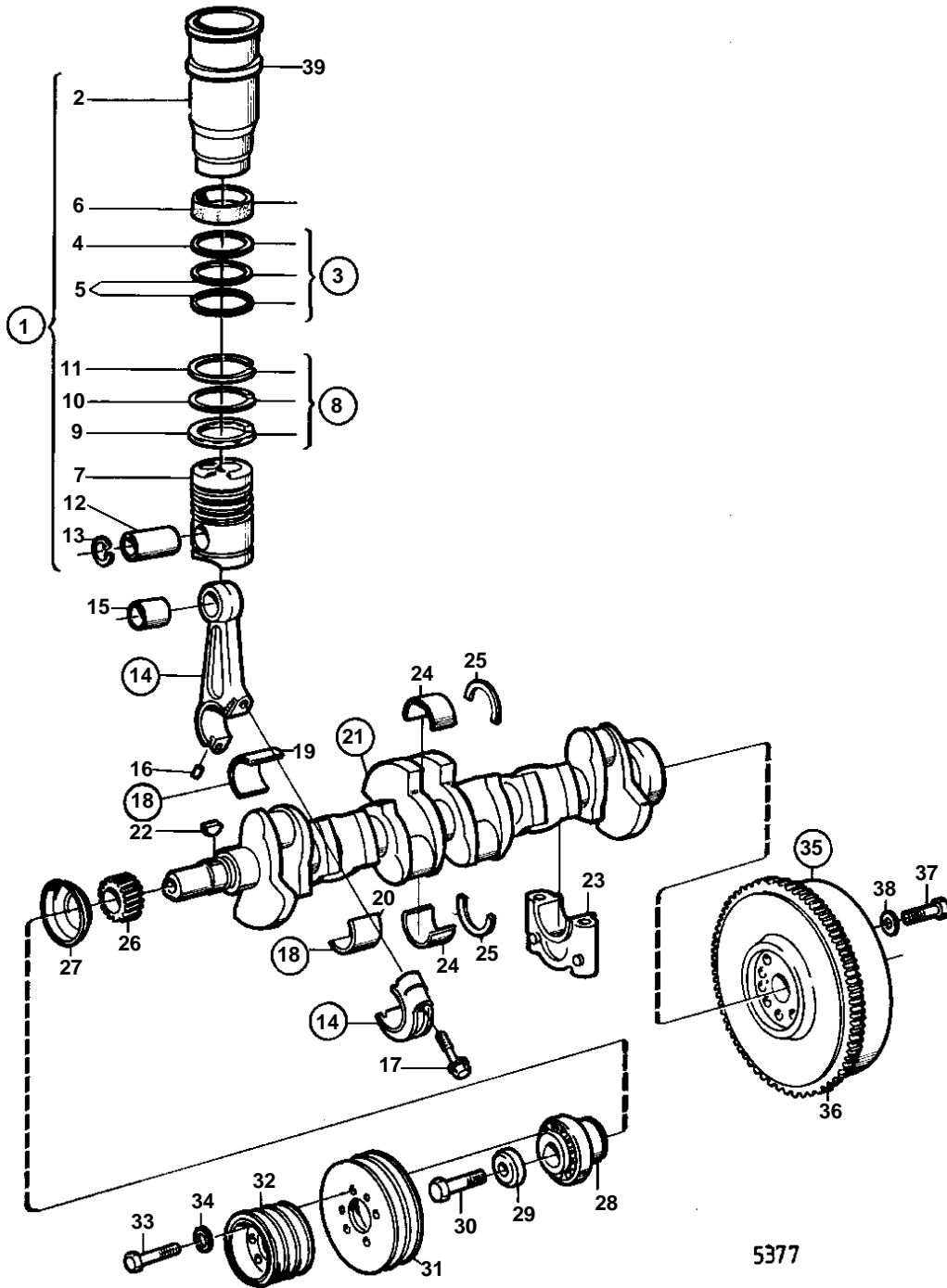

5377

TID120FG,TID120F PP

REF	PART NO.	QTY	DESCRIPTION	SEE SEC.	NOTES
1	275059	6	Cylinder liner kit		
2		6	· CYLINDER LINER	IK	
3	275730	6	· Sealing ring kit	IK	
4		6	· · SEAL RING	IK	
5		12	· · SEAL RING	IK	
6	468582	6	· · Protecting ring	IK	
7		6	· PISTON	IK	
8	275321	6	· Piston ring kit	IK	
9		6	· · OIL RING	IK	
10		6	· · COMPRESSION RING	IK	
11		6	· · COMPRESSION RING	IK	
12	423342	6	· Piston pin	IK	
13	423124	12	· Lock ring	IK	
14	822530	6	Connecting rod		
15	423147	6	· Bushing		
16	131205	12	· Pin		
17	417464	12	· Screw		
18	270105	6	Big end bearing kit		STD D
	270106	6	Big end bearing kit		0.25MM U.S
	270107	6	Big end bearing kit		0.50MM U.S
	270108	6	Big end bearing kit		0,75MM U.S
19		6	· BEARING SHELL, UPPER		
20		6	· BEARING SHELL, LOWER		
21	846444	1	Crankshaft		(837641)
22	422253	1	· Woodruff key		
23		7	BEARING CAP	02A-0301	
24	270449	7	Main bearing kit		STD
	270450	7	Main bearing kit		0,25MM U.S
	270451	7	Main bearing kit		0,50MM U.S
	270452	7	Main bearing kit		0,75MM U.S
25	276791	1	Thrust washer kit		STD D
	276792	1	Thrust washer kit		0,1MM O.S
	276793	1	Thrust washer kit		0,2MM O.S
	423288	1	Thrust washer		(276794) 0,3 MM OVER SIZE
26	423080	1	Crankshaft gear	02A-0700	
			Bulletin 45-01	45-01-EN	Timing Gears, 71, 100, 121
27	423177	1	Oil deflector		
28	469489	1	Hub		(422123)
29	422124	1	Washer		
30	941494	1	Screw		
31	469036	1	Vibration damper		TID120FG
	846645	1	Absorber		TID120F PP
32	468187	1	Pulley, 2-GROOVE		TID120FG
	847367	1	Pulley, 6-GROOVES		TID120F PP
33	955549	6	Screw		TID120FG L = 45 MM
	955551	12	Screw		TID120F PP L = 57 MM
34	941495	3	Lock washer		TID120FG
	941909	12	Spring washer		TID120F PP
35	814746	1	Flywheel		
36	423082	1	· Gear ring		
37	941570	10	Screw		
38	467773	10	Washer		
39	468271	X	Shim		TH = 0,20 MM
	468272	X	Shim		TH = 0,30 MM
	468273	X	Shim		TH = 0,50 MM