

TID70G

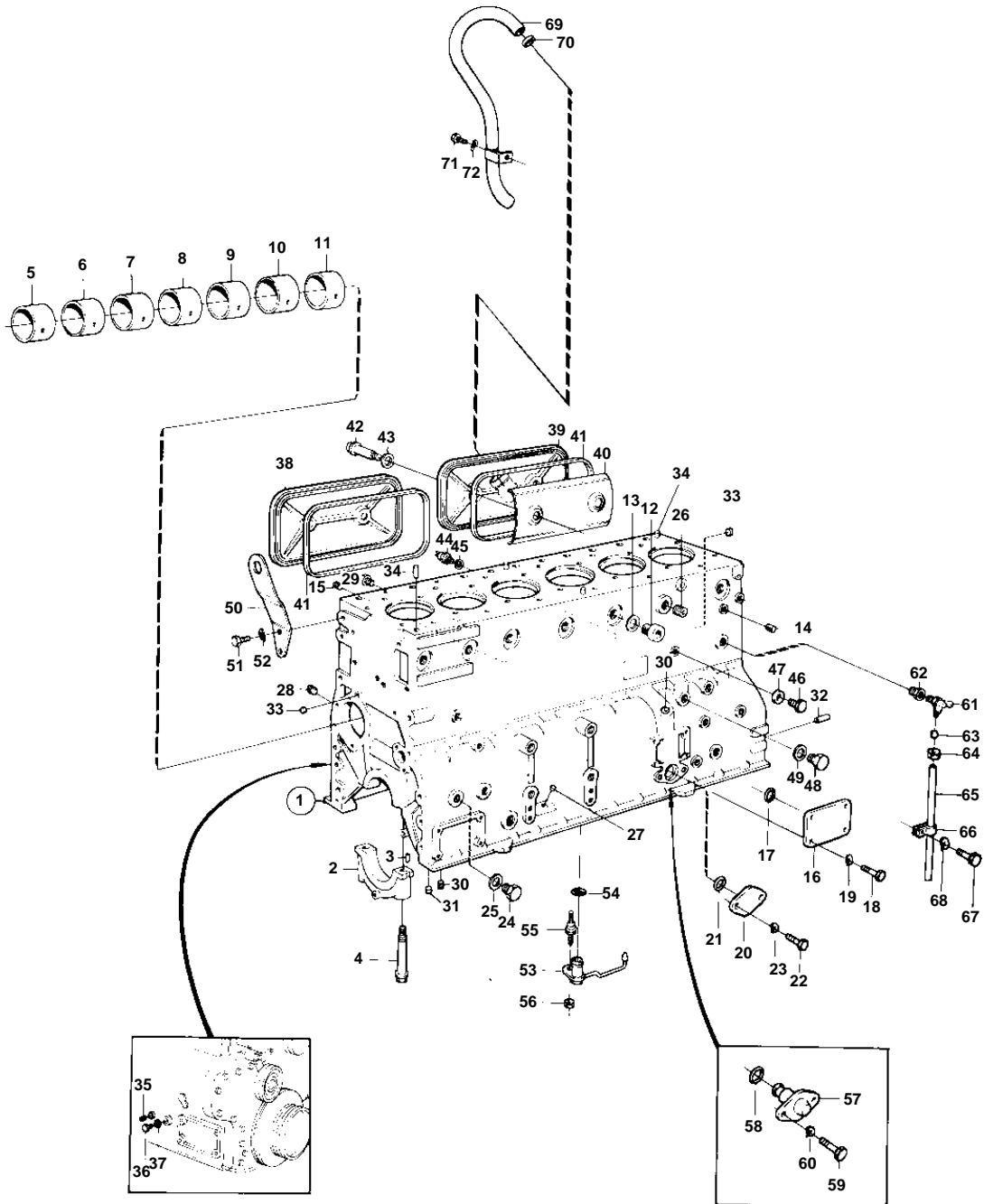

6553

TID70G

REF	PART NO.	QTY	DESCRIPTION	SEE SEC.	NOTES
1	466830	1	Cylinder block		SPARE PART DESIGN
2		7	· BEARING CAP	02A-1400	
3	422426	1	· Pin		
4	421153	14	· Screw		
5	422076	1	· Bushing	02A-1200	
6	422077	1	· Bushing		
7	422078	1	· Bushing		
8	422079	1	· Bushing		
9	422080	1	· Bushing		
10	422081	1	· Bushing		
11	422082	1	· Bushing		
12	467367	6	· Plug		
13	469328	6	· Gasket	IK	(468462)
14	952075	1	· Plug		
15	422369	7	· Plug		
16	837510	1	· Cover		
17	955994	2	· O-ring		
18	955534	4	· Screw		
19	942336	4	· Spring washer		
20	1542267	1	· Cover		
21	949659	1	· O-ring		(925065)
22	955512	2	· Screw		
23	941906	2	· Spring washer		
24	192114	3	· Plug		
25	18677	3	· Gasket		
26	952077	2	· Plug		
27	955082	2	· Cap plug		
28	952075	1	· Plug		
29	192154	1	· Plug		
30	952075	2	· Plug		
31	955079	1	· Cap plug		
32	191171	2	Pin		
33	955082	4	Cap plug		
34	949020	4	Pin		
35	952075	1	Plug		
36	941959	1	Plug		
37	18818	1	Gasket	IK	
38	420120	1	Inspection cover		
	420120	2	Inspection cover		FOR ENGINE,40%Z9 INCLANATION.
		X	CRANKCASE VENTILATION		SEE GROUP 9
39	420121	1	Inspection cover		
40	421120	1	Splash plate		
41	421121	2	Gasket	IK	
42	422541	4	Screw		
43	469846	4	Sealing ring	IK	(424342)
44	16318	2	Plug		
45	907132	2	Gasket	IK	
46	191025	1	Plug		
47	18671	1	Gasket	IK	
48	192114	1	Plug		
49	18677	1	Gasket	IK	
50		1	LIFT ARM		
51	955561	2	Screw		
52	940280	2	Spring washer		
53	466836	6	Nozzle		
54	466874	6	Sealing ring	IK	
55	466870	6	Stud		
56	945467	6	Nut		
57	466450	1	Valve		
58	949659	1	O-ring	IK	
59	955513	2	Screw		
60	941906	2	Spring washer		
61	820436	1	Drain cock		

TID70G

REF	PART NO.	QTY	DESCRIPTION	SEE SEC.	NOTES
62	190130	1	Nipple		
63	954365	1	Fitting		
64	954357	1	Cap nut		(954350)
65	821889	1	Tube		
66	942400	1	Clamp		
67	940133	1	Screw		
68	942336	1	Spring washer		
69	421155	1	Tube		
70	421158	1	Sealing ring		
71	955523	1	Screw		
72	941907	1	Spring washer		