

TD100G-87

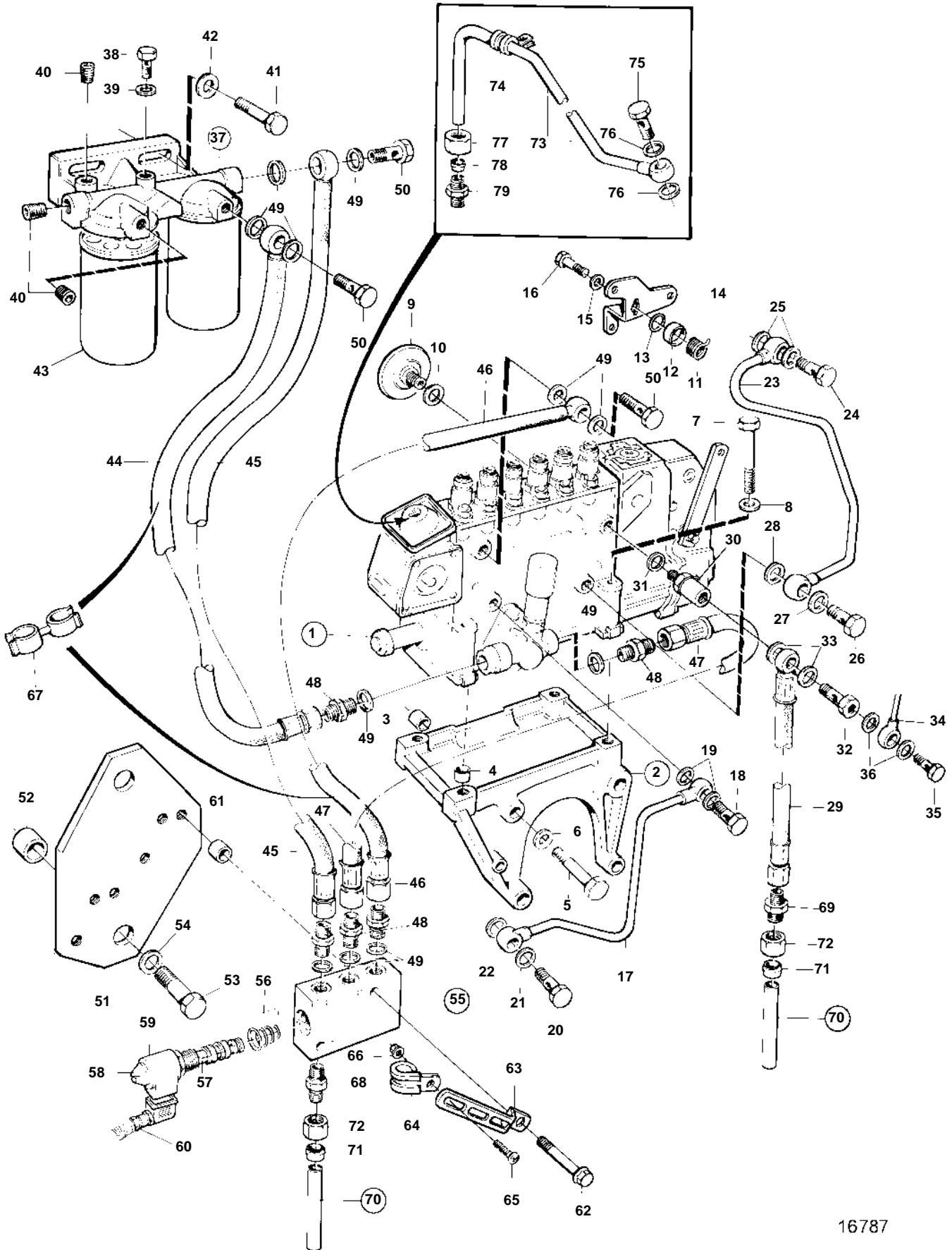

16787

TD100G-87

REF	PART NO.	QTY	DESCRIPTION	SEE SEC.	NOTES
1	862183	1	Injection pump		
				1895	
2	478647	1	Bracket		
3		2	· Guide sleeve		
4	417588	1	· Guide sleeve		
5	955566	4	Screw		
6	940280	4	Spring washer		
7	940156	4	Screw		
8	190509	4	Washer		
9	477173	1	Pressure equalizer		
10	969011	1	Gasket		
11	239056	1	Spring		
12		1	Cover		
13	120265	1	Washer		
14	848677	1	Lever		SEE GROUP 27
15	941906	1	Spring washer		
16	955637	1	Screw		
17	422245	1	Pressure oil line		
18	48634	1	Hollow screw		
19	947281	2	Gasket		
20	942081	1	Hollow screw		
21	18666	1	Gasket		
22	11994	1	Gasket		
23	422246	1	Pipe		
24	25167	1	Hollow screw		
25	969011	2	Gasket		
26	942007	1	Hollow screw		
27	11998	1	Gasket		
28	942703	1	Gasket		
29	3825603	1	Fuel hose		
30	3825154	1	Overflow valve		(35096)
31	15304	1	Gasket		
32	16496	1	Hollow screw		
33	969011	2	Gasket		
34	846637	1	Leak-off line		
35	74033	1	Hollow screw		
36	947620	2	Gasket		
37	1676832	1	Filter housing		
38	471177	1	Screw, air venting		
39	947620	1	Gasket		
40	968062	3	Plug		
41	940162	2	Screw		
42	960142	2	Washer		
43	3825133	2	Fuel filter		
44	3826143	1	Fuel hose		
45	3825602	1	Fuel hose		
46	3825603	1	Fuel hose		
47	3826142	1	Fuel hose		
48	941754	5	Nipple		
49	969011	11	Gasket		
50	25167	3	Hollow screw		
51	3826145	1	Bracket		
52	1678297	2	Spacer sleeve		
53	955570	2	Screw		
54	940280	2	Spring washer		
55	866699	1	Shut-off valve		
56	3825238	1	· Gasket kit		
57		1	· Valve		
58		1	· Nut		
59	3825240	1	· Magnet		
60	866927	1	Cable kit		
61	843075	2	Sleeve		
62	973924	2	Flange screw		

TD100G-87

REF	PART NO.	QTY	DESCRIPTION	SEE SEC.	NOTES
63	845999	1	Bracket		
64	952631	1	Clamp		
65	956094	1	Screw		
66	955781	1	Nut		
67	866663	2	Clamp		
68	977677	1	Nipple		
69	957055	1	Nipple		
70	3825770	2	Fuel pipe		
71	956969	2	· Ferrule		
72	956983	2	Nut		
73	1545853	1	Tube		
74	18368	1	Clamp		
75	969299	1	Hollow screw		
76	11994	2	Gasket		
77	954357	1	Cap nut		
78	954365	1	Fitting		
79	954386	1	Fitting, induction manifold		