

TD100G-87

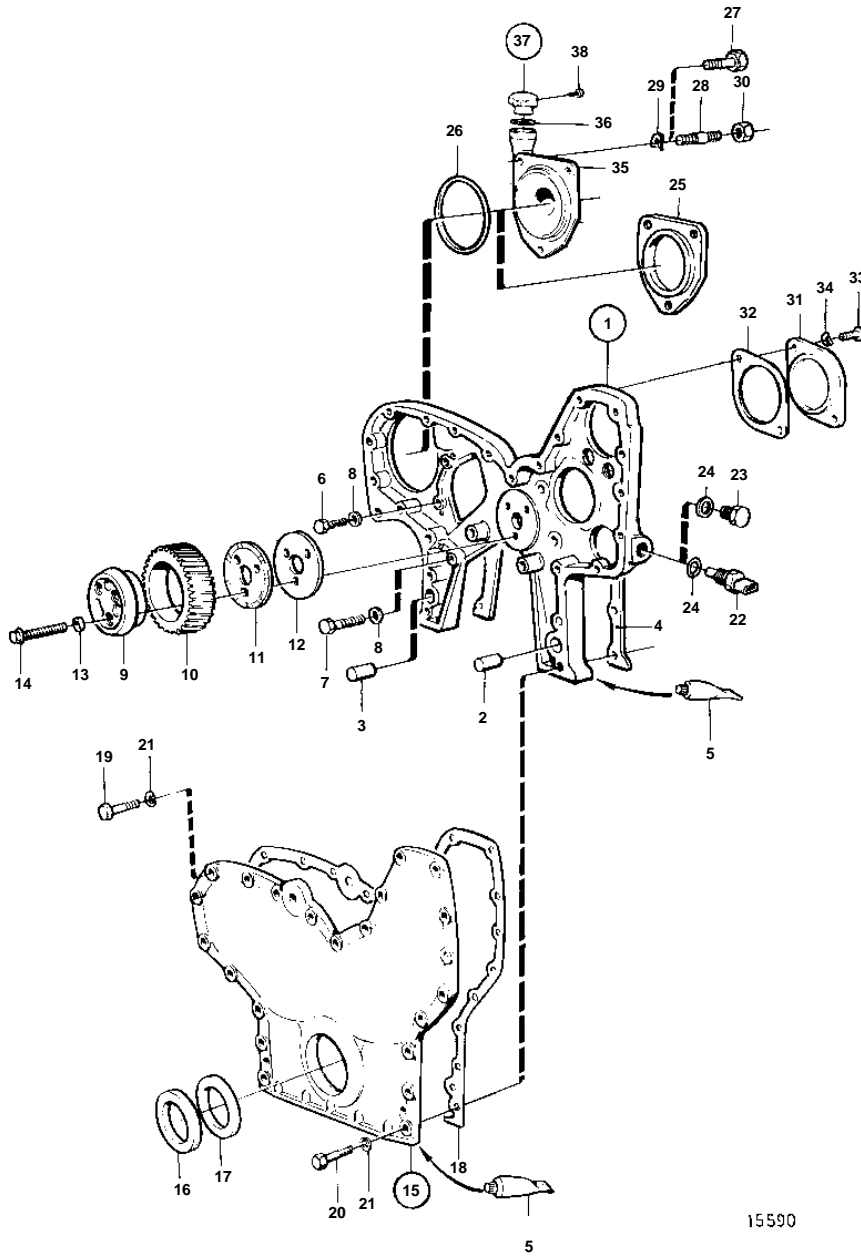

15590

TD100G-87

REF	PART NO.	QTY	DESCRIPTION	SEE SEC.	NOTES
1	422622	1	Timing gear casing		
2	941510	1	• Pin		
3	941511	1	• Pin		
4	468557	1	Gasket		EARLY TYPE
5	1161231	X	Sealant		304ml
	1161277	X	Sealant		10g
6	941939	4	Screw		L=29mm
7	955537	1	Screw		L=51mm
8	942336	5	Spring washer		
9	422766	1	Spindle		
10	467461	1	Drive		
			Bulletin 45-01	45-01-EN	Timing Gears, 71, 100, 121
11	467529	1	Thrust washer		
12	467528	1	Bearing shield		
13	942180	3	Washer		
14	468738	3	Screw		
15	864622	1	Cover		
16	941666	1	• Felt ring		
17	424983	1	• Sealing ring		
18	422626	1	Gasket		EARLY TYPE
19	940162	12	Screw		L=38mm
20	955541	8	Screw		L=76mm
21	942336	20	Spring washer		
22	3013297	1	Tachometer sensor		
23	943681	1	Plug		
24	925059	1	O-ring		
25	420178	1	Cover, air compr.		
26	975610	1	O-ring		
27	955576	3	Screw		EARLY TYPE
28	953346	3	Stud		
29	941911	3	Spring washer		
30	955828	3	Nut		
31	420183	1	Cover, hydraulic pump		
32	862591	1	Gasket		
33	940115	2	Screw		
34	942336	2	Spring washer		
35	849197	1	Tube, oil filling		
36	940096	1	Gasket		
37	421753	1	Oil filler cap		
38	955126	3	• Screw		