

TAD1240GE, TAD1241GE, TAD1242GE

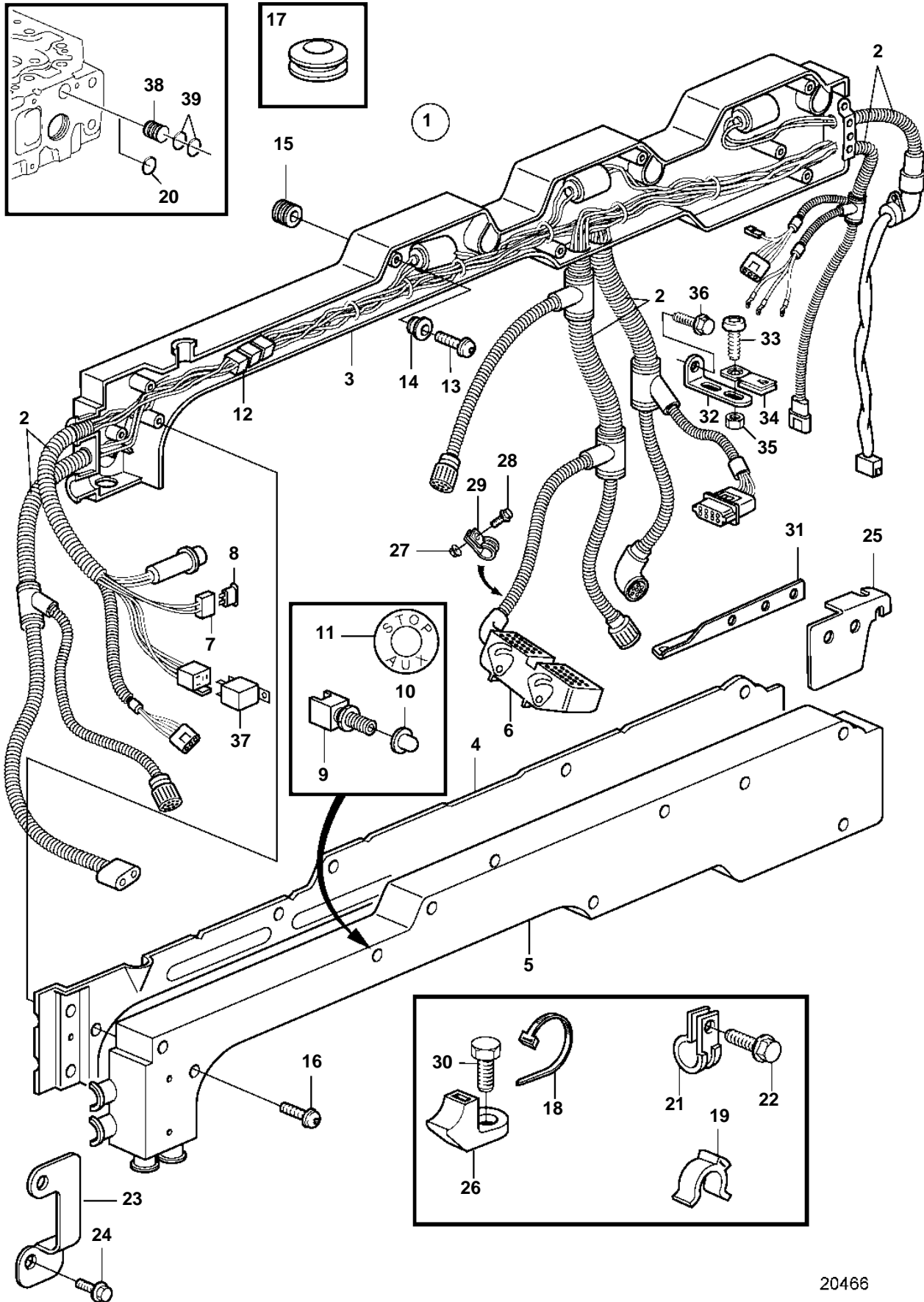

20466

TAD1240GE, TAD1241GE, TAD1242GE

REF	PART NO.	QTY	DESCRIPTION	SEE SEC.	NOTES
1	3809085	1	Cable harness		SN-302887
	3808736	1	Wiring harness		SN302888-
	3840094	1	Wiring harness		Used when Mitsubishi starter motor 3803923 is mounted.
2		1	· Cable harness		
3		1	· Box		
4		1	· Cover		
5	3827818	1	· Cover		
6		1	· Switch	4648	
7	874111	1	· Fuse holder		
8	969161	1	· Fuse		
9	873959	1	· Breaker		
10	828586	1	· Nut		
11	3809463	1	· Decal		(3581933)
12	20382270	1	· Diode		(1624394)
13	969598	6	· 6 point socket screw		(981370)
14	1079677	6	· Plug		
15	1079687	6	· Rubber cushion		
16	969408	7	· Screw		(956079)
17	941269	1	· Cable grommet		I.D=25mm
	943920	1	· Protecting plug		I.D=40mm
18	983472	X	Strip clamp		
	948211	X	Strip clamp		
19	28429850	5	Retainer		
20	949656	1	O-ring		In cable grommet for unit injectors on cylinder head.
21	952633	2	Clamp		
	949997	1	Clamp		I.D=31,8mm
	949746	8	Clamp		I.D=12,7mm
22	966807	6	Screw		M8x16mm
	946440	1	Flange screw		M8x16mm, In cable grommet for unit injectors on cylinder head.
23	3985509	1	Bracket		
24	946329	1	Flange screw		
25	3173718	1	Bracket		
26	1578046	2	Retainer		
27	948645	2	Lock nut		Mounted on bracket no. 3173718 and 20409007.
28	945444	2	Flange screw		Mounted on bracket no. 3173718 and 20409007.
29	949997	2	Clamp		Mounted on bracket no. 3173718 and 20409007.
30	949652	2	Screw		
31	20409005	1	Bracket		
32	965558	1	Bracket		
33	969405	1	6 point socket screw		
34	874295	1	Anchorage		
35	955780	1	Nut		
36	946440	1	Flange screw		
37	20374662	1	Relay		
38	20463179	1	Adapter		
39	949721	2	O-ring		