

TD30A

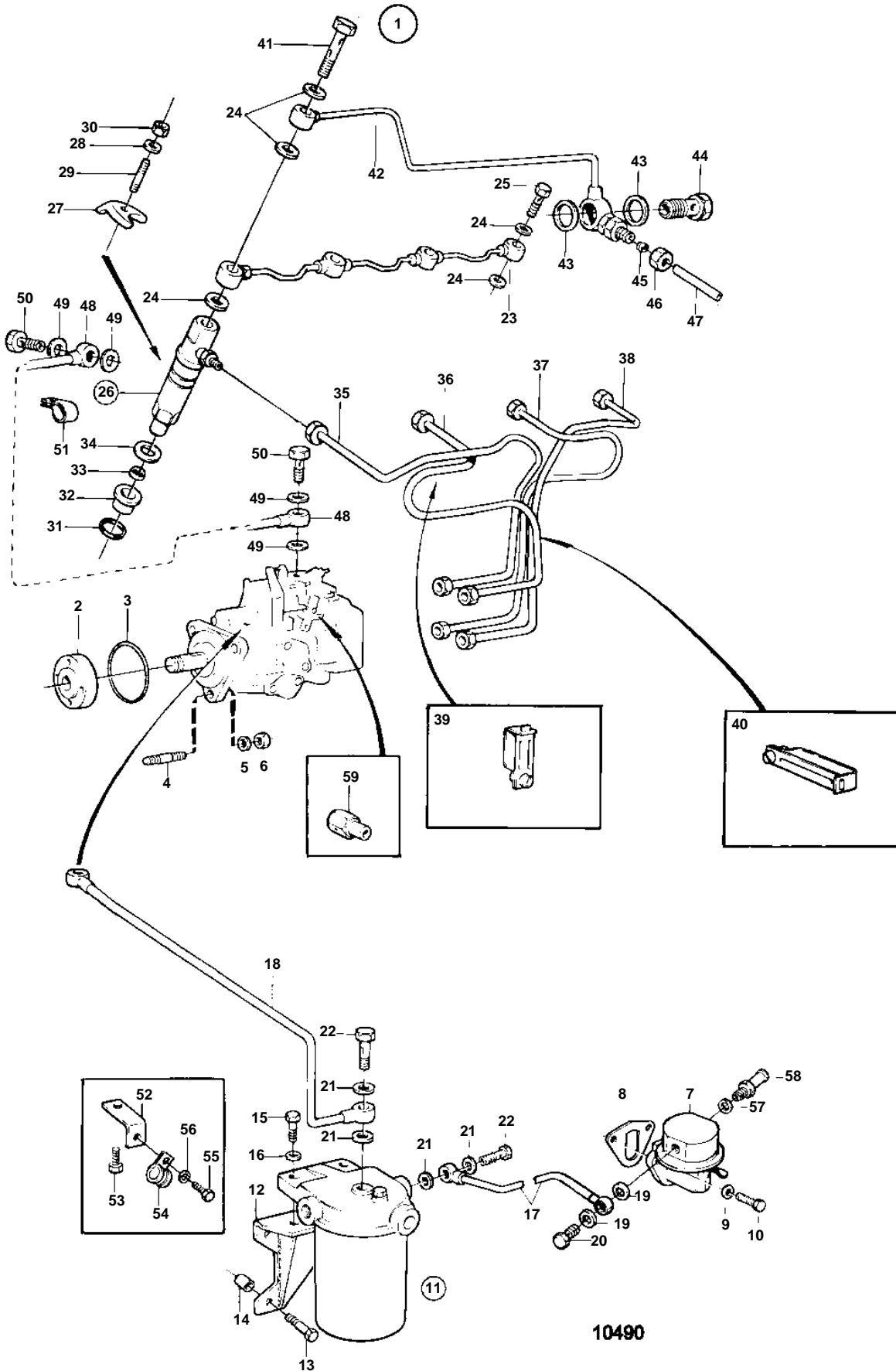

TD30A

REF	PART NO.	QTY	DESCRIPTION	SEE SEC.	NOTES
1	838957	1	Injection pump COMPONENTS		
2	1542171	1	Hub		
3	968971	1	O-ring	IK	(947314)
4	953046	3	Stud		
5	191172	3	Washer		
6	955782	3	Nut		
7	1542170	1	Fuel pump		REPLACED BY FUEL PUMP 860320 AND PIPE 860447
	273663	1	· Repair kit		
	860320	1	Feed pump		
8	3501530	1	Gasket	IK	(463392)
9	941907	2	Spring washer		
10	955295	2	Screw		
11	840531	1	Fuel filter		
				02C-0550	
12	838583	1	Bracket		
13	965193	2	Screw		(955344)
14	843295	2	Spacer sleeve		
15	955317	2	Screw		
16	960148	2	Washer		
17	838586	1	Tube		FOR 1542170
	860447	1	Fuel pipe		FOR 860320
18	838587	1	Tube		
19	11994	4	Gasket	IK	
20	969299	2	Hollow screw		(74040)
21	969011	4	Gasket	IK	(947621)
22	25167	2	Hollow screw		
23	1544137	1	Leak-off line		
24	957171	9	Gasket	IK	
25	74033	3	Hollow screw		
26	1542155	4	Injector		
	3803239	4	Injector, exch		Exchange unit
				02C-0450	
27	1542156	4	Yoke		
28	1542197	4	Washer		
29	924068	4	Stud		
30	955782	4	Nut		
31	1542157	4	Washer	IK	
32	1542154	4	Heat shield		
33	1542158	4	Washer	IK	
34	1542159	4	Washer	IK	
35	1544151	1	Delivery pipe		CYL NO 1
36	1544152	1	Delivery pipe		CYL NO 2
37	1544153	1	Delivery pipe		CYL NO 3
38	1544154	1	Delivery pipe		CYL NO 4
39	470181	2	Clamp		
40	470183	1	Clamp		
41	74034	1	Hollow screw		
42	1542301	1	Fuel pipe		
43	11994	2	Gasket		
44	844237	1	Hollow screw		INCLUDED IN FUEL INJECTION PUMP.
45	326599	1	Fitting		
46	326596	1	Nut		
47	858064	1	Tube		
48	858149	1	Tube		(838948)
49	957171	4	Gasket	IK	
50	74033	2	Hollow screw		
51	947191	1	Clamp		
52	846780	1	Bracket		
53	970943	1	Screw		(955314)
54	952624	1	Clamp		
55	955271	1	Screw		
56	955892	1	Washer		

