

D45B PP, TD45B

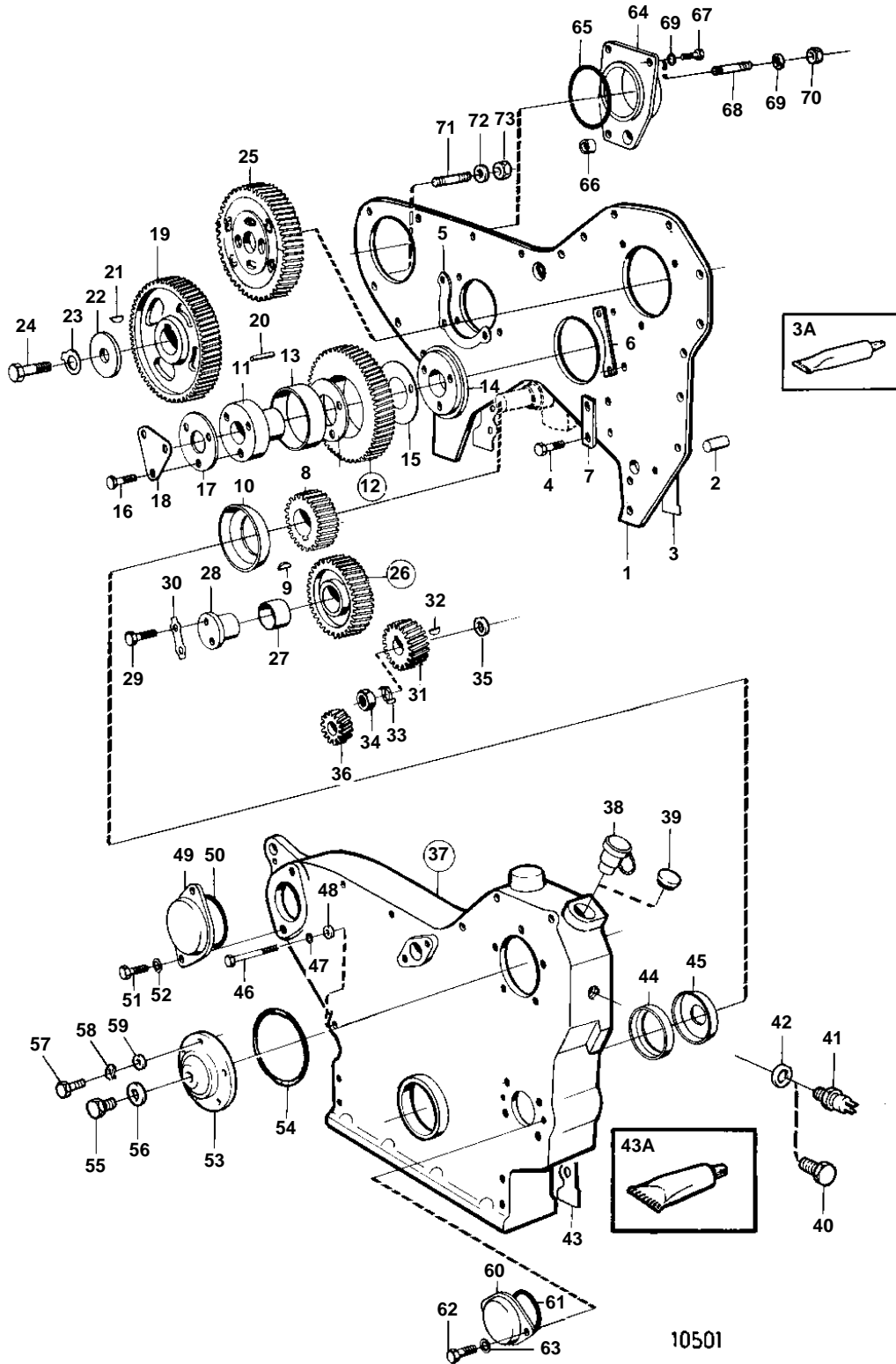

D45B PP, TD45B

REF	PART NO.	QTY	DESCRIPTION	SEE SEC.	NOTES
1	4804585	1	Plate		
2	191171	2	Pin		
3	785746	1	Gasket	IK	REPLACED BY SEALING AGENT-1161277.
3A	1161277	1	Sealant		
4	955524	7	Screw		
5	785796	1	Striker plate		
6	785797	1	Striker plate		
7	785872	1	Striker plate		
8	787299	1	Gear	02A-0150	
9	910127	1	Key	02A-0150	
10	785540	1	Ring	02A-0150	
11	785723	1	Pin		
12	785767	1	Idler gear		
13	785646	1	· Bushing		
14	785768	1	Spacer plate		
15	787294	2	Washer		
16	955556	3	Screw		
17	787377	1	Bearing shield		
18	785590	1	Lock washer		
19	785789	1	Gear	02A-0190	
20	907172	1	Pin		
21	910122	1	Key		
22	785584	1	Washer		
23	785589	1	Lock washer		
24	955581	1	Screw		
25	4804556	1	Gear		SEE GROUP 2C
26	787297	1	Idler gear	02A-0150	
27	785775	1	· Bushing		
28	785519	1	Pivot pin		
29	940161	2	Screw		
30	15024	1	Lock washer		
31	4804202	1	Drive gear		
32	910115	1	Key		
33	926147	1	Washer		
34	914450	1	Snap ring		
35	424133	1	Washer		
36	787298	1	Drive	02A-0150	
37	4804736	1	Timing gear cover		
38	785860	1	Oil filler cap		
40	960632	1	Plug		ALT
41	4780941	1	Tachometer sensor		
42	947624	1	Gasket		
43	787156	1	Gasket	IK	REPLACED BY SEALING AGENT-1161277.
43A	1161277	1	Sealant		
44	4804489	1	Sealing ring	IK	
45	785517	1	Ring		
46	955531	8	Screw		L=89 MM
	955530	2	Screw		L=83 MM
	940135	8	Screw		L=22 MM
47	941907	18	Spring washer		
48	960141	1	Washer		
49	420183	1	Cover		
50	420213	1	Seal	IK	
51	955535	2	Screw		
52	942336	2	Spring washer		
53	4804621	1	Cover		
54	785594	1	Gasket		
55	301185	1	Plug		
56	947627	1	Gasket		
57	940100	5	Screw		
58	941906	5	Spring washer		
59	955893	5	Washer		

TIMING GEAR COVER AND GEARS: D45BPP

02A

D45B PP, TD45B

REF	PART NO.	QTY	DESCRIPTION		SEE SEC.	NOTES
60	785859	1	Cover			
61	926132	1	O-ring		IK	
62	940133	2	Screw			
63	942336	2	Spring washer			
64	785960	1	Cover			
65	926043	1	O-ring		IK	
66	785618	1	Sealing ring		IK	
67	955535	3	Screw			
69	942336	3	Spring washer			