

MB10A

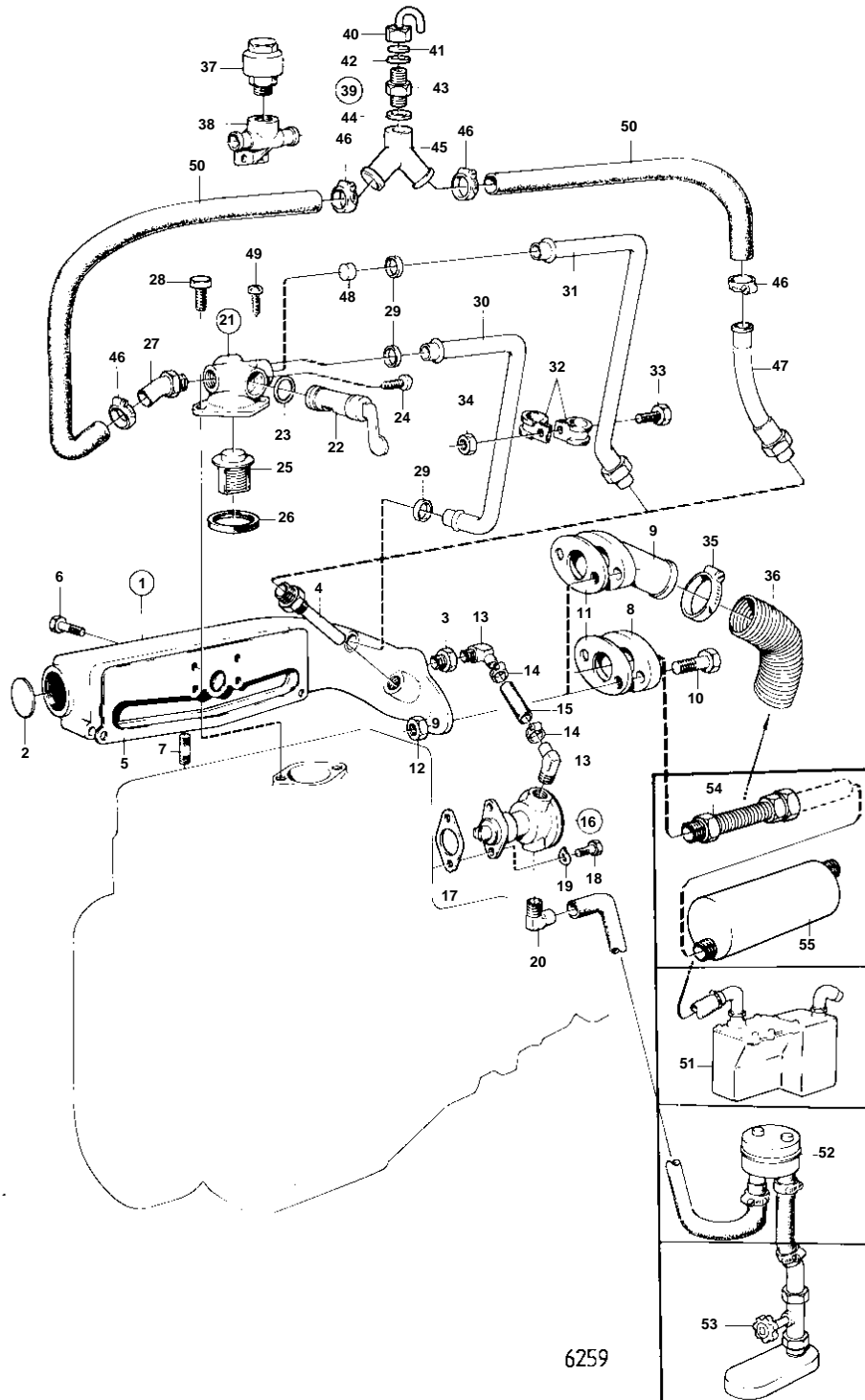

**MB10A**

REF	PART NO.	QTY	DESCRIPTION	SEE SEC.	NOTES
1		1	Exhaust pipe		
2	834207	1	· Expansion plug		
3		1	· Nipple		
4		1	· Tube		
5	834160	1	Gasket		
6	955539	4	Hexagon screw		
7	953235	2	Stud		SEE GROUP 2C
8	807050	1	Exhaust pipe flange		ALT
9	834292	1	Exhaust riser		ALT
10	955536	2	Hexagon screw		
11	803374	1	Gasket		
12	955827	2	Hexagon nut		
13		2	Anchorage		
14	943472	2	Hose clamp		
15	943416	X	Rubber hose		L = 150 MM
16	833415	1	Water pump		
				13565	
17	802551	1	Gasket		
18	955523	2	Hexagon screw		
19	941907	2	Spring washer		
20	945341	1	Hose attachment		
21		1	Thermostat housing		
22		1	· Tap		
23	925055	2	· O-ring		
24		2	· Slotted screw		
25	875796	1	Thermostat kit		60°C
26	416033	1	· Sealing ring		(418361)
27		1	Hose attachment		
28	955523	2	Hexagon screw		
29	829714	3	Sealing ring		
30		1	Coolant pipe		
31		1	Tube		
32	952627	2	Clamp		
33	950045	1	Cross recessed screw		
34	950352	1	Lock nut		
35	961672	2	Hose clamp		
36		X	Spring		
37		1	VACUUM VALVE		REPLACED BY 828263, 828262., EARLY TYPE
38		1	HOUSING		REPLACED BY 828263, 828262., EARLY TYPE
39	828534	1	Vacuum valve		(828263)
40		1	· UPPER UNIT		
41		2	· Diaphragm		
42	828424	2	· Gasket		
43		1	· LOWER PART		
44	947282	2	· Gasket		
45	828262	1	Hose connection		LATE TYPE
46	961666	1	Hose clamp		
47		1	Coolant pipe		
48		1	Plug		
49		1	Slotted screw		
50	13569	X	Hose		
51		1	MUFFLER, WET		SEE GROUP 9, EARLY TYPE
52	831733	1	Strainer		SEE GROUP 9
53	828242	1	Cooling water inlet		SEE GROUP 9
54		1	Compensator		
55	833840	1	Muffler		