

# CRANKCASE-5.0 LITER FL

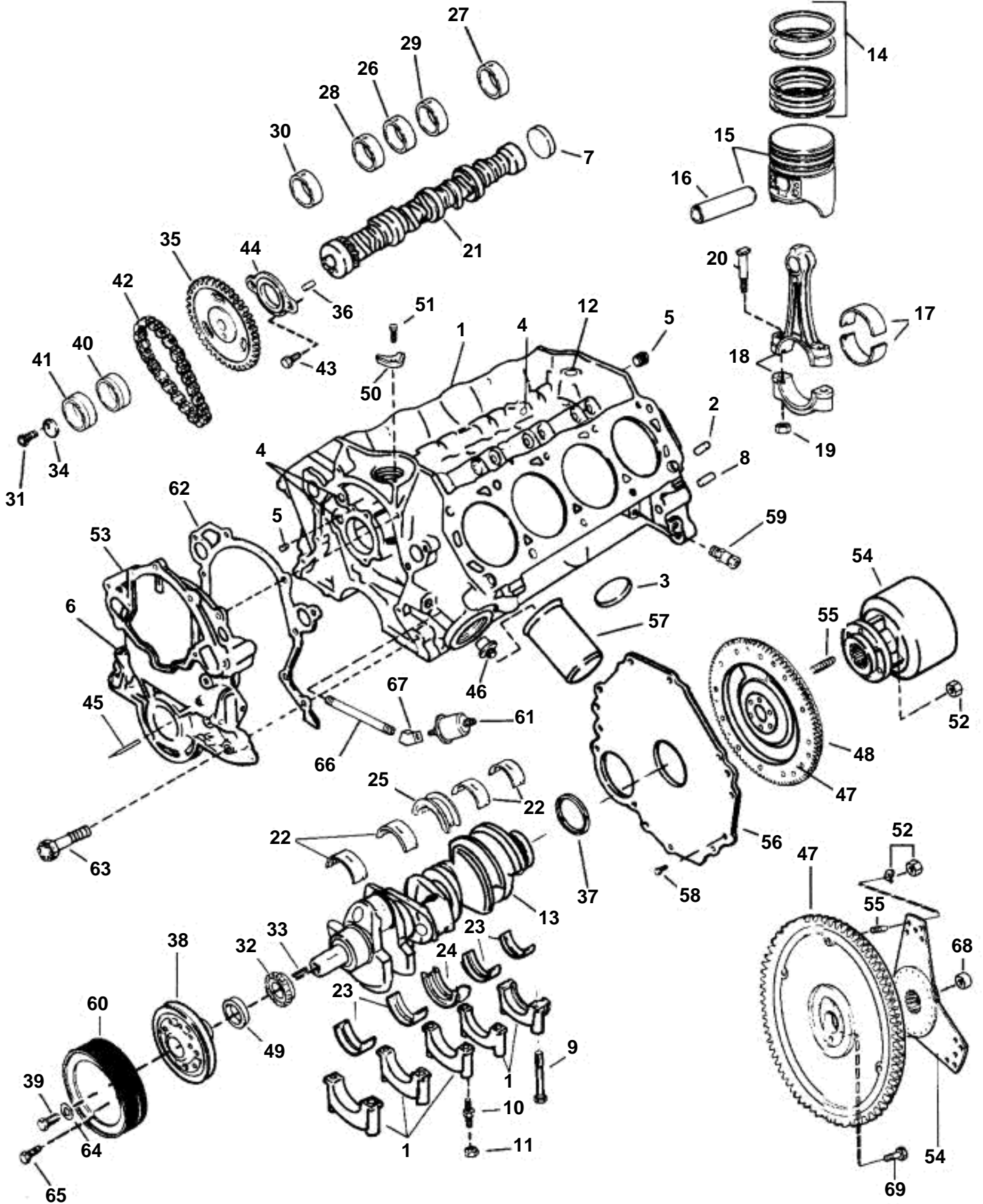

Upd: 21 MAR 2006

GR999900

7797017 - - 0-0001

**VOLVO  
PENTA**

HU 5.0 FL, 5.8 FL; 5.0 Fi, 5.8 Fi; 5.8 Fsi

# CRANKCASE-5.0 LITER FL

REF	PART NO.	QTY	DESCRIPTION	SEE SEC.	NOTES
1	3855164	1	Longblock		
			Bulletin P-21-0-7	P-21-0-7-EN	Longblock guidelines, 5.0L, 5.8L, Ford
2	3853007	4	Guide sleeve, Cylinder head		
3	3852650	6	Cap plug, Core hole		
4	3853008	2	Cap plug, Oil passage		
5	3853108	6	Plug, Oil gallery		
6	3853008	2	Cap plug, Oil level hole		
7	3852766	1	Cap plug, Rear, cam, standard		
	3853009	X	Cap plug, Rear, cam, 0.60 in. OS		
8	3853076	1	Locating pin, Adapter to block		
9	3853065	9	Screw, Main cap		
10	3853066	1	Stud, Main cap		
11	3853026	1	Nut, Main cap		
12	3853010	1	Cap plug, Oil gallery		
13	3852792	1	Crankshaft		
14	3853900	4	Piston ring kit, Standard		Contains Rings for 2 Pistons
	3853844	X	Piston ring kit, 0.020 in. OS		Contains Rings for 2 Pistons
	3853879	X	Piston ring kit, 0.030 in. OS		Contains Rings for 2 Pistons
	3853885	X	Piston ring kit, 0.040 in. OS		Contains Rings for 2 Pistons
15	3853896	8	Piston, Standard, blue		
	3853876	X	Piston, 0.020 in. OS		
	3853877	X	Piston, 0.030 in. OS		
	3853878	X	Piston, 0.040 in. OS		
16	3852773	8	· Piston pin, Piston, standard		
17	3852775	16	Rod bearing, Rod, standard		
	3853041	X	Rod bearing, Rod, 0.010 in. US		
	3853042	X	Rod bearing, Rod, 0.020 in. US		
	3853043	X	Rod bearing, Rod, 0.030 in. US		
	3853044	X	Rod bearing, Rod, 0.040 in. US		
18	3853901	8	Connecting rod		
19	3852777	16	· Nut, Connecting rod		
20	3852776	16	· Screw, Connecting rod		
21	3852778	1	Camshaft		
22	3852797	8	Main bearing, Main, upper, standard		
			Bulletin P-21-6-1	P-21-6-1-EN	Main Bearing Kits, 5.0 and 5.8L Ford
22	3853047	X	Main bearing, Main, upper, 0.010 in. US		
	3853048	X	Main bearing, Main, upper, 0.020 in. US		
	3853049	X	Main bearing, Main, upper, 0.030 in. US		
23	3852798	8	Main bearing, Main, lower, standard		
			Bulletin P-21-6-1	P-21-6-1-EN	Main Bearing Kits, 5.0 and 5.8L Ford
23	3853052	X	Main bearing, Main, lower, 0.010 in. US		
	3853053	X	Main bearing, Main, lower, 0.020 in. US		
	3853054	X	Main bearing, Main, lower, 0.030 in. US		
24	3852800	2	Thrust bearing, Main, center, lower, std		
			Bulletin P-21-6-1	P-21-6-1-EN	Main Bearing Kits, 5.0 and 5.8L Ford
24	3853062	X	Thrust bearing, Main, ctr, lower, 0.010 in. US		
	3853063	X	Thrust bearing, Main, ctr, lower, 0.020 in. US		
	3853064	X	Thrust bearing, Main, ctr, lower, 0.030 in. US		
25	3852799	2	Thrust bearing, Main, center, upper, std		
			Bulletin P-21-6-1	P-21-6-1-EN	Main Bearing Kits, 5.0 and 5.8L Ford
25	3853057	X	Thrust bearing, Main, ctr, uppe^, 0.010 in. US		
	3853058	X	Thrust bearing, Main, ctr, uppe^, 0.020 in. US		
	3853059	X	Thrust bearing, Main, ctr, uppe^, 0.030 in. US		
26	3852781	1	Camshaft bearing, Center, standard		
	3853019	X	Camshaft bearing, Center, 0.015 in. US		
27	3852782	1	Camshaft bearing, Rear, standard		
	3853020	X	Camshaft bearing, Rear, 0.015 in. US		
28	3852783	1	Camshaft bearing, Front intermediate, std		
	3853022	X	Camshaft bearing, Front intermed. , 0.015 in US		
29	3852784	1	Camshaft bearing, Rear intermediate, std		
	3853023	X	Camshaft bearing, Rear intermed., 0.015 in. US		
30	3852780	1	Camshaft bearing, Front, standard		
	3853018	X	Camshaft bearing, Front, 0.015 in. US		
31	3852791	1	Screw, Eccentric		

7797017 - - 0-0001

GR999900

Upd: 21 MAR 2006

HU 5.0 FL, 5.8 FL; 5.0 Fi, 5.8 Fi; 5.8 Fsi

**VOLVO**  
**PENTA**

