

AQ225D

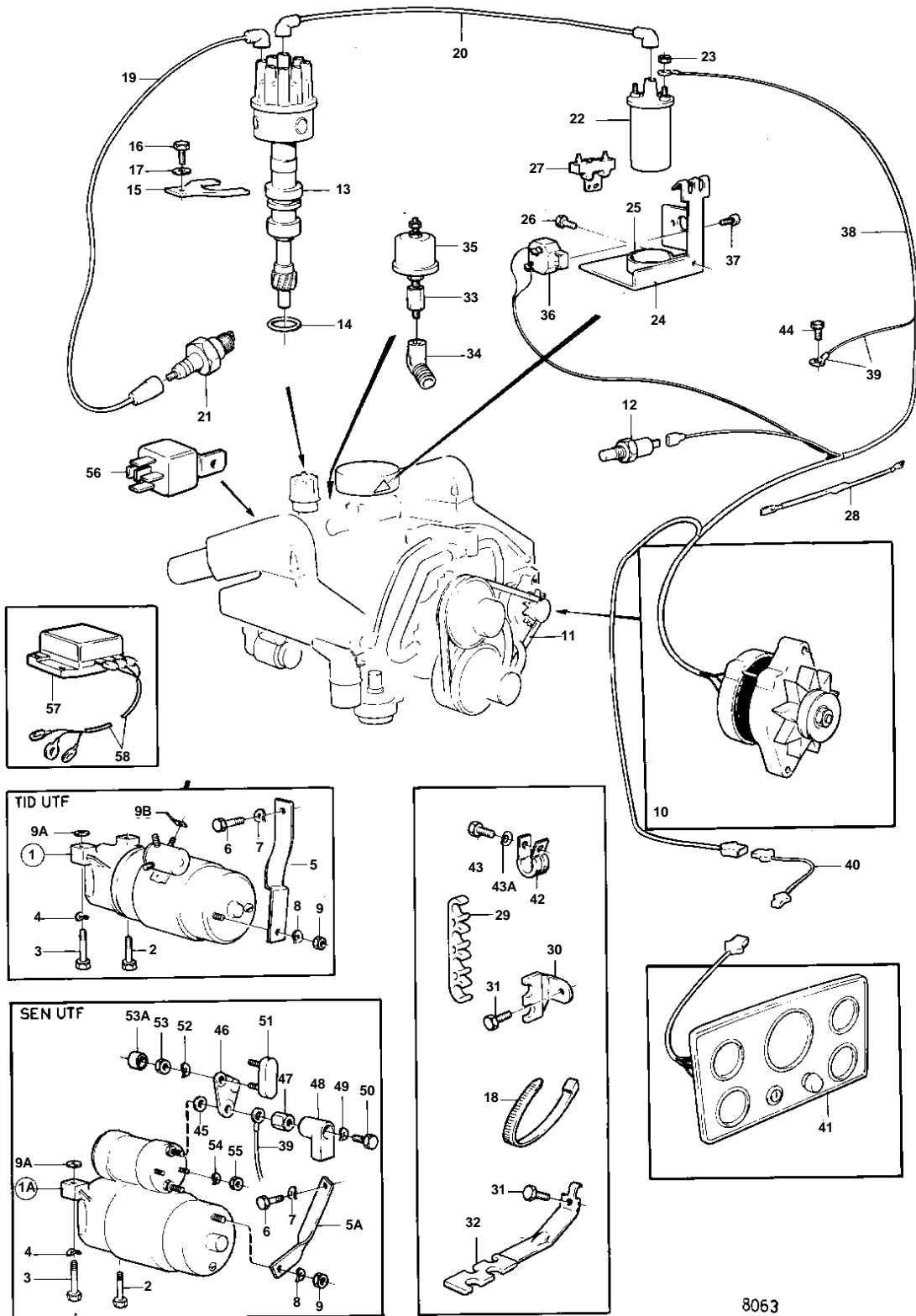

8063

AQ225D

| REF | PART NO. | QTY | DESCRIPTION | SEE SEC. | NOTES |
|-----|----------|-----|--|----------|--|
| 1 | 834893 | 1 | Starter motor | | EARLY TYPE |
| | | | | 17246 | |
| 1A | 855326 | 1 | Starter motor | | LATE TYPE |
| 1 | | | | 17247 | |
| 2 | 835424 | 1 | Screw | | |
| 3 | 835425 | 1 | Screw | | |
| 4 | 942336 | 2 | Spring washer | | |
| 5 | | 1 | Bracket | | EARLY TYPE |
| 5A | 855315 | 1 | Anchorage | | LATE TYPE |
| 6 | 940113 | 1 | Hexagon screw | | |
| 7 | 941907 | 1 | Spring washer | | |
| 8 | 941906 | 1 | Spring washer | | |
| 9 | 955825 | 1 | Hexagon nut | | |
| 9A | 841194 | X | Adjusting washer | | |
| 9B | 944485 | X | Cable terminal, FLAT PIN | | EARLY TYPE |
| 9 | | | | 17252 | |
| 10 | | 1 | ALTERNATOR AND INSTALLATION COMPONENTS | 17238 | |
| 11 | 958498 | 1 | V-belt | | SEE GROUP 2B |
| 12 | 835630 | 1 | Temperature sensor | | SEE GROUP 2B |
| | 835649 | 1 | Sensor | | FOR FLY BRIDGE. |
| 13 | 834855 | 1 | Distributor | | MO-20459, REPL BY 841069 |
| | | | | 17243 | |
| | 841069 | 1 | Distributor | | MO20460- |
| | | | | 17243 | |
| 14 | 835154 | 1 | Gasket | | |
| 15 | 841530 | 1 | Retainer | | (835426) |
| 16 | 955535 | 1 | Hexagon screw | | |
| 17 | 941744 | 1 | Washer | | |
| 18 | 948210 | X | Cable tie | | |
| 19 | 841228 | 2 | Ignition cable | | CYL 1,2 |
| | 841227 | 2 | Ignition cable | | CYL 3,4 |
| | 841226 | 2 | Ignition cable | | CYL 5,6 |
| | 841225 | 2 | Ignition cable | | CYL 7,8 |
| 20 | 855674 | 1 | Ignition cable | | |
| 21 | 876047 | 2 | Spark plug kit | | |
| 22 | 835998 | 1 | Ignition coil | | |
| 23 | | 2 | Nut | | |
| 24 | 834700 | 1 | Bracket | | SEE GROUP 2D |
| 25 | 1219561 | 1 | Clamp | | |
| 26 | | 1 | Screw | | |
| 27 | 835999 | 1 | Series resistance | | |
| 28 | 834784 | 1 | Resistor | | |
| 29 | | 2 | Retainer | | |
| 30 | | 2 | Retainer | | |
| 31 | 841426 | 3 | Screw | | |
| 32 | 835427 | 2 | Retainer | | |
| 33 | 835980 | 1 | Nipple | | |
| 34 | 809109 | 1 | Elbow nipple | | |
| 35 | 834920 | 1 | Oil pressure sensor | | |
| | 834921 | 1 | Oil pressure sensor | | FOR FLY BRIDGE., (835651) |
| 36 | 841178 | 1 | Automatic fuse | | 40A |
| 37 | 950013 | 2 | Cross recessed screw | | |
| 38 | 841822 | 1 | Cable trunk | | EARLY TYPE |
| | | 1 | Cable trunk | | LATE TYPE |
| 39 | | X | CABLE AND TERMINALS | 17252 | |
| 40 | | X | Cable trunk | | FOR INSTRUMENT PANEL 841094 AND 841095., L = 3000 MM |
| | 835670 | X | Cable trunk | | FOR INSTRUMENT PANEL 841096 AND 841097., L = 6000mm |
| 41 | | 1 | Instrument panel | | |
| | | | | 17248 | |

AQ225D

| REF | PART NO. | QTY | DESCRIPTION | SEE SEC. | NOTES |
|-----|----------|-----|----------------------|----------|---|
| 41 | | 1 | Panel | | EUR |
| | | | | 17249 | |
| 42 | 952630 | 1 | Clamp | | AQ200D MO-9199. AQ225D MO-9763. AQ260A MO-9639. AQ290A MO-9574. |
| | 942810 | 1 | Clamp | | LATE TYPE |
| 43 | 955513 | 1 | Hexagon screw | | AQ200D MO-9199. AQ225D MO-9763. AQ260A MO-9639. AQ290A MO-9574. |
| | 955534 | 1 | Hexagon screw | | LATE TYPE |
| 43A | 942336 | 1 | Spring washer | | LATE TYPE |
| 44 | 841426 | 1 | Screw | | |
| 45 | 1585449 | 1 | Gasket | | FOR ENGINE WITH DRIVE UNIT 290. |
| 46 | 852986 | 1 | Current bar | | FOR ENGINE WITH DRIVE UNIT 290. |
| 47 | 855330 | 1 | Nut | | LATE TYPE |
| 48 | 855798 | 1 | Protecting sleeve | | LATE TYPE |
| 49 | 940109 | 1 | Toothed washer | | LATE TYPE |
| 50 | 955314 | 1 | Hexagon screw | | LATE TYPE |
| 51 | 853502 | 1 | Fuse | | FOR ENGINE WITH DRIVE UNIT 290. |
| 52 | 941906 | 1 | Spring washer | | FOR ENGINE WITH DRIVE UNIT 290. |
| 53 | 955781 | 1 | Hexagon nut | | FOR ENGINE WITH DRIVE UNIT 290. |
| 53A | 853572 | 1 | Protective cap | | |
| 54 | 941905 | 2 | Spring washer | | LATE TYPE |
| 55 | 955780 | 2 | Hexagon nut | | LATE TYPE |
| 56 | 841177 | 1 | Relay | | LATE TYPE |
| 57 | | 1 | Race gard | | |
| 58 | | 1 | Cables and terminals | | |