

AQ200D

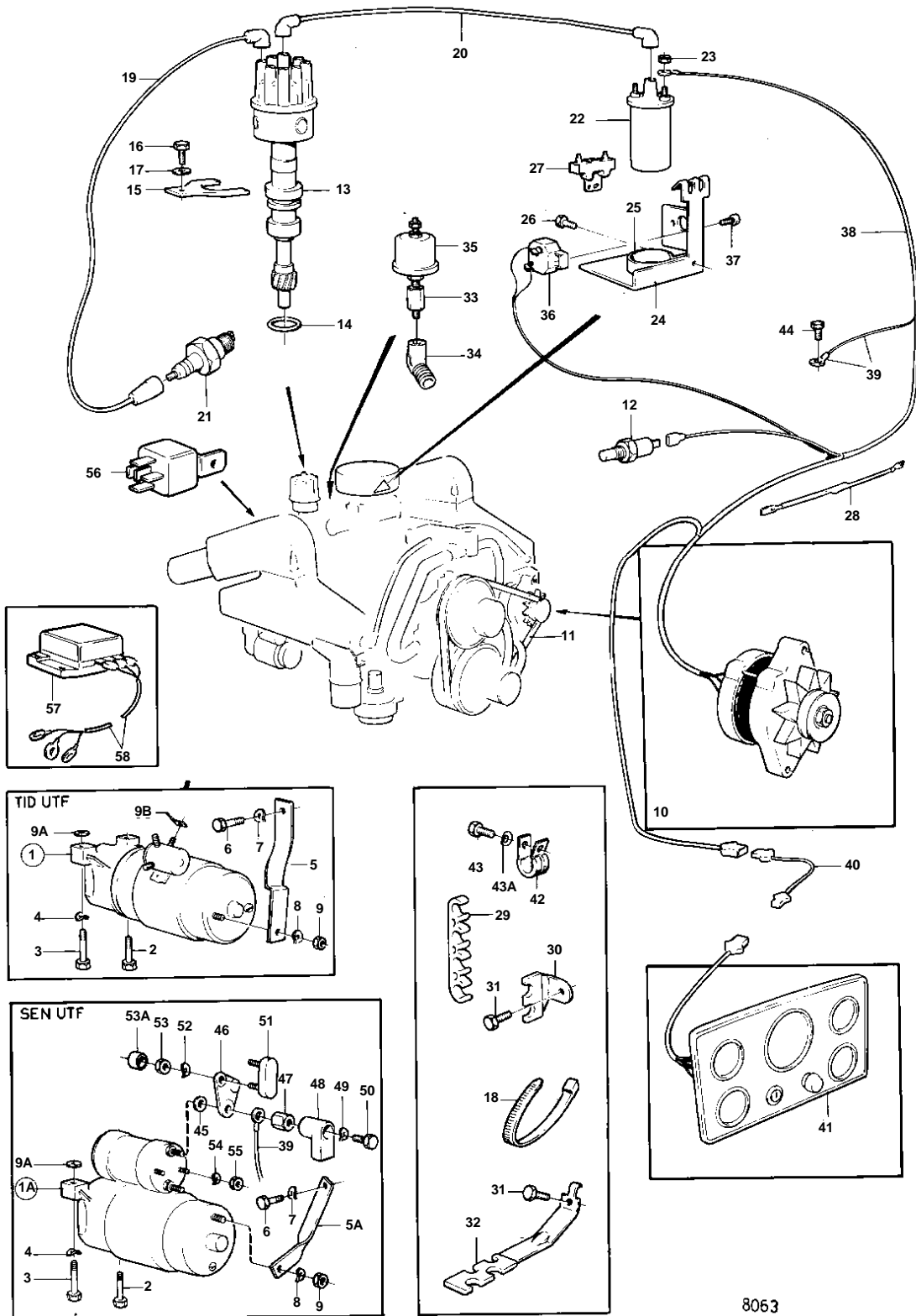

8063

AQ200D

REF	PART NO.	QTY	DESCRIPTION	SEE SEC.	NOTES
1	834893	1	Starter motor		EARLY TYPE
				17082	
1A	855326	1	Starter motor		LATE TYPE
1				17083	
2	835424	1	Screw		
3	835425	1	Screw		
4	942336	2	Spring washer		
5		1	Bracket		EARLY TYPE
5A	855315	1	Anchorage		LATE TYPE
6	940113	1	Hexagon screw		
7	941907	1	Spring washer		
8	941906	1	Spring washer		
9	955825	1	Hexagon nut		
9A	841194	X	Adjusting washer		
9B	944485	X	Cable terminal, FLAT PIN		EARLY TYPE
9				17088	
10		1	ALTERNATOR AND INSTALLATION COMPONENTS	17077	
11	958498	1	V-belt		SEE GROUP 2B
12	835630	1	Temperature sensor		SEE GROUP 2B
	835649	1	Sensor		FOR FLY BRIDGE.
13	834855	1	Distributor		MO-20459, REPL BY 841069
				17079	
	841069	1	Distributor		MO20460-
				17079	
14	835154	1	Gasket		
15	841530	1	Retainer		(835426)
16	955535	1	Hexagon screw		
17	941744	1	Washer		
18	948210	X	Cable tie		
19	841228	2	Ignition cable		CYL 1,2
	841227	2	Ignition cable		CYL 3,4
	841226	2	Ignition cable		CYL 5,6
	841225	2	Ignition cable		CYL 7,8
20	855674	1	Ignition cable		
21	876047	2	Spark plug kit		
22	835998	1	Ignition coil		
23		2	Nut		
24	834703	1	Bracket		SEE GROUP 2D
25	1219561	1	Clamp		
26		1	Screw		
27	835999	1	Series resistance		
28	834784	1	Resistor		
29		2	Retainer		
30		2	Retainer		
31	841426	3	Screw		
32	835427	2	Retainer		
33	835980	1	Nipple		
34	809109	1	Elbow nipple		
35	834920	1	Oil pressure sensor		
	834921	1	Oil pressure sensor		FOR FLY BRIDGE., (835651)
36	841178	1	Automatic fuse		40A
37	950013	2	Cross recessed screw		
38	841822	1	Cable trunk		EARLY TYPE
		1	Cable trunk		LATE TYPE
39		X	CABLE AND TERMINALS	17088	
40		X	Cable trunk		FOR INSTRUMENT PANEL 841094 AND 841095., L = 3000 MM
	835670	X	Cable trunk		FOR INSTRUMENT PANEL 841096 AND 841097., L = 6000mm
41		1	Instrument panel		
				17084	

AQ200D

REF	PART NO.	QTY	DESCRIPTION	SEE SEC.	NOTES
41		1	Panel		EUR
				17085	
42	952630	1	Clamp		AQ200D MO-9199. AQ225D MO-9763. AQ260A MO-9639. AQ290A MO-9574.
	942810	1	Clamp		LATE TYPE
43	955513	1	Hexagon screw		AQ200D MO-9199. AQ225D MO-9763. AQ260A MO-9639. AQ290A MO-9574.
	955534	1	Hexagon screw		LATE TYPE
43A	942336	1	Spring washer		LATE TYPE
44	841426	1	Screw		
45	1585449	1	Gasket		FOR ENGINE WITH DRIVE UNIT 290.
46	852986	1	Current bar		FOR ENGINE WITH DRIVE UNIT 290.
47	855330	1	Nut		LATE TYPE
48	855798	1	Protecting sleeve		LATE TYPE
49	940109	1	Toothed washer		LATE TYPE
50	955314	1	Hexagon screw		LATE TYPE
51	853502	1	Fuse		FOR ENGINE WITH DRIVE UNIT 290.
52	941906	1	Spring washer		FOR ENGINE WITH DRIVE UNIT 290.
53	955781	1	Hexagon nut		FOR ENGINE WITH DRIVE UNIT 290.
53A	853572	1	Protective cap		
54	941905	2	Spring washer		LATE TYPE
55	955780	2	Hexagon nut		LATE TYPE
56	841177	1	Relay		LATE TYPE
57			CABLE UNIT		EXCL AQ200D
58			SPEED LIMITER		EXCL AQ200D