

AQ165A, BB165A

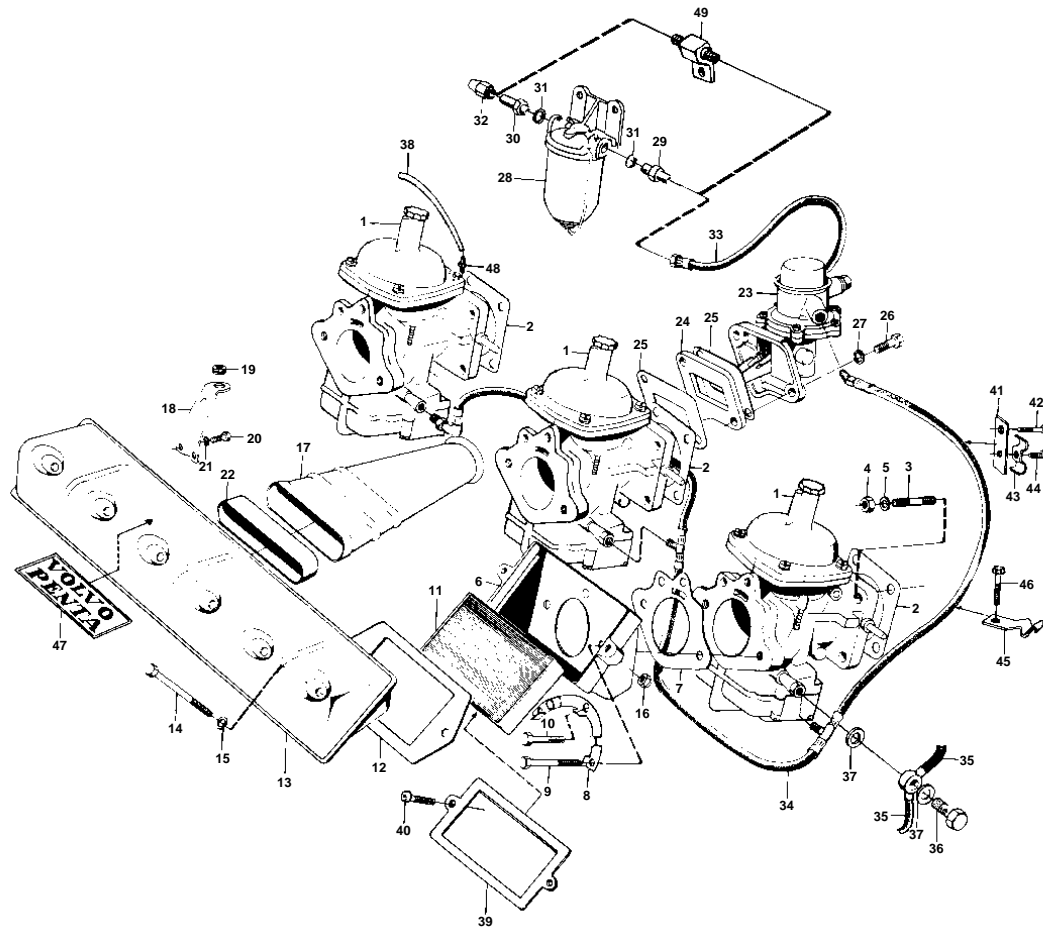

3362

AQ165A,BB165A

REF	PART NO.	QTY	DESCRIPTION	SEE SEC.	NOTES
1	875398	3	Carburetor		
				02C-0850	
2	418754	3	Gasket	IK	
3	953465	12	Stud		
4	950353	12	Lock nut		
5	941907	12	Spring washer		
6	825971	3	Drip collector		
7	680642	3	Gasket	IK	
8	825750	3	Splash plate		
9	955524	6	Screw		
10	955523	3	Screw		
11	825559	3	Insert		
12	831129	3	Gasket	IK	EXCL SPEC 9968
13	831128	1	Muffler		EXCL SPEC 9968
14	955517	6	Screw		EXCL SPEC 9968
15	941906	6	Spring washer		EXCL SPEC 9968
16	950362	6	Nut		
17	824587	2	Air inlet		EXCL SPEC 9968
18	831130	2	Bracket		EXCL SPEC 9968
19	43138	2	Rubber bushing		EXCL SPEC 9968
20	955512	4	Screw		EXCL SPEC 9968
21	941906	4	Spring washer		EXCL SPEC 9968
22	824588	2	Rubber gaiter		EXCL SPEC 9968
23	831092	1	Fuel pump		
				02C-0700	
24	460678	1	Spacer		
25	61830	2	Gasket	IK	
26	190524	2	Screw		
27	941907	2	Spring washer		
28	827200	1	Fuel filter		
				02C-1150	
29	192096	1	Nipple		
30	191397	1	Nipple		
31	957176	2	Gasket		
32	954322	1	Cap nut		
33	813007	1	Hose		
34	831028	1	Hose		EARLY TYPE
35	831188	1	Hose		LATE TYPE
36	943500	3	Screw		LATE TYPE
37	957171	6	Gasket		LATE TYPE
38	192055	X	Rubber hose		SEE GROUP 3
39	825556	3	Bracket		SPEC 9968
40	950046	6	Screw		SPEC 9968
41	831172	1	Bracket		
42	940133	1	Screw		
43	190853	1	Clamp		
44	950019	1	Screw		
45	419534	1	Clamp		
46	940136	1	Screw		SEE GROUP 2B
47	831988	1	Decal		
48	943513	X	Nipple		ACCESSORY.
49	831860	1	Nipple		ALT