

AQ170A,AQ170B

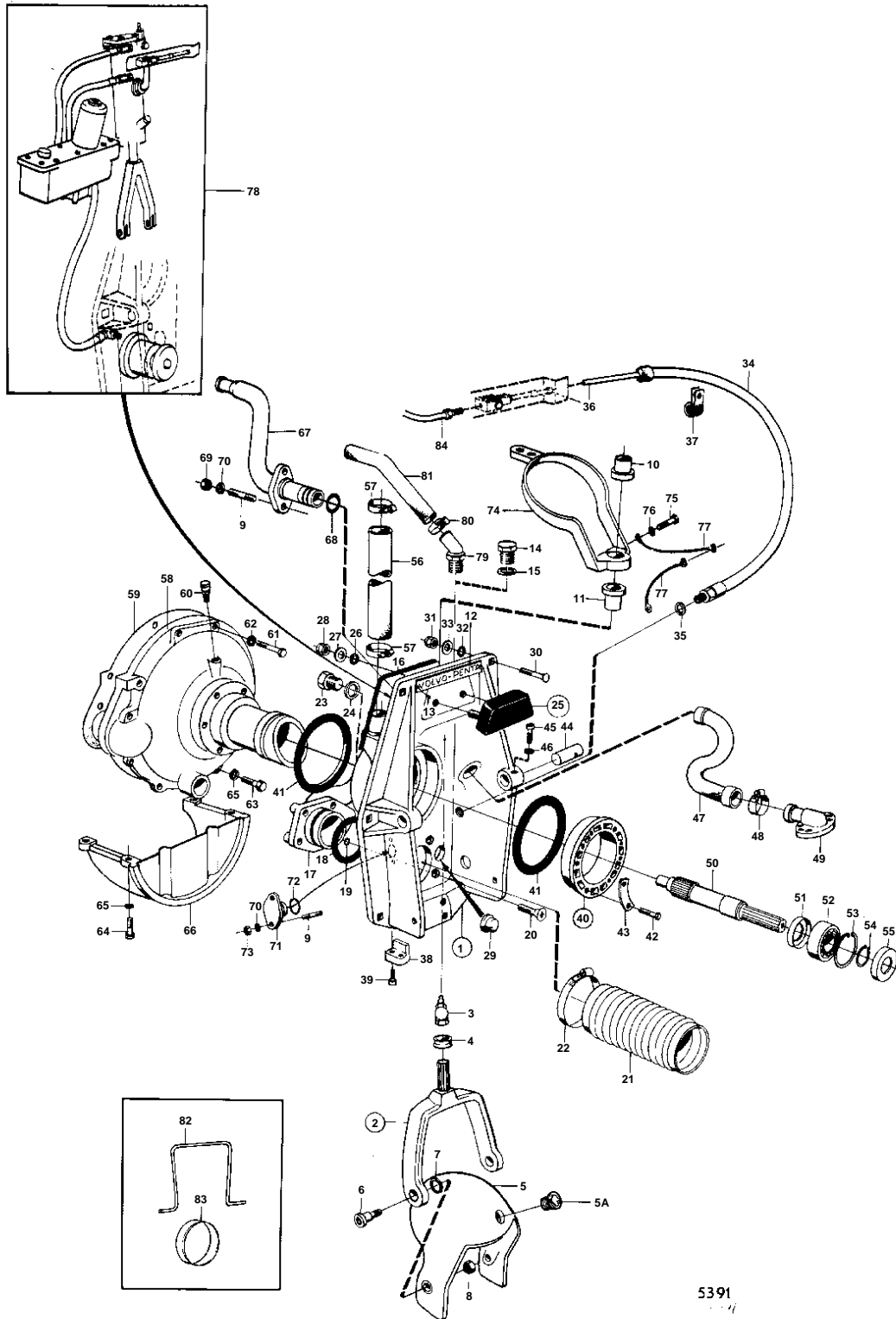

AQ170A,AQ170B

REF	PART NO.	QTY	DESCRIPTION	SEE SEC.	NOTES
1	875442	1	Transom shield		
2	832839	1	• Steering yoke		
3	914169	1	• • Lubricating nipple		
4	839195	1	• • Ring		
			• • Bulletin 48-23	48-23-EN	Seal Ring
5	832868	1	• Protective helmet		MO-XXXX/187079
	851267	1	• Protective helmet		MOXXXX/187080-
5A	851262	1	• • Bushing		FOR BEARING PIN WITH 2 BOLTS.
6	832653	2	• Screw		
7	832655	2	• Washer		
8	944029	2	• Nut		
9	941872	4	• Stud		
10	832651	1	• Bushing		
11	832652	1	• Bushing		
12	832608	1	• Sign		
13	804269	2	• Drive screw		
14	897744	1	• Plug		MOXXXX/94050-
15	897745	1	• Gasket	IK	MOXXXX/94050-
16	897726	1	Sealing strip	IK	
17	824527	1	Hull fitting		
18	925256	1	O-ring	IK	
19	925055	4	O-ring	IK	
20	839064	4	Screw		
21	897631	1	Rubber bellows		270T
	850443	1	Bellows		280T
22	961675	2	Hose clamp		
23	897744	1	Plug		
24	897745	1	Gasket	IK	
25	875531	1	Rubber cushion		
26	832565	2	• Gasket		
27	940097	2	• Washer		(960142)
28	950364	2	• Nut		
29	814473	1	Rubber plug		
30	943426	6	Screw		
31	940176	6	Nut		
32	850418	6	O-ring		
33	190878	6	Washer		
34	839091	1	Hose		
35	897745	1	Gasket	IK	
36	820254	1	Control cable		L = 1800 MM
37	952635	1	Clamp		
38	832934	2	Zinc electrode		
39	941809	4	Screw		
40	806310	1	Clamping ring		
41	804190	2	• Rubber ring		
42	191844	6	• Screw		
43	806624	3	• Striker plate		
44	832821	2	Pivot pin		
45	941873	2	Screw		
46	941670	2	Washer		
47	832831	1	Hose		
48	961668	2	Hose clamp		
49	851766	1	Hose connection		SEE GROUP 4C
50	832814	1	Shaft		
51	946242	1	Sealing ring	IK	
52	11013	1	Ball bearing		
53	914533	2	Snap ring		
54	914462	1	Lock ring		
55	958860	1	Sealing ring	IK	
56	952986	X	Rubber hose		L = 170 MM SEE GROUP 2B
57	943482	2	Hose clamp		(951799) SEE GROUP 2B
58	832806	1	Flywheel housing		

AQ170A,AQ170B

REF	PART NO.	QTY	DESCRIPTION	SEE SEC.	NOTES
59	831075	1	Gasket	IK	
60	180019	1	Lubricator		
61	955549	2	Screw		L = 45 MM
	940160	2	Screw		L = 38 MM
62	941909	4	Spring washer		
63	940162	2	Screw		
64	955535	4	Screw		
65	942336	6	Spring washer		
66	430116	1	Bracket		
67	832848	1	Grommet		
68	925063	1	O-ring	IK	
69	950352	2	Lock nut		
70	955893	4	Washer		
71	831237	1	Seal flange		
72	925063	1	O-ring	IK	
73	950352	2	Lock nut		
74	839413	1	Spindle arm		
75	955537	1	Screw		
76	940097	1	Washer		
77		X	CABLES AND CABLE TERMINALS		SEE GROUP 3
78			HYDRAULIC SYSTEM AND INSTALLATION COMPONENTS	04A-1450	
79	804429	1	Hose attachment		MOXXXX/94050-
80	943473	2	Hose clamp		(951789) MOXXXX/94050-
81	952969	X	Rubber hose		L = 500 MM MOXXXX/94050-
82	897824	1	Conveyer stop		FOR TRANSPORT.
83	944738	1	Plastic plug		FOR TRANSPORT.
84		X	CONTROL CABLE		SEE GROUP 9
	875192	1	Gasket kit		SEE GROUP 10