

AQ165A, BB165A

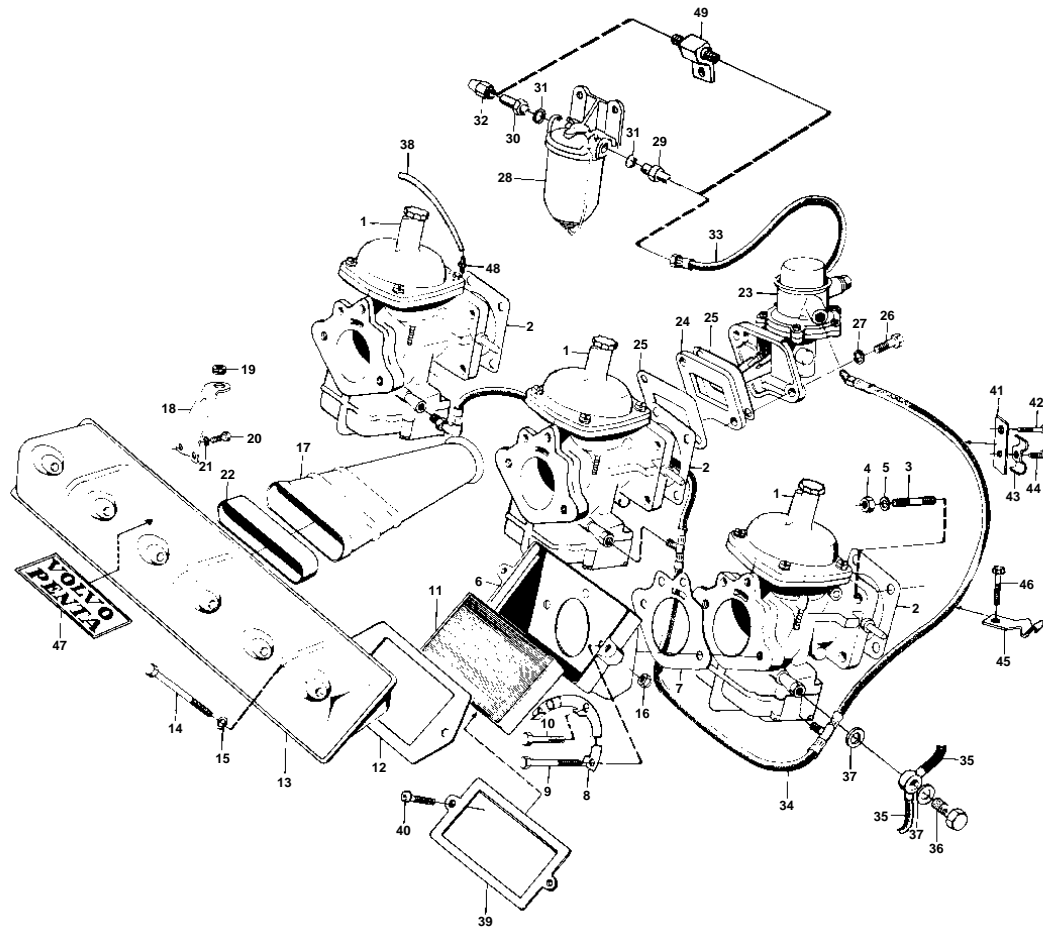

3362

AQ165A, BB165A

| REF | PART NO. | QTY | DESCRIPTION | SEE SEC. | NOTES |
|-----|----------|-----|----------------------|----------|----------------|
| 1 | | 3 | Carburetor | | |
| | | | | 12823 | |
| 2 | 418754 | 3 | Gasket | | |
| 3 | | 12 | Stud | | |
| 4 | 950353 | 12 | Lock nut | | |
| 5 | 941907 | 12 | Spring washer | | |
| 6 | | 3 | Drip collector | | |
| 7 | 680642 | 3 | Gasket | | |
| 8 | | 3 | Splash plate | | |
| 9 | 955524 | 6 | Hexagon screw | | |
| 10 | 955523 | 3 | Hexagon screw | | |
| 11 | | 3 | Flame shield | | |
| 12 | 831129 | 3 | Gasket | | EXCL SPEC 9968 |
| 13 | | 1 | Muffler | | EXCL SPEC 9968 |
| 14 | 955517 | 6 | Hexagon screw | | EXCL SPEC 9968 |
| 15 | 941906 | 6 | Spring washer | | EXCL SPEC 9968 |
| 16 | | 6 | Lock nut | | |
| 17 | | 2 | Air inlet | | EXCL SPEC 9968 |
| 18 | | 2 | Bracket | | EXCL SPEC 9968 |
| 19 | | 2 | Grommet | | EXCL SPEC 9968 |
| 20 | 955512 | 4 | Hexagon screw | | EXCL SPEC 9968 |
| 21 | 941906 | 4 | Spring washer | | EXCL SPEC 9968 |
| 22 | | 2 | Rubber gaiter | | EXCL SPEC 9968 |
| 23 | 831092 | 1 | Fuel pump | | |
| | | | | 12820 | |
| 24 | 460678 | 1 | Spacer | | |
| 25 | 61830 | 2 | Gasket | | |
| 26 | | 2 | Screw | | |
| 27 | 941907 | 2 | Spring washer | | |
| 28 | | 1 | Fuel filter | | |
| | | | | 12808 | |
| 29 | | 1 | Nipple | | |
| 30 | 191397 | 1 | Nipple | | |
| 31 | 957176 | 2 | Gasket | | |
| 32 | 954322 | 1 | Fitting nut | | |
| 33 | 813007 | 1 | Fuel hose | | |
| 34 | | 1 | Fuel hose | | EARLY TYPE |
| 35 | | 1 | Fuel hose | | LATE TYPE |
| 36 | 943500 | 3 | Hollow screw | | LATE TYPE |
| 37 | 957171 | 6 | Gasket | | LATE TYPE |
| 38 | | X | Hose | | SEE GROUP 3 |
| 39 | | 3 | Retainer | | SPEC 9968 |
| 40 | 950046 | 6 | Cross recessed screw | | SPEC 9968 |
| 41 | | 1 | Anchorage | | |
| 42 | 940133 | 1 | Hexagon screw | | |
| 43 | | 1 | Clamp | | |
| 44 | | 1 | Cross recessed screw | | |
| 45 | | 1 | Clamp | | |
| 46 | 940136 | 1 | Hexagon screw | | SEE GROUP 2B |
| 47 | | 1 | Decal | | |
| 48 | 943513 | X | Nipple | | Accessory. |
| 49 | | 1 | Joint nipple | | ALT |