

500A, 501A

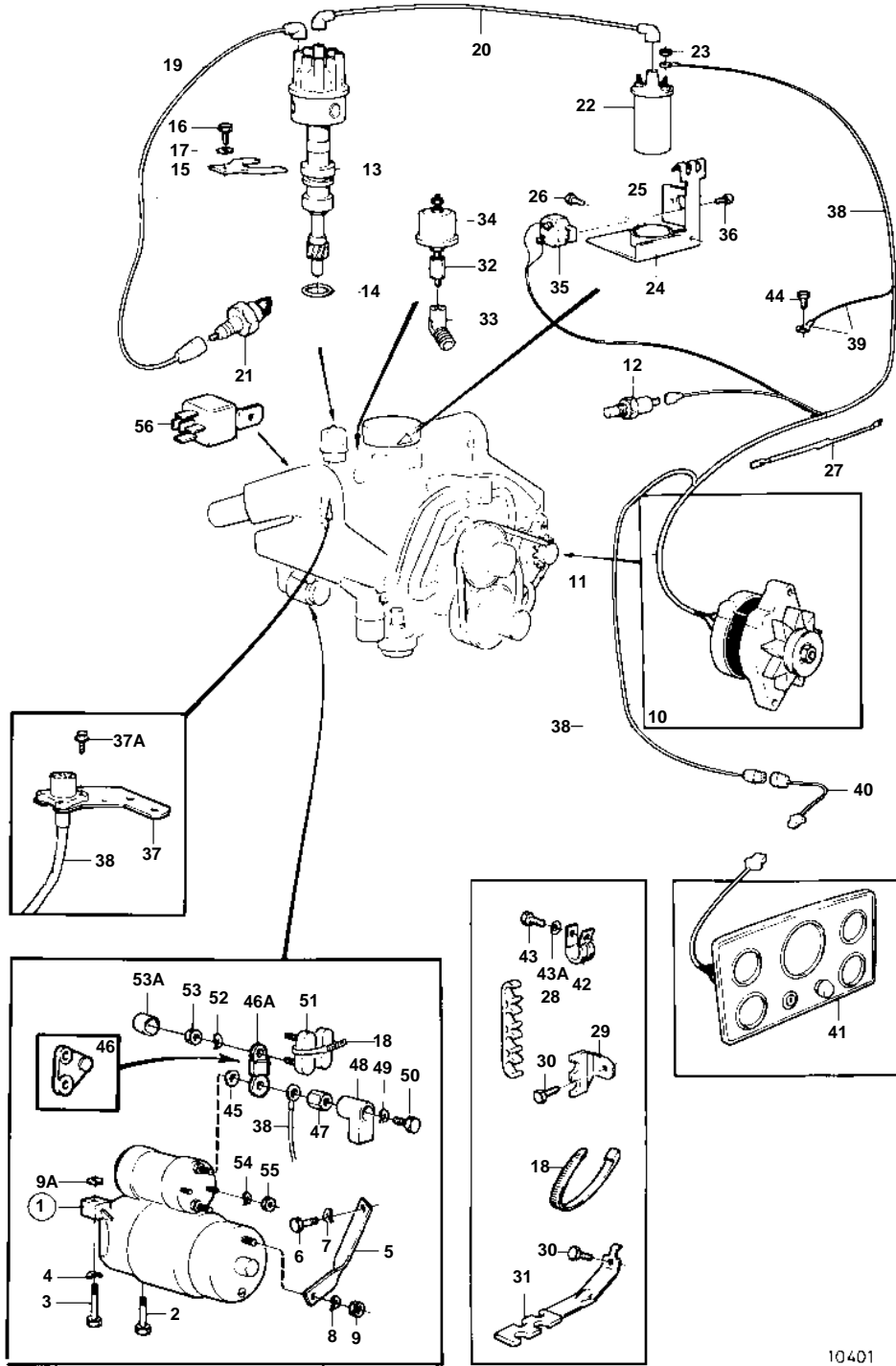

10401

## 500A, 501A

REF	PART NO.	QTY	DESCRIPTION	SEE SEC.	NOTES
1	855326	1	Starter motor		ALSO AVAILABLE AS AN EXCHANGE PART.
				19753	
2	835424	1	Screw		
3	835425	1	Screw		
4	942336	2	Spring washer		
5	855315	1	Anchorage		
6	940113	1	Hexagon screw		
7	941907	1	Spring washer		
8	941906	1	Spring washer		
9	955825	1	Hexagon nut		
9A	841194	X	Adjusting washer		
10		1	ALTERNATOR DRIVE BELT TEMPERATURE SENDER	19749	
11	966857	1	V-belt		SEE GROUP 2B
12	835630	1	Temperature sensor		SEE GROUP 2B
	835649	1	Sensor		FOR FLY BRIDGE.
13	856794	1	Distributor		(856699)
				19751	
14	835154	1	Gasket		
15	841530	1	Retainer		
16	855824	1	Screw		
17	941744	1	Washer		
18	948210	X	Cable tie		
19	856771	X	Ignition cable		ALL IGNITION CABLES PARTNO 856771 WHICH ARE 1000MM AND SHOULD BE CUT OFF IN SUITABLE LENGTHS., L = 1000 MM
20	856771	X	Ignition cable		ALL IGNITION CABLES PARTNO 856771 WHICH ARE 1000MM AND SHOULD BE CUT OFF IN SUITABLE LENGTHS., L = 1000 MM
21	876047	2	Spark plug kit		
22	855706	1	Ignition coil		
23		2	Nut		
24		1	BRACKET		SEE GROUP 2D
25	1219561	1	Clamp		
26		1	Screw		
27	834784	1	Resistor		
28		2	Retainer		
29		2	Retainer		
30	943629	3	Flange screw		(841426)
31	835427	2	Retainer		
32	835980	1	Nipple		
33	809109	1	Elbow nipple		
34	834920	1	Oil pressure sensor		
	834921	1	Oil pressure sensor		FOR FLY BRIDGE.
35	841178	1	Automatic fuse		40A
36	950013	2	Cross recessed screw		
37	856762	1	Bracket		
37A		4	Hexagon screw		
38	856727	1	Wiring harness		
39		X	· CABLE AND TERMINALS	19757	
40		X	Extension cable/verl		L = 3000 MM
	856882	X	Extension cable/verl		L = 6000 MM
41		1	Instrument panel		USA, EARLY TYPE
				19754	
		1	Instrument panel		EUR, EARLY TYPE
				19755	
	856820	1	Instrument panel		LATE TYPE
				19756	
42	942810	1	Clamp		
43	955534	1	Hexagon screw		
43A	942336	1	Spring washer		
44	943629	1	Flange screw		(841426)
45	1585449	1	Gasket		

500A, 501A

REF	PART NO.	QTY	DESCRIPTION	SEE SEC.	NOTES
46	852986	1	Current bar		REPL BY 860212
46A	860212	1	Current bar		
47	855330	1	Nut		
48	855798	1	Protecting sleeve		
49	940109	1	Toothed washer		
50	970943	1	Hexagon screw		
51	856355	1	Fuse		55A (853502)
52	941906	1	Spring washer		
53	955781	2	Hexagon nut		
53A	853572	1	Protective cap		
54	941905	2	Spring washer		
55	955780	2	Hexagon nut		
56	841177	1	Relay		