

501A/MS4

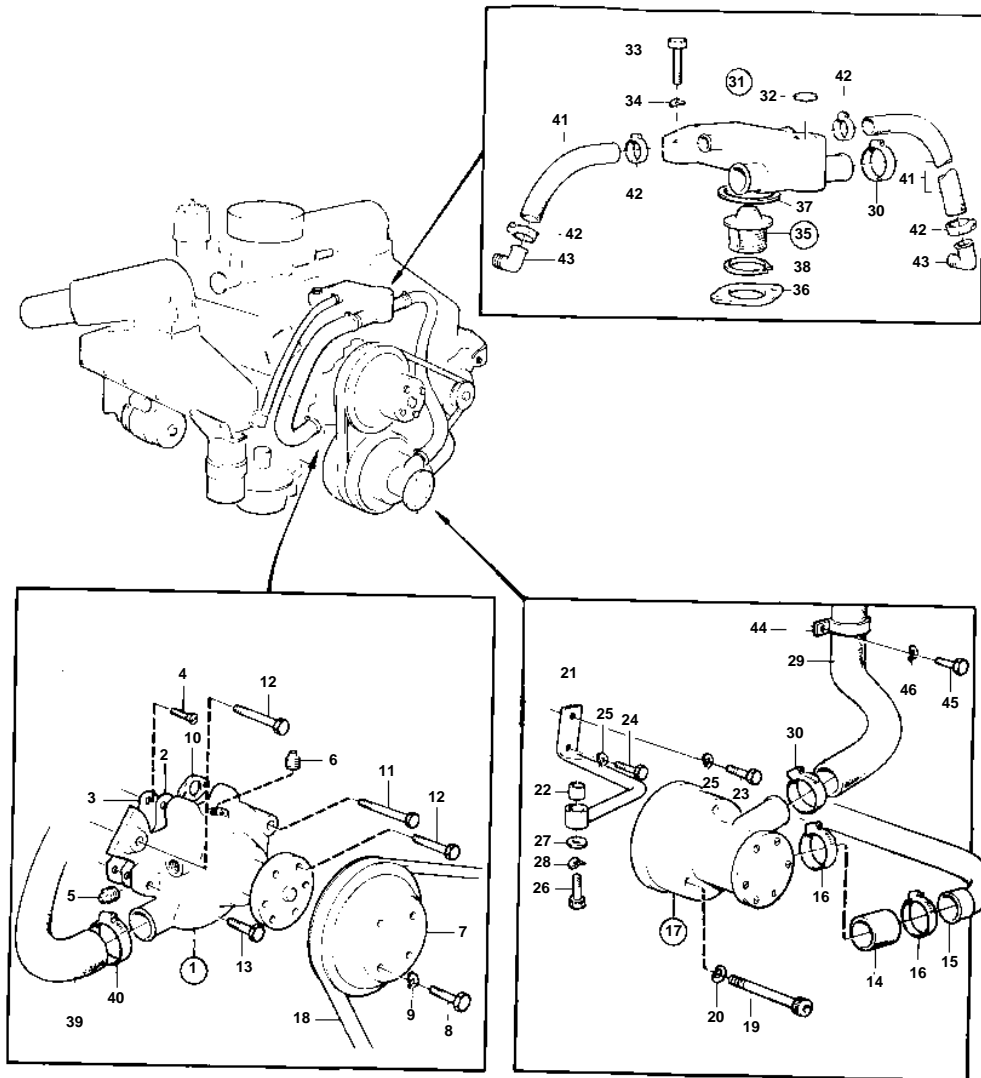

9251

501A/MS4

REF	PART NO.	QTY	DESCRIPTION	SEE SEC.	NOTES
1	835390	1	Water pump		REPLACED BY WATER PUMP 856364, WHICH CONTAINS 2 GASKETS 835210.
2	841036	1	· Gasket		
3		1	· Plate		REPL BY 856364
4	955511	6	· Hexagon screw		
5	952358	1	· Plug		
6	952359	1	· Plug		
7	855283	1	Pulley		
8	955655	4	Hexagon screw		
9	941907	4	Spring washer		
10	835210	2	Gasket		
11	940162	1	Hexagon screw		
12	955536	2	Hexagon screw		
13	955540	1	Hexagon screw		
14	949315	X	Rubber hose		L = 75 MM SN 67511-
15		1	Suction pipe		SEE GROUP 4B
16	961669	2	Hose clamp		
17	841640	1	Sea water pump		REPL BY 856952
				19737	
	856952	1	Sea water pump		
				19737	
18	966857	1	V-belt		
19	948324	3	Hex. socket screw		
20	942336	3	Spring washer		
21	826421	1	Torque rod		
22	826422	1	Rubber bushing		
23	940115	1	Hexagon screw		
24	955534	1	Hexagon screw		SEE GROUP 3
25	942336	2	Spring washer		
26	955523	1	Hexagon screw		
27	960141	1	Washer		
28	941907	1	Spring washer		
29	826423	1	Hose		
30	961669	3	Hose clamp		
31	855485	1	Thermostat housing		
32	477026	1	· Expansion plug		
33	955537	2	Hexagon screw		
34	942336	2	Spring washer		
35	876305	1	Thermostat kit		62°C
36	835417	1	· Gasket		
37	416033	1	Sealing ring		
38	855486	1	Lock ring		
39	834906	1	Hose		
40	961671	2	Hose clamp		
41	952970	X	Hose		L = 2X350 MM
42	961666	4	Hose clamp		
43	961610	2	Hose nipple	19734	
44	841307	1	Clamp		
45	955534	1	Hexagon screw		
46	942336	1	Spring washer		