

5.0GLPEFS, 5.7GSPEFS

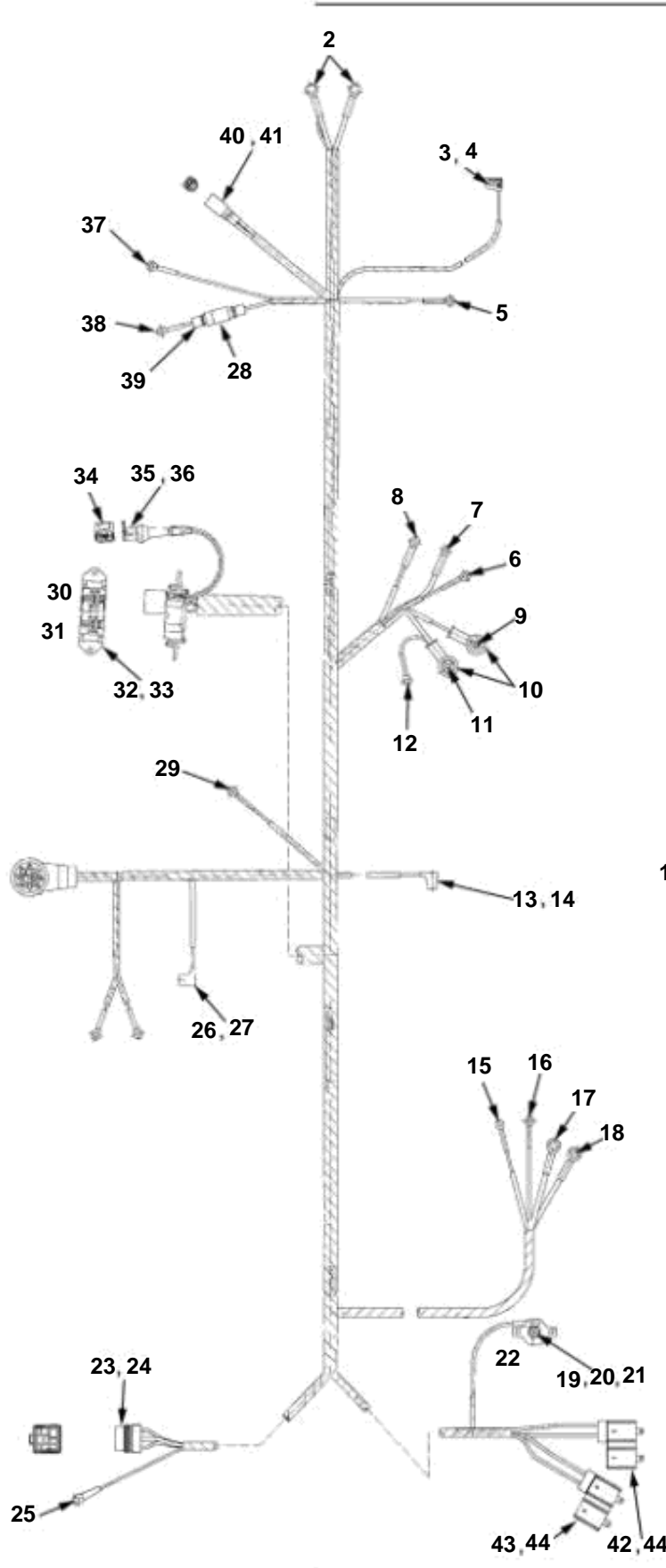

5.0GLPEFS, 5.7GSPEFS

REF	PART NO.	QTY	DESCRIPTION	NOTES
1	3860040	1	Wiring harness	
2	3852527	2	Terminal, Engine ground	
3	3852084	1	Terminal, Oil pressure switch	
4	3853320	1	Cardboard tube, Oil pressure switch	
5	3852233	1	Terminal, Oil pressure switch	
6		1	Terminal, Alternator excite	
7	3852245	1	Terminal, Alternator ground	
8	3852233	1	Terminal, Alternator indicator light	
9	3852233	1	Terminal, AC tap	
10	3852130	2	Rubber cap	
11	3852038	1	Terminal, Alternator output	
12		1	Terminal, Alternator sense	
13	3852084	1	Terminal, Water temperature switch	
14	3853320	1	Cardboard tube	
15	3852233	1	Terminal, Starter solenoid ignition terminal	
16		1	Terminal, Starter solenoid starter terminal	
17	3852527	1	Terminal, Starter solenoid	
18	3852527	1	Terminal, Starter solenoid	
19	3854164	1	Automatic fuse, 50 amp	
20	3852001	2	Spring washer, Circuit breaker	
21	3852064	2	Nut, Circuit breaker	
22	3852245	1	Terminal, Circuit breaker to splice	
23	3854192	1	Relay, Starter relay	
24	3852254	4	Terminal	
25	3852227	1	Terminal, Electrical ground bracket	
26	3852084	1	Terminal, Choke	
27	3853320	1	Cardboard tube, Choke	
28	3852229	1	Terminal, Receptacle	
29	3852233	1	Terminal, Water temperature transmitter	
30	3852210	1	Bracket	
31	3850403	1	Relay	
32	3852247	1	Terminal	
33	3852246	3	Terminal	
34	3853679	2	Terminal	
35		1	Connector, Fuel pump	not sold separately
36		1	Connector, Fuel pump	not sold separately
37	3852233	1	Terminal, Ignition coil	
38	3852233	1	Terminal, Ignition coil distributor terminal	
39	3852257	1	Terminal, Plug	
40	3853565	1	Connector, Trim sender	
41	3852229	1	Terminal, Trim sender	
42	979686	1	Fuse, 40 amp	
43	969197	1	Fuse, 7.5 amp	
44	3860455	2	Fuse holder	