

5.0FiPMDA, 5.0FiPMDM

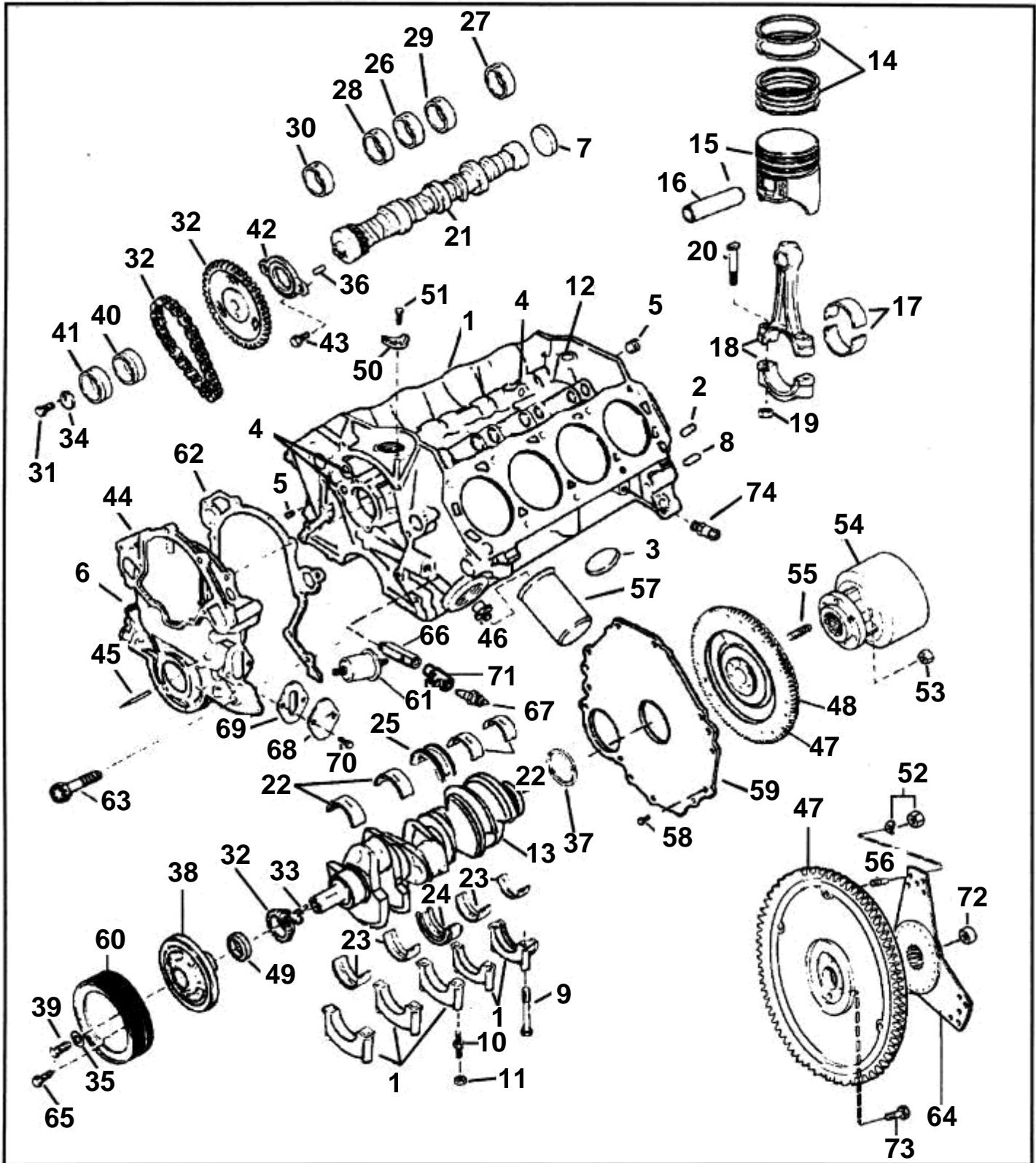

5.0FiPMDA, 5.0FiPMDM

REF	PART NO.	QTY	DESCRIPTION	SEE SEC.	NOTES
1	3850845	1	Longblock		Replaced by 3855166
			· Bulletin P-21-0-7	P-21-0-7-EN	Longblock guidelines, 5.0L, 5.8L, Ford
1	3855166	1	Longblock		
			· Bulletin P-21-0-7	P-21-0-7-EN	Longblock guidelines, 5.0L, 5.8L, Ford
2	3853007	4	Guide sleeve, Cylinder head to block		
3		6	Cap plug, Core hole		
4	3853008	2	Cap plug, Oil passage		
5		6	Plug, Oil gallery		
6	3853008	2	Cap plug, Oil passage		
7		1	Cap plug, Rear, cam, standard		
	3853009	1	Cap plug, Rear cam, 0.060 in. OS		
8		1	Locating pin, Adapter hsg to block		
9		9	Bolt, Main bearing cap		
10		1	Stud, Main bearing cap		
11	3853026	1	Nut, Main bearing cap		
12		1	Cap plug, Rear hole in block		
13		1	Crankshaft, 851200 model		
14	3853900	1	Piston ring kit, Standard (pkg. of 2		Contains rings for 2 pistons.
		1	Piston ring kit, 0.020 in. OS		Contains rings for 2 pistons.
		1	Piston ring kit, 0.030 in. OS		Contains rings for 2 pistons.
	3853885	1	Piston ring kit, 0.040 in. OS		Contains rings for 2 pistons.
15	3857020	1	Piston, Standard		
	3857021	1	Piston, 0.020 in. OS		
	3857022	1	Piston, 0.030 in. OS		
	3857023	1	Piston, 0.040 in. OS		
16	3852773	8	Piston pin, Piston, standard		
17	3852775	16	Bearing, Connecting rod, standard		
	3853041	1	Bearing, Connecting rod, 0.010 in. US		
	3853042	1	Bearing, 0.020 in. US		
		1	Bearing, Connecting rod, 0.030 in. US		
		1	Bearing, Connecting rod, 0.040 in. US		
18	3853901	8	Connecting rod		
19	3852777	16	Nut, Connecting rod		
20		16	Bolt, Connecting rod		
21	3853770	1	Camshaft		
22		8	Bearing, Upper, standard		
			· Bulletin P-21-6-1	P-21-6-1-EN	Main Bearing Kits, 5.0 and 5.8L Ford
22		1	Bearing, Main, upper, 0.010 in. US		
		1	Bearing, Main, upper, 0.020 in. US		
		1	Bearing, Main, upper, 0.030 in. US		
23		8	Bearing, Lower, standard		
			· Bulletin P-21-6-1	P-21-6-1-EN	Main Bearing Kits, 5.0 and 5.8L Ford
23		1	Bearing, Main, lower, 0.010 in. US		
		1	Bearing, Main, lower, 0.020 in. US		
		1	Bearing, Main, lower, 0.030 in. US		
24	3852800	2	Bearing, Center, lower, standard		
			· Bulletin P-21-6-1	P-21-6-1-EN	Main Bearing Kits, 5.0 and 5.8L Ford
24		1	Bearing, Main, center, lower, 0.010 in. US		
		1	Bearing, Main, center, lower, 0.020 in. US		
		1	Bearing, Main, center, lower, 0.030 in. US		
25	3852799	2	Bearing, Center, upper, standard		
			· Bulletin P-21-6-1	P-21-6-1-EN	Main Bearing Kits, 5.0 and 5.8L Ford
25		1	Bearing, Main, center, upper, 0.010 in. US		
		1	Bearing, Main, center, upper, 0.020 in. US		
	3853059	1	Bearing, Main, center, upper 0.030 in. US		
26	3852781	1	Bearing, Camshaft, center		
		1	Bearing, Center, 0.015 in. US		

5.0FiPMDA, 5.0FiPMDM

REF	PART NO.	QTY	DESCRIPTION	SEE SEC.	NOTES
27	3852782	1	Bearing, Camshaft, rear		
	3853020	1	Bearing, Rear, 0.015 in. US		
28	3852783	1	Bearing, Camshaft		
		1	Bearing, Front intermediate, 0.015 in. US		
29	3852784	1	Bearing, Camshaft, rear intermediate		
		1	Bearing, Rear intermediate, 0.015 in. US		
30		1	Bearing, Camshaft, front		
		1	Bearing, Front, 0.015 in. US		
31		1	Bolt, Camshaft sprocket		
32	3853903	1	Chain		double roller, use link belt chain set 3856737 for service of chain and gears
	3856737	1	Chain, set		link belt
		1	· Chain, timing		link belt, not sold separately
		1	· Sprocket, crankshaft		link belt, not sold separately
		1	· Sprocket, camshaft		link belt, not sold separately
	3852785	1	Sprocket, camshaft		double roller, use link belt chain set 3856737 for service of chain and gears
	3852794	1	Sprocket, crankshaft		double roller, use link belt chain set 3856737 for service of chain and gears
33	3852795	1	Woodruff key, Sprocket		
34	3852790	1	Washer, Camshaft sprocket		
35	3853075	1	Washer		
36	3852786	1	Locating pin, Camshaft sprocket		
37	3852805	1	Sealing, Crankshaft, rear		
38		1	Vibration damper, Crankshaft		3 holes
39	3853021	1	Bolt, Crankshaft damper		
40		1	Eccentric, Fuel pump, outer		
41	3852789	1	Guide, Fuel pump, inner		
42	3852787	1	Plate, Camshaft thrust, standard		
		1	Plate, Camshaft thrust, 0.002 in. OS		
		1	Plate, Camshaft thrust, 0.004 in. OS		
43	3852788	2	Bolt, Thrust plate		
44	3853893	1	Timing gear casing, Cylinder front		
45	3852768	1	Turn signal, timing		
46	3853035	1	Insert, Dil filter		
47	3853953	1	Flywheel		
48		1	Gear ring, Flywheel		
49	3853827	1	Sealing, Front cover		
50	3853078	1	Clamp, Distributor		
51	3853077	1	Screw, Clamp, distributor		
52	3854496	6	Washer, Dampener to flywheel		290 DP
	3854497	6	Lock nut, Dampener to flywheel		290 DP
53	3853273	6	Nut		
54		1	Oscillation damper, Flywheel		290 DP
	3853862	1	Clutch, Flywheel		SX, DP-S
55	3853274	6	Stud, Flywheel & coupler to crankshaft		SX, DP-S
		6	Stud, Shoulder, dampener to flywheel		290 DP
56	3853003	1	Cardboard tube, Flywheel		
57	835779	1	Oil		
58	3852421	5	Screw, Flywheel cover to hsg		
59	3853003	2	Cardboard tube, Engine		
60	3854188	1	Pulley, Crankshaft		3 holes
61	834921	1	Oil pressure sensor, Oil psi, dual station		
	3853800	1	Oil pressure sensor, Oil pressure		
62	3852767	1	Gasket, Front cover		
63		1	Bolt, Front cover, 2 in		
		1	Bolt, Front cover, 1-3/4 in		
		1	Bolt, Front cover, 2-1/4 in		
	3853014	1	Bolt, Front cover, 2-1/2 in		
64		1	Oscillation damper		

5.0FiPMDA, 5.0FiPMDM

REF	PART NO.	QTY	DESCRIPTION	SEE SEC.	NOTES
65	3853557	3	Screw		
66	3853640	1	Fitting, Oil pressure switch & sender		
67	3854181	1	Breaker		
68	3854284	1	Cardboard tube, Fuel pump opening		
69	3852600	1	Gasket, Fuel pump opening		
70	3853266	1	Screw, Fuel pump cover		
71	3852503	1	Elbow, Street, oil pressure switch		
72	3850412	1	Bushing, Pilot, Crankshaft		
73	3855532	8	Screw, Flywheel to Crankshaft		290 DP
74	3854494	2	Drain cock		