

5.0FLPNCA, 5.0FLPNCB, 5.0FLPNCM, 5.0FLPNCS

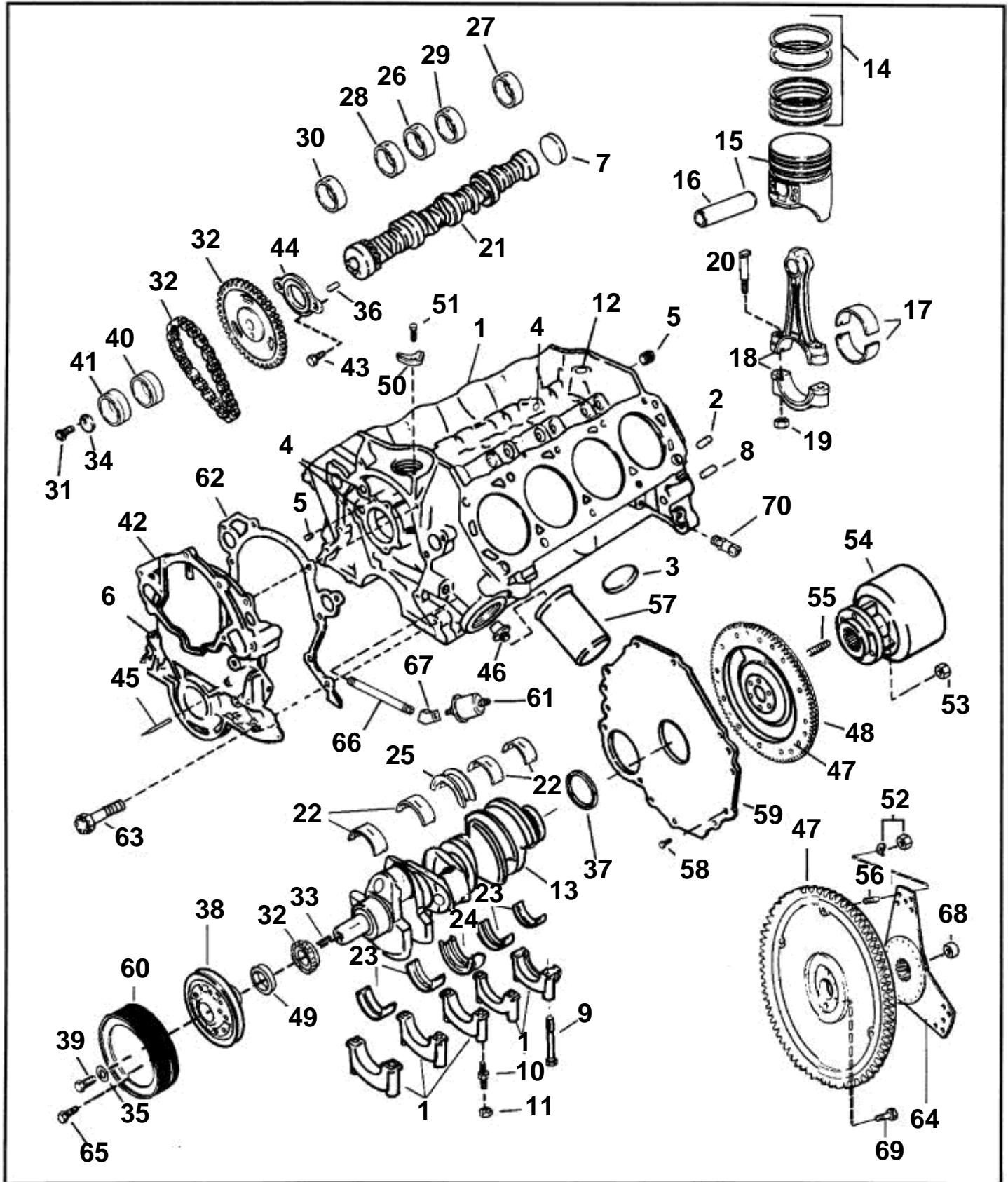

5.0FLPNCA, 5.0FLPNCB, 5.0FLPNCM, 5.0FLPNCS

| REF | PART NO. | QTY | DESCRIPTION | SEE SEC. | NOTES |
|-----|----------|-----|--|-------------|--|
| 1 | | 1 | Longblock · Bulletin P-21-0-7 | P-21-0-7-EN | Longblock guidelines, 5.0L, 5.8L, Ford |
| 2 | 3853007 | 4 | Guide sleeve, Cylinder head to block | | |
| 3 | | 6 | Cap plug, Core hole | | |
| 4 | 3853008 | 6 | Cap plug | | |
| 5 | | 6 | Plug, Oil gallery | | |
| 6 | 3853008 | 2 | Cap plug, Oil passage | | |
| 7 | | 1 | Cap plug, Rear, cam, standard | | |
| | 3853009 | 1 | Cap plug, Rear cam, 0.060 in. OS | | |
| 8 | 3853076 | 1 | Locating pin, Adapter hsg to block | | |
| 9 | | 9 | Screw, Main bearing cap | | |
| 10 | | 1 | Stud, Main bearing cap | | |
| 11 | 3853026 | 1 | Nut, Main bearing cap | | |
| 12 | 3853010 | 1 | Cap plug, Rear hole in block | | |
| 13 | 3852792 | 1 | Crankshaft | | |
| 14 | | 1 | Piston ring kit, Standard (pkg. of 2) | | Contains rings for 2 pistons. |
| | | 1 | Piston ring kit, 0.020 in. OS | | Contains rings for 2 pistons. |
| | | 1 | Piston ring kit, 0.030 in. OS | | Contains rings for 2 pistons. |
| | | 1 | Piston ring kit, 0.040 in. OS | | Contains rings for 2 pistons. |
| 15 | | 8 | Piston, Standard | | |
| | 3857021 | 1 | Piston, 0.020 in. OS | | |
| | 3857022 | 1 | Piston, 0.030 in. OS | | |
| | 3857023 | 1 | Piston, 0.040 in. OS | | |
| 16 | 3852773 | 8 | Piston pin, Piston, standard | | |
| 17 | 3852775 | 16 | Big end bearing kit, Connecting rod, standard | | |
| | 3853041 | 1 | Big end bearing kit, Connecting rod, 0.010 in. US | | |
| | 3853042 | 1 | Big end bearing kit, Connecting rod, 0.020 in. US | | |
| | 3853043 | 1 | Big end bearing kit, Connecting rod, 0.030 in. US | | |
| | 3853044 | 1 | Big end bearing kit, Connecting rod, 0.040 in. US | | |
| 18 | 3853901 | 8 | Connecting rod | | |
| 19 | 3852777 | 16 | Nut, Connecting rod | | |
| 20 | | 16 | Screw, Connecting rod | | |
| 21 | | 1 | Camshaft | | |
| 22 | | 8 | Main bearing, Upper, standard · Bulletin P-21-6-1 | P-21-6-1-EN | Main Bearing Kits, 5.0 and 5.8L Ford |
| 22 | | 1 | Main bearing, Main, upper, 0.010 in. US | | |
| | | 1 | Main bearing, Main, upper; 0.020 in. US | | |
| | | 1 | Main bearing, Main, upper, 0.030 in. US | | |
| 23 | | 8 | Main bearing, Lower, standard · Bulletin P-21-6-1 | P-21-6-1-EN | Main Bearing Kits, 5.0 and 5.8L Ford |
| 23 | | 1 | Main bearing, Main, lower, 0.010 in. US | | |
| | | 1 | Main bearing, Main, lower, 0.020 in. US | | |
| | | 1 | Main bearing, Main, lower, 0.030 in. US | | |
| 24 | | 2 | Thrust bearing, Center, lower, standard · Bulletin P-21-6-1 | P-21-6-1-EN | Main Bearing Kits, 5.0 and 5.8L Ford |
| 24 | | 1 | Thrust bearing, Main, center, lower, 0.010 in. US | | |
| | | 1 | Thrust bearing, Main, center, lower, 0.020 in. US | | |
| | 3853064 | 1 | Thrust bearing, Main, center, lower, 0.030 in. US | | |
| 25 | | 2 | Thrust bearing, Center, upper, standard · Bulletin P-21-6-1 | P-21-6-1-EN | Main Bearing Kits, 5.0 and 5.8L Ford |
| 25 | | 1 | Thrust bearing, Main, center, upper, 0.010 in. US | | |
| | | 1 | Thrust bearing, Main, center, upper, 0.020 in. US | | |

5.0FLPNCA, 5.0FLPNCB, 5.0FLPNCM, 5.0FLPNCS

| REF | PART NO. | QTY | DESCRIPTION | SEE SEC. | NOTES |
|-----|----------|-----|--|----------|---|
| 25 | | 1 | Thrust bearing, Main, center, upper 0.030 in. US | | |
| 26 | 3852781 | 1 | Camshaft bearing, Camshaft, center | | |
| | 3853019 | 1 | Camshaft bearing, Center, 0.015 in. US | | |
| 27 | 3852782 | 1 | Camshaft bearing, Camshaft, rear | | |
| | 3853020 | 1 | Camshaft bearing, Rear, 0.015 in. US | | |
| 28 | 3852783 | 1 | Camshaft bearing, Camshaft | | |
| | 3853022 | 1 | Camshaft bearing, Front intermediate, 0.015 in. US | | |
| 29 | 3852784 | 1 | Camshaft bearing, Camshaft, rear intermediate | | |
| | 3853023 | 1 | Camshaft bearing, Rear intermed., 0.015 in. US | | |
| 30 | 3852780 | 1 | Camshaft bearing, Camshaft, front | | |
| | 3853018 | 1 | Camshaft bearing, Front, 0.015 in. US | | |
| 31 | 3852791 | 1 | Screw, Camshaft sprocket | | |
| 32 | | 1 | Chain | | double roller, use link belt chain set 3856737 for service of chain and gears |
| | 3856737 | 1 | Chain, set | | link belt |
| | | 1 | · Sprocket, crankshaft | | link belt, not sold separately |
| | | 1 | · Sprocket, camshaft | | link belt, not sold separately |
| | | 1 | · Chain | | link belt, not sold separately |
| | | 1 | Sprocket, crankshaft | | double roller, use link belt chain set 3856737 for service of chain and gears |
| | | 1 | Sprocket, camshaft | | double roller, use link belt chain set 3856737 for service of chain and gears |
| 33 | 3852795 | 1 | Woodruff key, Sprocket | | |
| 34 | 3852790 | 1 | Washer, Camshaft sprocket | | |
| 35 | 3853075 | 1 | Washer | | |
| 36 | 3852786 | 1 | Locating pin, Camshaft sprocket | | |
| 37 | 3852805 | 1 | Seal, Crankshaft, rear | | |
| 38 | | 1 | Vibration damper, Crankshaft | | 4 holes |
| 39 | 3853021 | 1 | Screw, Crankshaft damper | | |
| 40 | 3852673 | 1 | Guide, Fuel pump, outer | | |
| 41 | | 1 | Guide, Fuel pump, inner | | |
| 42 | | 1 | Timing gear casing | | |
| 43 | 3852788 | 2 | Screw, Thrust plate | | |
| 44 | | 1 | Thrust plate, Camshaft thrust, standard | | |
| | 3853024 | 1 | Thrust plate, 0.002 in. OS, camshaft thrust | | |
| | | 1 | Thrust plate, 0.004 in. OS, camshaft thrust | | |
| 45 | 3852768 | 1 | Pin, timing | | |
| 46 | 3853035 | 1 | Insert, Oil filter | | |
| 47 | 3853953 | 1 | Flywheel | | |
| 48 | | 1 | Gear ring, Flywheel | | |
| 49 | | 1 | Seal, Front cover | | |
| 50 | 3853078 | 1 | Clamp, Distributor | | |
| 51 | 3853077 | 1 | Screw, Clamp, distributor | | |
| 52 | 3854496 | 6 | Washer, Dampener to flywheel | | 290 DP |
| | 3854497 | 6 | Lock nut, Dampener to flywheel | | 290 DP |
| 53 | 3853273 | 6 | Lock nut | | |
| 54 | | 1 | Rubber coupling, Flywheel | | SX, DP-S |
| 55 | 3853274 | 6 | Stud, Flywheel & coupler to crankshaft | | SX, DP-S |
| 56 | 3854495 | 6 | Stud, Shoulder, dampener to flywheel | | 290 DP |
| 57 | 835779 | 1 | Oil filter | | |
| 58 | 3852421 | 5 | Screw, Flywheel cover to hsg | | |
| | 3853003 | 1 | Cover | | |
| 59 | | 1 | V-belt pulley, Crankshaft | | |
| 60 | | 1 | V-belt pulley | | 4 holes |
| 61 | 3853800 | 1 | Oil pressure sensor, Dil pressure | | |
| | 834921 | 1 | Oil pressure sensor, Oil psi, Dual station | | |
| 62 | 3852767 | 1 | Gasket, Front cover | | |
| 63 | | 1 | Screw, Front cover, 2 in | | |
| | | 1 | Screw, Front cover, 1-3/4 in | | |

5.0FLPNCA, 5.0FLPNCB, 5.0FLPNCM, 5.0FLPNCS

| REF | PART NO. | QTY | DESCRIPTION | SEE SEC. | NOTES |
|-----|----------|-----|------------------------------------|----------|--------|
| 63 | | 1 | Screw, Front cover, 2-1/4 in | | |
| | 3853014 | 1 | Screw, Front cover, 2-1/2 in | | |
| 64 | 3850520 | 1 | Vibration damper | | 290 DP |
| 65 | 3853557 | 4 | Screw, Pulley to crankshaft | | |
| 66 | 3852712 | 1 | Nipple, Oil pressure sending unit | | |
| 67 | 3852711 | 1 | Fitting, Oil pressure sending unit | | |
| 68 | 3850412 | 1 | Bushing, Pilot, Crankshaft | | |
| 69 | 3855532 | 8 | Screw, Flywheel to Crankshaft | | 290 DP |
| 70 | 3854494 | 2 | Drain cock | | |