

431B

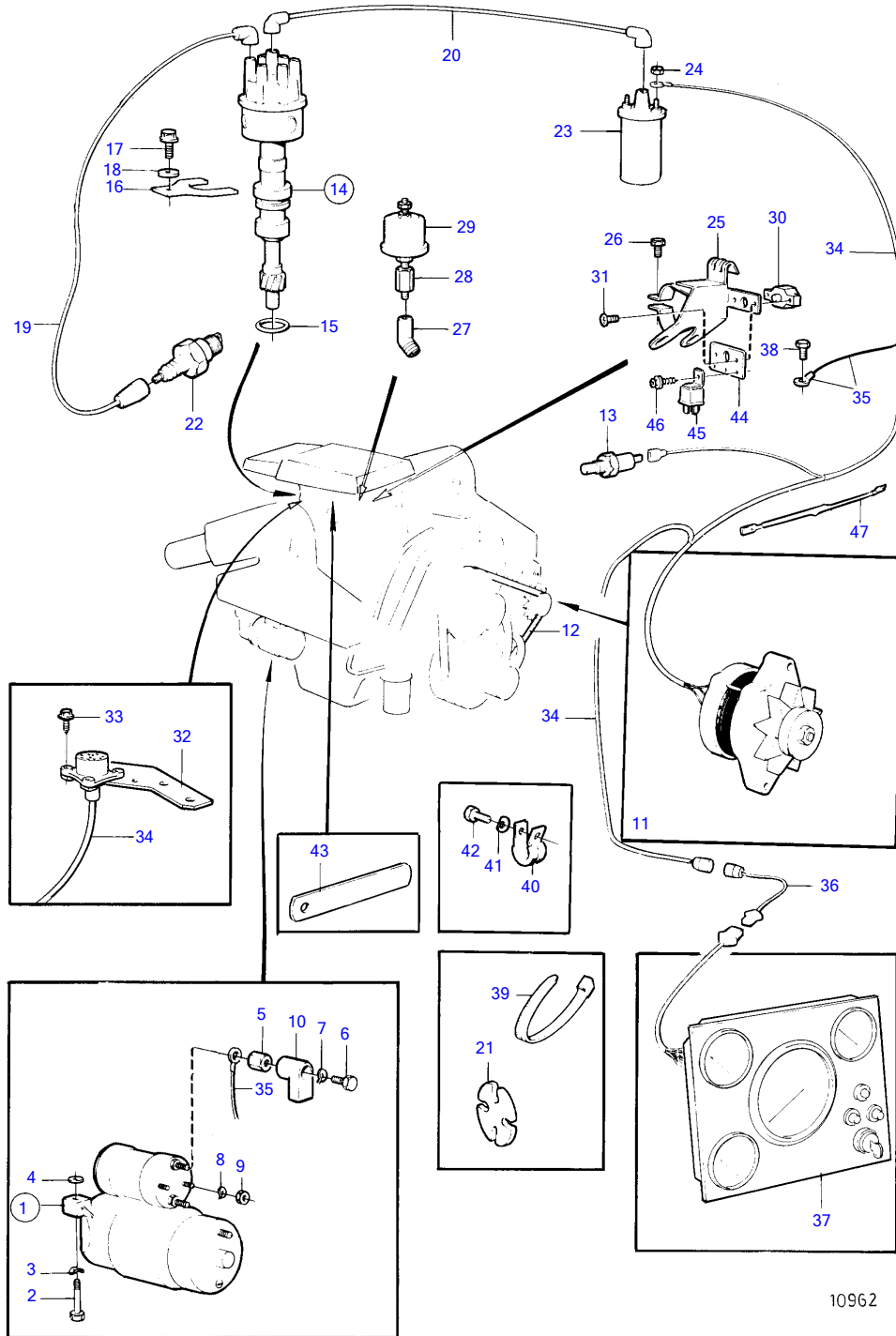

10962

## 431B

| REF | PART NO.  | QTY | DESCRIPTION                            | SEE SEC. | NOTES   |
|-----|-----------|-----|--|----------|---|
| 1   | 872394    | 1   | Starter motor                          |          |   |
|     |           |     | .                                      | 12551    |   |
| 2   | 835424    | 2   | Screw                                  |          |   |
| 3   | 942336    | 2   | Spring washer                          |          |   |
| 4   | 841194    | X   | Adjusting washer                       |          |   |
| 5   | 855330    | 1   | Spacer nut                             |          |   |
| 6   | 970943    | 1   | Hexagon screw                          |          |   |
| 7   | 940109    | 1   | Toothed washer                         |          |   |
| 8   | 941905    | 2   | Spring washer                          |          |   |
| 9   | 955780    | 2   | Hexagon nut                            |          |   |
| 10  | 855798    | 1   | Protecting sleeve                      |          |   |
| 11  |           | 1   | alternator and installation components | 12539    |   |
| 12  | 966857    | 1   | V-belt                                 |          | See group 2B  |
| 13  | 872067    | 1   | Temperature sensor                     |          | See group 2B  |
|     | 872068    | 1   | Temperature sensor                     |          | For fly bridge., See group 9  |
| 14  | 856143    | 1   | Distributor                            |          |   |
|     |           |     | .                                      | 12546    |   |
| 15  | 835154    | 1   | Gasket                                 |          |   |
| 16  | 841530    | 1   | Retainer                               |          |   |
| 17  | 940114    | 1   | Hexagon screw                          |          |   |
| 18  | 940097    | 1   | Washer                                 |          |   |
| 19  | 856771    | X   | Ignition cable                         |          | All ignition cables partno 856771 which are 1000mm and should be cut off in suitable lengths., L=1000mm |
| 20  | 856771    | X   | Ignition cable                         |          | All ignition cables partno 856771 which are 1000mm and should be cut off in suitable lengths., L=1000mm |
| 21  | (1219071) | 4   | Retainer                               |          | Obsolete part   |
| 22  | 876046    | 1   | Spark plug kit                         |          | Included in base engine., See group 10A   |
| 23  | 855706    | 1   | Ignition coil                          |          |   |
| 24  | (834772)  | 2   | Nut                                    |          | Obsolete part   |
| 25  | (856861)  | 1   | Bracket                                |          | Obsolete part   |
| 26  | (834371)  | 1   | Screw                                  |          | Obsolete part   |
| 27  | 809109    | 1   | Elbow nipple                           |          |   |
| 28  | 835980    | 1   | Nipple                                 |          |   |
| 29  | 872063    | 1   | Pressure sensor                        |          |   |
|     | 872064    | 1   | Pressure sensor                        |          | For fly bridge.   |
| 30  | 841178    | 1   | Automatic fuse                         |          | 40A   |
| 31  | 950014    | 2   | Cross recessed screw                   |          |   |
| 32  | 856762    | 1   | Bracket                                |          |   |
| 33  | (965364)  | 4   | Hexagon screw                          |          | Obsolete part   |
| 34  | 872795    | 1   | Wiring harness                         |          |   |
| 35  |           | X   | . cables and terminals                 | 12557    |   |
| 36  | (856881)  | X   | Extension cable'verl                   |          | Obsolete part, L=3000mm   |
|     | 856882    | X   | Extension cable'verl                   |          | L=6000mm  |
| 37  | 856820    | 1   | Instrument panel                       |          |   |
|     |           |     | .                                      | 12555    |   |
| 38  | 841426    | 1   | Screw                                  |          |   |
| 39  | 948210    | X   | Cable tie                              |          |   |
| 40  | 942810    | 1   | Clamp                                  |          | For cable unit.   |
| 41  | 942336    | 1   | Spring washer                          |          |   |
| 42  | 955534    | 1   | Hexagon screw                          |          |   |
| 43  | (83899)   | 1   | Clamp                                  |          | Obsolete part, For cable unit., On the carburetor.  |
| 44  | (857167)  | 1   | Bracket                                |          | Obsolete part   |
| 45  | 841177    | 2   | Relay                                  |          |   |
| 46  | 965354    | 3   | Hexagon screw                          |          |   |
| 47  | 834784    | 1   | Resistor                               |          |   |

7736260-30-12556

10962

Upd:2014-10-28