

TAMD41A

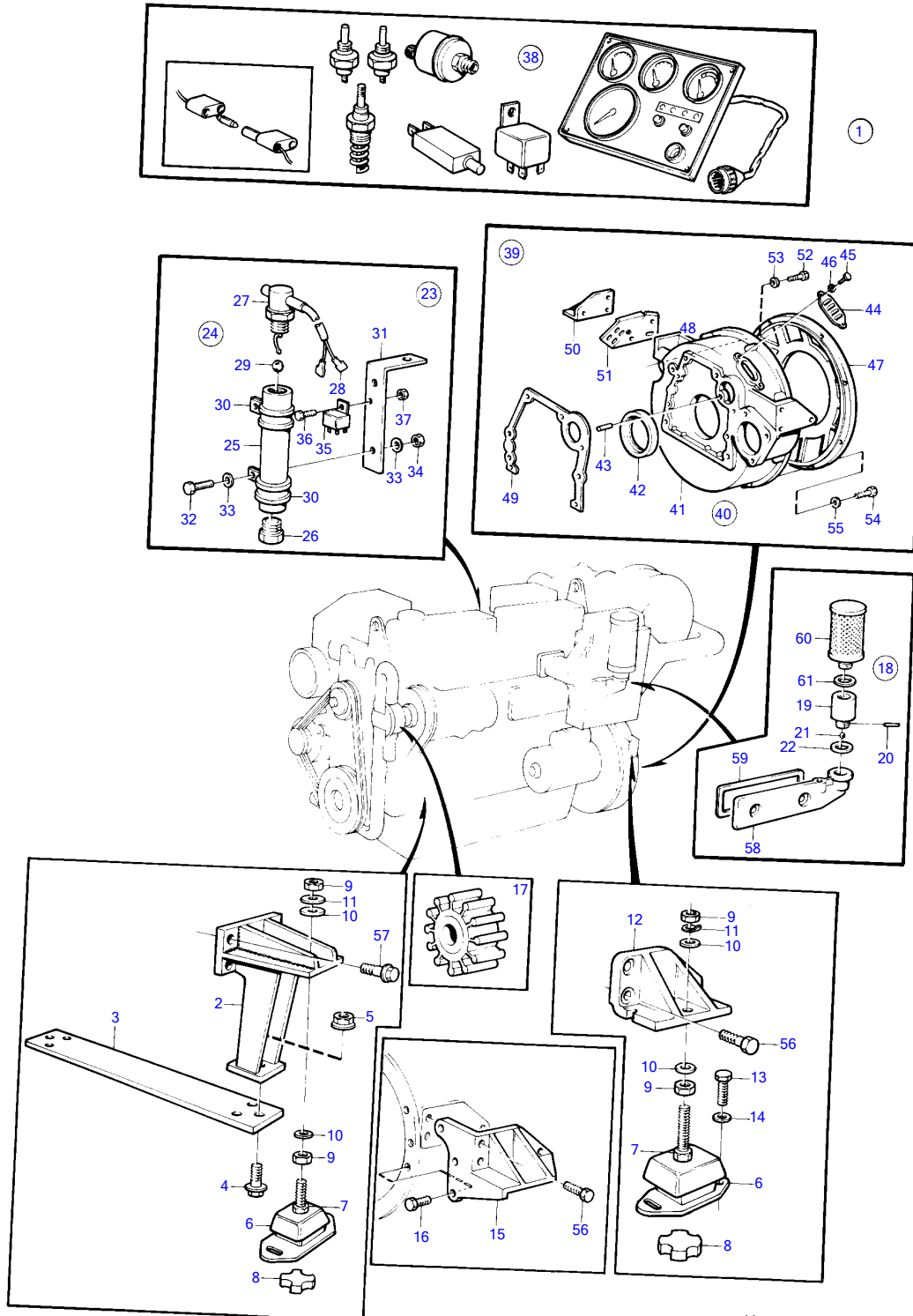

10264

TAMD41A

REF	PART NO.	QTY	DESCRIPTION	SEE SEC.	NOTES
1	(860361)	1	Conversion kit		Only for product no.868421, 12V, Obsolete part
2	858158	2	• Bracket		
3	858159	1	• Bracket		
4	965191	6	• Flange screw		
5	971096	6	• Flange nut		
6	858160	4	• Rubber cushion • Bulletin 44-26	44-26-EN	Reinforced Rubber Cushion
7	955900	4	• • Washer		
8	843299	4	• • Rubber disc		
9	955805	8	• Hexagon nut		
10	191940	6	• Washer		
	955900	2	• Washer		
11	941912	4	• Spring washer		
12	859375	1	• Engine mountings		
13	965220	8	• Flange screw		
14	960148	8	• Washer		
15	(858952)	1	• Engine bracket		Obsolete part
16	965186	3	• Flange screw		
17	858249	1	• Impeller		
18	858256	1	• Check valve		
19	858235	1	• • Check valve		
20	951971	1	• • Spring pin		
21	181501	1	• • Ball		
22	843449	1	• • Gasket		
23	(859951)	1	• Tilt monitor		Obsolete part
24	858255	1	• • Tilt monitor		
25	(858169)	1	• • • Sleeve		Obsolete part
26	914392	1	• • • Plug		
27	858454	1	• • • Switch		
28		X	• • • • cables, terminals		See group 3
29	(181332)	2	• • • Ball		Obsolete part
30	952635	2	• • Clamp		
31	(858803)	1	• • Bracket		Obsolete part
32	955271	2	• • Hexagon screw		
33	955892	4	• • Washer		
34	955781	2	• • Hexagon nut		
35	853544	1	• • Relay		
36	965199	1	• • Flange screw		
37	965483	1	• • Flange nut		
38	(859730)	1	• Conversion kit		Obsolete part
			• •	19643	
			• •	19641	
39		1	flywheel housing		For one starter., See group 2A
	(859998)	1	Flywheel housing		Obsolete part, For two starters.
40	(858254)	1	• Flywheel housing		Obsolete part
41	858164	1	• • Flywheel housing		
42	1542204	1	• • Sealing ring		
43	404069	1	• • Pin		
44	407092	1	• • Cover		
45	955269	2	• • Hexagon screw		
46	941906	2	• • Spring washer		
47	858165	1	• Cardboard tube		
48	859375	1	• Engine mountings		
49	829487	1	• Gasket		
50	859375	1	• Engine mountings		
51	(859437)	1	• Bracket		Obsolete part
52		8	screw		See group 2A
53		8	washer		See group 2A
54		10	screw		See group 2A
55		10	washer		See group 2A
56		6	screw		See group 2A
57		8	screw		See group 2A
58		1	crankcase breather		See group 2A

7745630-90-19642

10264

Upd:2011-09-27

