

TAD120BHC

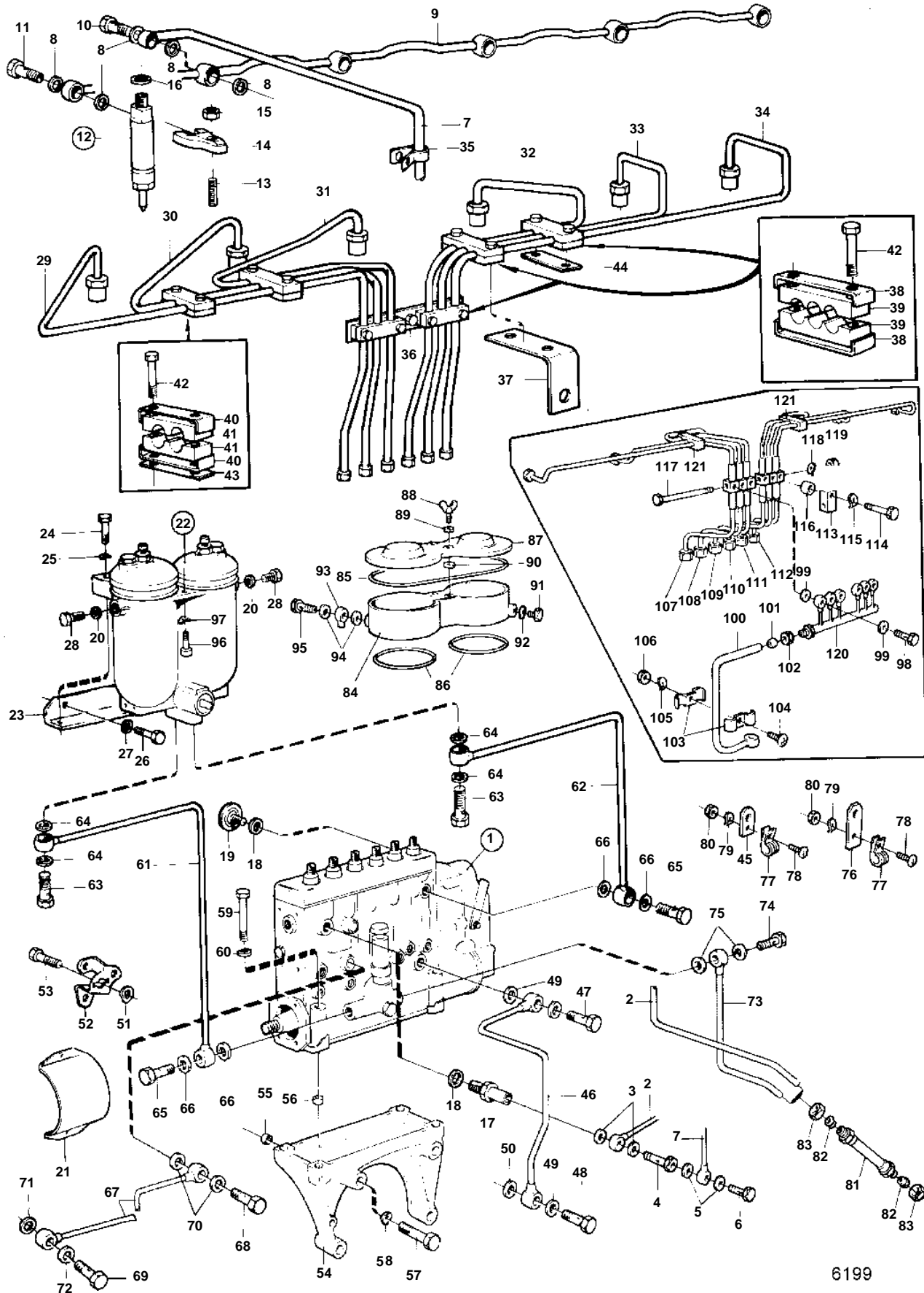

6199

TAD120BHC

REF	PART NO.	QTY	DESCRIPTION	SEE SEC.	NOTES
1	845369	1	Injection pump COMPS NOT SPEC.	02C-0500	
2	845712	1	Fuel pipe		
3	957178	2	Gasket	IK	
4	16496	1	Hollow screw		
5	946729	2	Gasket	IK	
6	74034	1	Hollow screw		
7	844543	1	Leak-off pipe		
8	946729	13	Gasket	IK	
9	822564	1	Leak-off pipe		
10	74034	1	Hollow screw		
11	74033	6	Hollow screw		
12	468748	6	Injector		
	3803245	6	Injector, exch		Exchange unit
				02C-0725	
13	468749	6	Cylinder head		
14	469797	6	Yoke		(468921)
15	961992	6	Nut		
16	948965	6	Sealing ring		
17	35096	1	Overflow valve		
18	18671	2	Gasket	IK	
19	466398	1	Pressure equalizer		
20	957178	2	Gasket	IK	
21			FUEL INJECTION PUMP	02C-0350	
22	243405	1	Fuel filter		
				02C-0750	
23	845319	1	Bracket		
24	940134	2	Screw		
25	941909	2	Spring washer		
26	940115	2	Screw		
27	942336	2	Spring washer		
28	960630	2	Plug		
29	844551	1	Delivery pipe		CYL. NO. 1
30	844552	1	Delivery pipe		CYL. NO. 2
31	844553	1	Delivery pipe		CYL. NO. 3
32	844554	1	Delivery pipe		CYL. NO. 4
33	844555	1	Delivery pipe		CYL. NO. 5
34	844556	1	Delivery pipe		CYL. NO. 6
35	947191	1	Clamp		
36	822546	1	Bracket		SEE GROUP 2B
37	844659	2	Attaching plate		SEE GROUP 2B
38	414346	10	Clamp		
39	414347	10	Rubber spacer		
40	414344	2	Clamp		
41	414345	2	Rubber spacer		
42	955247	12	Screw		
43	414736	1	Nut plate		
44	414735	1	Nut plate		
45	821036	1	Clamp		
46	422246	1	Pipe		
47	25167	1	Hollow screw		
48	954394	1	Hollow screw		
49	18671	3	Gasket	IK	
50	11998	1	Gasket	IK	
51	941906	1	Spring washer		SEE GROUP 2D
52	821134	1	Lever		SEE GROUP 2D
53	468848	1	Screw		SEE GROUP 2D
54	468558	1	Bracket		
55	423161	2	Guide sleeve		
56	417588	1	Guide sleeve		
57	955566	4	Screw		
58	940280	4	Spring washer		

TAD120BHC

REF	PART NO.	QTY	DESCRIPTION	SEE SEC.	NOTES
59	940156	4	Screw		
60	190509	4	Washer		
61	845445	1	Fuel pipe		
62	836749	1	Tube		
63	26013	2	Hollow screw		
64	947624	4	Gasket		
65	25167	2	Hollow screw		
66	957178	4	Gasket		
67	423393	1	Pressure oil line		
68	48634	1	Hollow screw		
69	837709	1	Hollow screw		SEE GROUP 2B
70	957173	2	Gasket	IK	
71	18666	1	Gasket	IK	
72	11994	1	Gasket	IK	
73	845711	1	Fuel pipe		
74	25167	1	Hollow screw		
75	957178	2	Gasket	IK	
76	821625	1	Anchorage		
77	952625	2	Clamp		
78	950046	2	Screw		
79	941906	2	Spring washer		
80	955825	2	Nut		
81	845450	2	Fuel hose		
82	956969	4	Ferrule		
83	956983	4	Nut		
84	846457	1	Reservoir		
85	846460	1	Sealing ring		
86	846458	2	Sealing ring		
87	846459	1	Cover		
88	846461	2	Wing screw		
89	947620	2	Gasket		
90	951665	2	Retaining ring		
91	960630	1	Plug		
92	947621	1	Gasket		
93	25168	1	Banjo nipple		
94	957178	2	Gasket		
95	25167	1	Hollow screw		
96	959223	1	Screw		L = 30 MM
	959227	1	Screw		L = 50 MM
97	941907	2	Spring washer		
98	846183	6	Hollow screw		
99	845953	12	Gasket		
100	844130	1	Tube		SEE GROUP 3
101	956969	1	Ferrule		
102	956983	1	Nut		
103	404279	4	Clamp		
104	956095	2	Screw		
105	941906	2	Spring washer		
106	955781	2	Nut		
107	846134	1	Delivery pipe		CYL.NO.1. INCLUDED IN FUEL INJECTOR.
108	846133	1	Delivery pipe		CYL.NO.2. INCLUDED IN FUEL INJECTOR.
109	846132	1	Delivery pipe		CYL.NO.3. INCLUDED IN FUEL INJECTOR.
110	846131	1	Delivery pipe		CYL.NO.4. INCLUDED IN FUEL INJECTOR.
111	846130	1	Delivery pipe		CYL.NO.5. INCLUDED IN FUEL INJECTOR.
112	846129	1	Delivery pipe		CYL.NO.6. INCLUDED IN FUEL INJECTOR.
113	846119	1	Spacer		
114	959800	1	Screw		SEE GROUP 2B
115	942336	1	Spring washer		
116	821540	1	Spacer sleeve		
117	955288	1	Screw		
118	941906	1	Spring washer		
119	955781	1	Nut		
120	846121	1	Leak-off pipe		

TAD120BHC

REF	PART NO.	QTY	DESCRIPTION	SEE SEC.	NOTES
121	846120	2	Clamp		