

TAMD63L-A, TAMD63L-B, TAMD63P-A

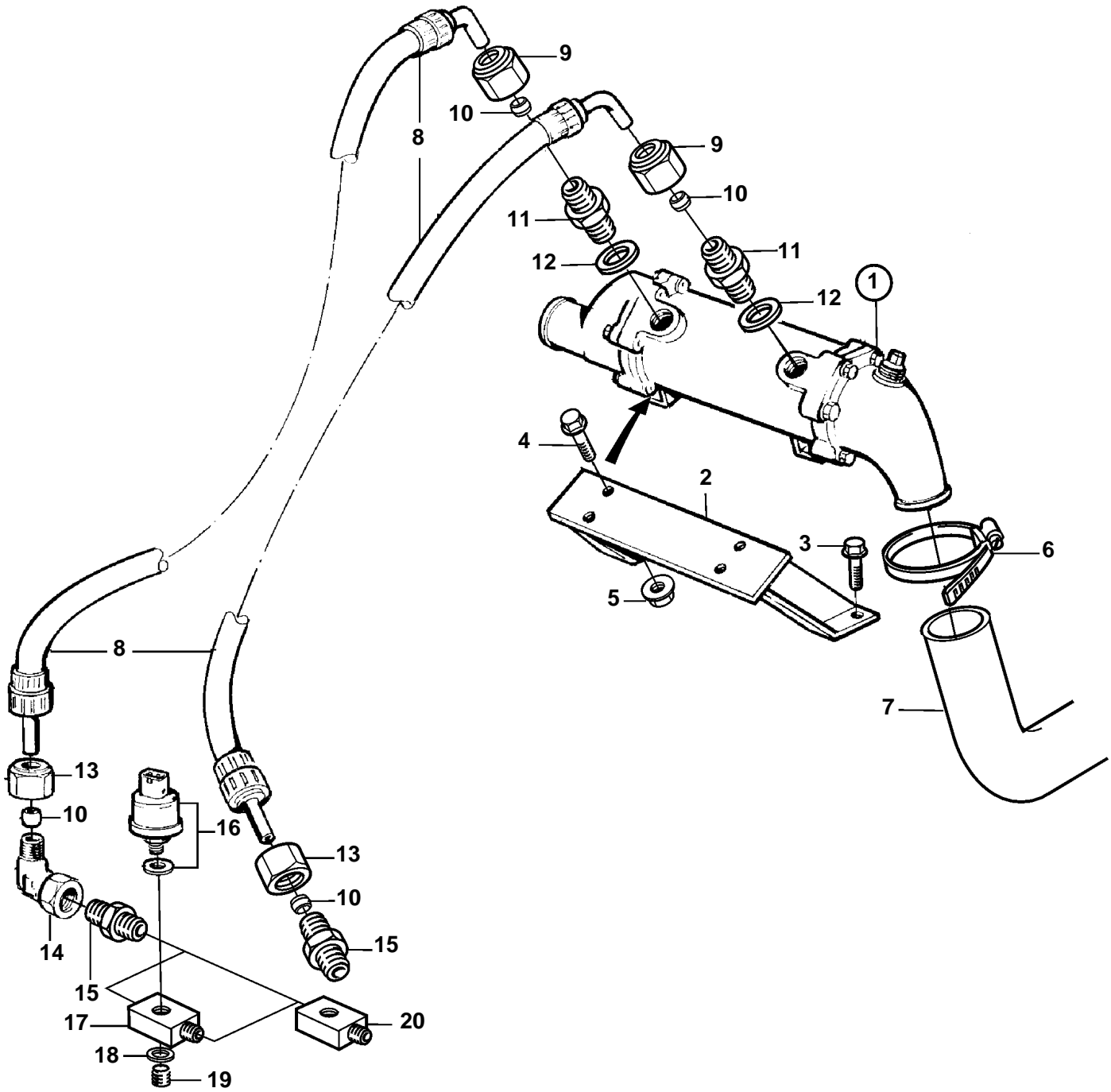

TAMD63L-A, TAMD63L-B, TAMD63P-A

| REF | PART NO. | QTY | DESCRIPTION | SEE SEC. | NOTES |
|-----|----------|-----|-----------------|----------|-----------------------|
| 1 | | 1 | Oil cooler | | |
| | | | | 772 | |
| 2 | 848098 | 1 | Bracket | | |
| 3 | 965191 | 2 | Screw | | |
| 4 | 955297 | 4 | Screw | | |
| 5 | 948645 | 4 | Lock nut | | |
| 6 | 961672 | 1 | Clamp | | |
| 7 | 866218 | 1 | Hose | | |
| 8 | 847165 | 2 | Hose | | L=580mm |
| 9 | 941331 | 2 | Nut | | |
| 10 | 1677898 | 4 | Ferrule | SO | (956970) |
| 11 | 968132 | 2 | Nipple | | |
| 12 | 11996 | 2 | Gasket | | |
| 13 | 956984 | 2 | Nut | | |
| 14 | 964016 | 1 | Nipple | | |
| 15 | 963959 | 2 | Nipple | | |
| 16 | 866839 | 1 | Pressure sensor | | SEE GROUP 30,0-30 bar |
| 17 | 862629 | 1 | Nipple | | |
| 18 | 947624 | 1 | Gasket | | |
| 19 | 960632 | 1 | Plug | | |
| 20 | 842425 | 1 | Nipple | | LATE TYPE |