

TAMD60A,TAMD60B

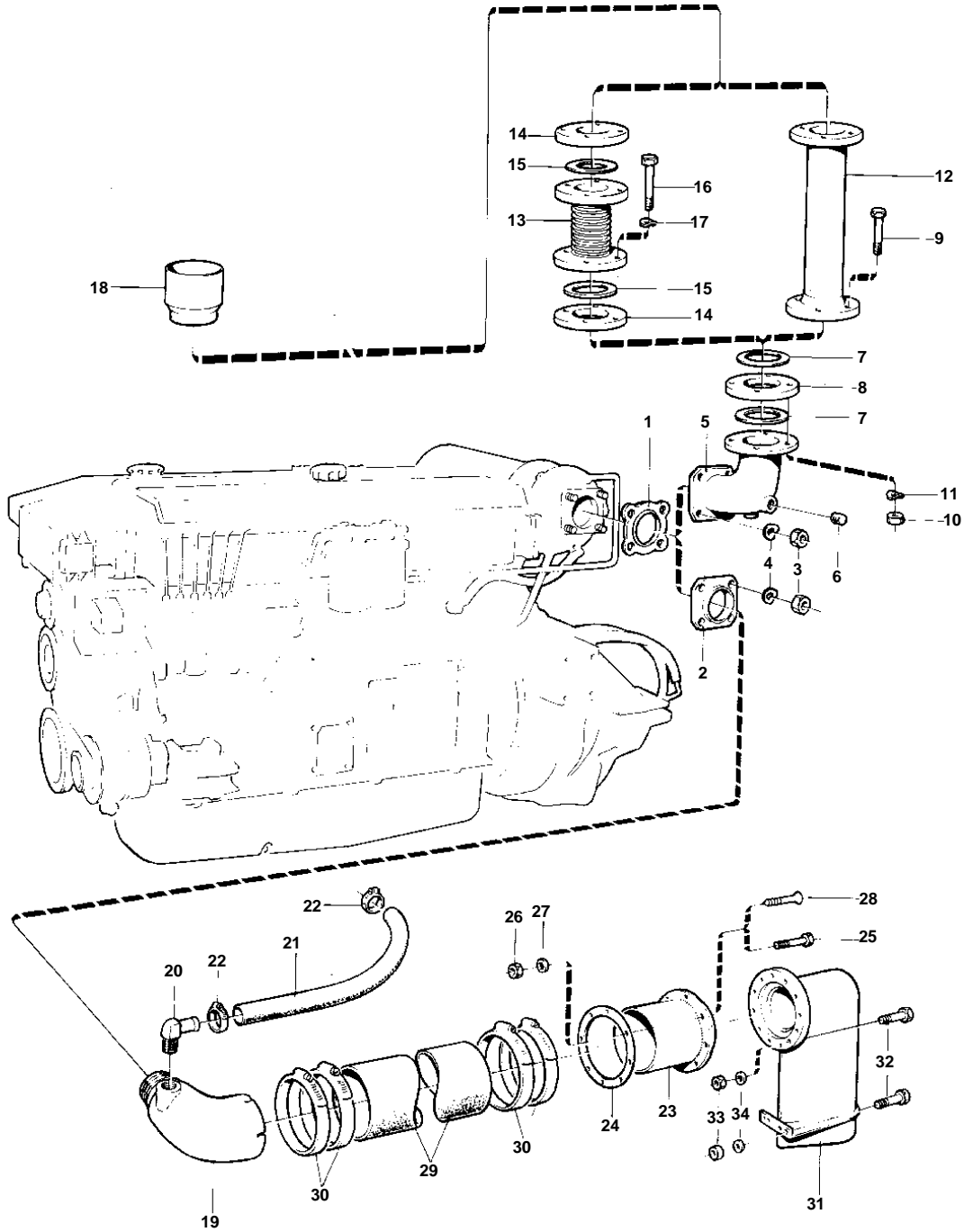

5260

TAMD60A,TAMD60B

REF	PART NO.	QTY	DESCRIPTION		NOTES
1	347096	1	Gasket	IK	
2	823770	1	Flange		
3	943927	4	Nut		
4	941908	4	Spring washer		
5	836057	1	Exhaust riser		
6	192154	2	Plug		
7	807578	2	Gasket		
8	807625	1	Exhaust pipe flange		
9	955592	4	Screw		
10	955829	4	Nut		
11	941912	4	Spring washer		
12	820900	1	Exhaust hose	L = 590 MM	
13		1	COMPENSATOR	L = 85 MM EARLY TYPE. REPLACED BY 1EA 843087 AND 8EA 955365.	
	843087	1	Compensator	L = 85 MM LATE TYPE	
		1	COMPENSATOR	L = 185 MM EARLY TYPE. REPLACED BY 1EA 843088 AND 8EA 955365.	
	843088	1	Compensator	L = 185 MM LATE TYPE	
14	820905	2	Connection flange		
15	807578	2	Gasket		
16	955591	8	Screw	EARLY TYPE	
	955365	8	Screw	LATE TYPE	
17	941912	8	Spring washer		
18	837614	1	Connector		
19	836745	1	Exhaust riser		
20	943134	1	Hose attachment		
21	13430	X	Rubber hose	L = 550 MM	
22	943476	2	Hose clamp	(951792)	
23	836757	1	Hull fitting		
24	836758	1	Gasket		
25	941815	8	Screw	L = 45 MM	
26	940190	8	Nut		
27	836768	8	Washer		
28	836769	8	Wood screw	ALT L = 38 MM	
29	828489	X	Exhaust hose	(837070)	
30	943485	4	Clamp	(951802)	
31	836823	1	Muffler		
32	959942	16	Screw		
33	940190	16	Nut		
34	940191	16	Washer		