

MD6,MD7A,MD7B

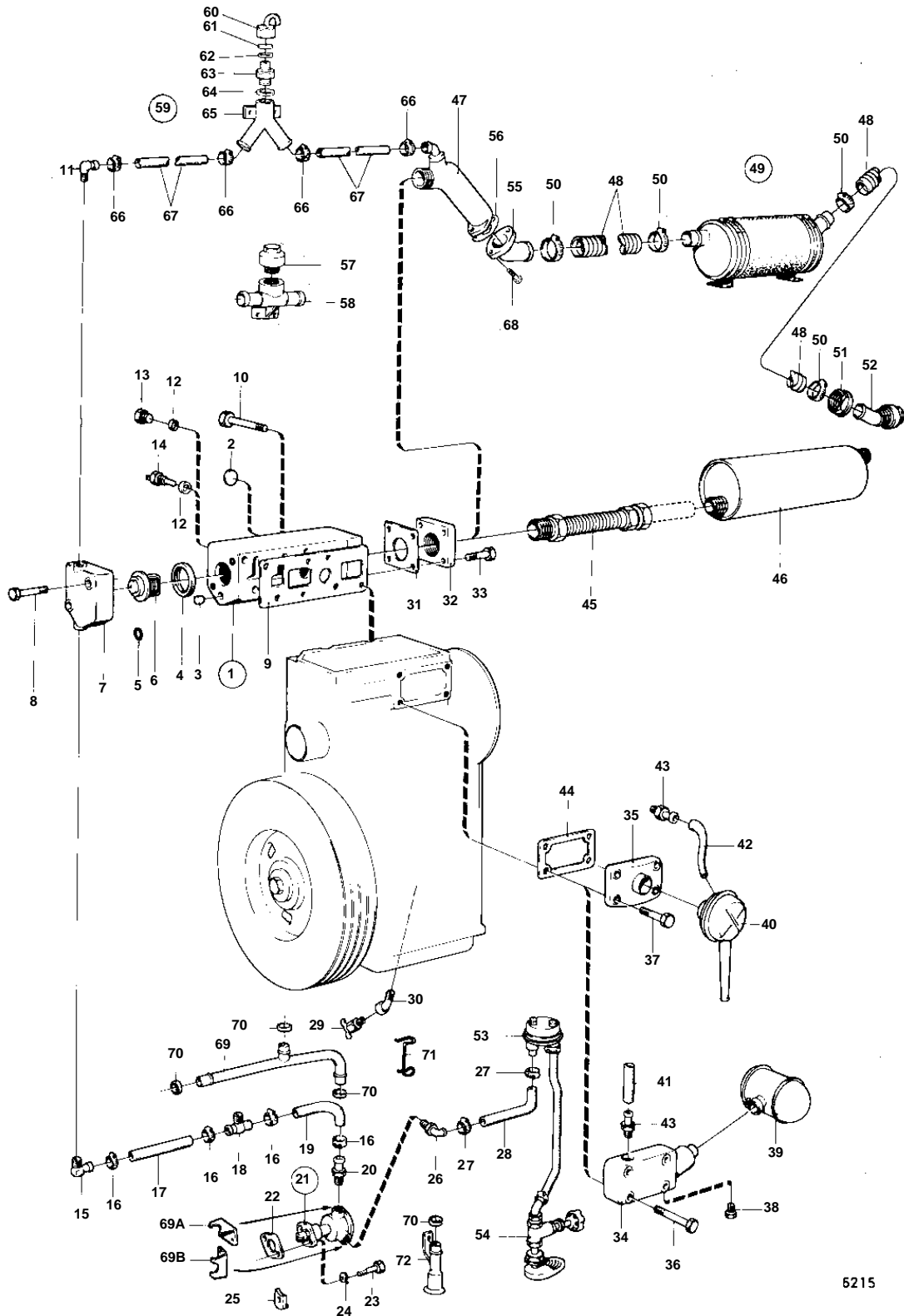

## MD6,MD7A,MD7B

REF	PART NO.	QTY	DESCRIPTION	SEE SEC.	NOTES
1	840211	1	Exhaust pipe		
2	192211	2	· Plug		D = 35 MM
	192426	1	· Plug		D = 26 MM
3	3848797	1	· Plug		
4	416033	1	Sealing ring	IK	(418361)
5	955989	1	O-ring	IK	
6	829812	1	Thermostat		62%Z9C
7	3875367	1	Cover		
8	955299	2	Screw		
9	3875382	1	Gasket	IK	
10	940129	4	Screw		
11	801197	1	Hose attachment		
12	957181	1	Gasket	IK	
13	960632	1	Plug		ALT
14		1	TEMPERATURE SENDER		ALT, SEE GROUP 3
15	945343	1	Elbow union		
16	943471	4	Hose clamp		(951787)
17	943416	X	Rubber hose		L = 190 MM
18	840002	1	Hose attachment		
19	3875787	1	Hose		
20	803648	1	Hose attachment		
21	807368	1	Water pump		REPLACED BY 833415.. MO-2994, 3015-3029, 3113-3189.
				02B-0550	
	833415	1	Water pump		
				02B-0550	
22	802551	1	Gasket	IK	
23	955295	2	Screw		
24	941907	2	Spring washer		
26	945391	1			
26	897391	1	Hose connection		MD6A/100S SPEC 867193. MD6A SPEC 867232.
27	943472	2	Hose clamp		
28	943368	X	Rubber hose		L = 200 MM
29	807036	1	Tap		
30	807079	1	Nipple		
31	3875050	1	Gasket	IK	
32	3875051	1	Flange	02B-0450	
33	955296	4	Screw		
34		1	INDUCTION MANIFOLD		MO-1302. REPLACED BY 840021 + 833414 + 840022 + 4EA 940142.
35	840021	1	Inlet pipe		MO 1303-
36	955302	4	Screw		MO-1302
37	940142	4	Screw		MO 1303-

MD6,MD7A,MD7B

REF	PART NO.	QTY	DESCRIPTION	SEE SEC.	NOTES
38	3848887	1	Plug		MO-1302
39		1	AIR FILTER		MO-1302. REPLACED BY 840021 + 833414 + 840022 + 4EA 940142.
40	833414	1	Air filter		MO 1303-
41	3875728	1	Hose		MO-1302
42	840022	1	Hose		MO 1303-
43	3849143	2	Nipple		MO-1302
	3849143	1	Nipple		MO 1303-
44	3875381	1	Gasket	IK	
45	833841	1	Compensator		DRY EXHAUST LINE.
46	833840	1	Muffler		DRY EXHAUST LINE.
47	833602	1	Exhaust bellows		SEE GROUP 9
48	833755	X	Hose		
49		1	MUFFLER, WET		SEE GROUP 9, EARLY TYPE
	828064	1	Muffler		SEE GROUP 9
50	961672	5	Clamp		
51	827877	1	Nut		
52	827874	1	Hull fitting		SEE GROUP 9
53	831733	1	Strainer		SEE GROUP 9
54	828242	1	Cooling wate inlet		(836900) SEE GROUP 9
55	834292	1	Exhaust riser		
56	803374	1	Gasket	IK	
57		1	VACUUM VALVE		EARLY TYPE. REPLACED BY 828263, 828262.
58		1	HOUSING		EARLY TYPE. REPLACED BY 828263, 828262.
59	828534	1	Vacuum valve		(828263)
60		1	· UPPER UNIT		
61	828264	2	· Diaphragm		
62	828424	2	· Gasket		
63		1	· LOWER PART		
64	947282	2	· Gasket		
65	828262	1	Hose connection		LATE TYPE
66	961666	4	Hose clamp		
67	13569	X	Hose		
68	955320	2	Screw		