

MD30A,TMD30A,TAMD30A,AQAD30A

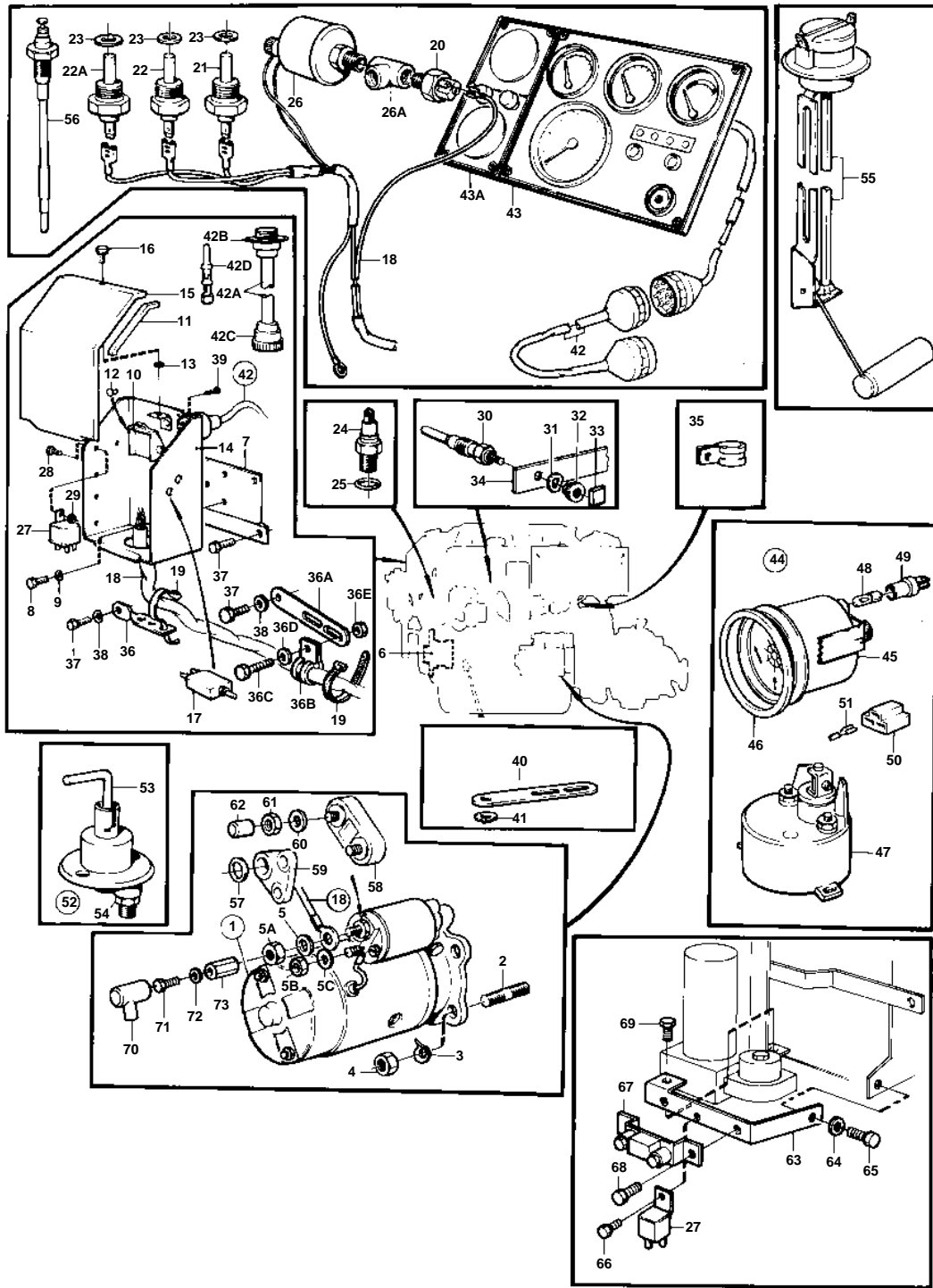

MD30A,TMD30A,TAMD30A,AQAD30A

REF	PART NO.	QTY	DESCRIPTION	SEE SEC.	NOTES
1	829527	1	Starter motor		12V
				030-0200	
	838987	1	Starter motor		24V
				030-0225	
2	953067	3	Stud		
3	941908	3	Spring washer		
4	955783	3	Nut		
5	955949	1	Lock washer		
5A	955782	1	Nut		
5B	955780	1	Nut		
5C	941905	1	Spring washer		
6		X	ALTERNATOR AND INSTALLATION COMPONENTS	030-0100	
7	838539	1	Bracket		(846763)
8	955268	3	Screw		
9	955892	3	Washer		
10	1234048	1	Lower section		
11	1214306	1	Protecting moulding		
12	942670	2	Rivet		
13	925051	1	O-ring		
14	846791	1	Box		
15	846662	1	Cover		
16	846736	1	Lock screw		
17	966689	1	Fuse		
18	846060	1	Cable trunk		
	858057	1	Cable trunk		SPEC.867947,867983.
19	948210	X	Strip clamp		
20	881348	1	Pressure switch		
21	833927	1	Thermo monitor		
	822858	1	Thermo monitor		SPEC.867947,867983.
	858595	1	Temperature sensor		FOR DUAL STATION.. COMBINED TEMPERATURE SENSOR AND GUARD. MO4960-
	858596	1	Temperature sensor		24V. FOR DUAL STATION.. COMBINED TEMPERATURE SENSOR AND GUARD. MO4960-
22	827151	1	Temperature sensor		
	843325	1	Temperature sensor		SPEC.867947,867983.
22A	840345	1	Temperature sensor		ALTERNATIVE FOR TEMP.SENDER 827151 AND THERMOSWITCH CONTROL 833927.
23	957181	1	Gasket	IK	
24	1502028	1	Tachometer sensor		
25	925059	1	O-ring	IK	
26	843231	1	Oil pressure sensor		
26A	942490	1	T-nipple		SPEC.867947,867983.
27	846762	2	Relay		
	838955	3	Relay		SPEC.867947,867983.
28	955268	2	Screw		
29	955781	2	Nut		
30	1542411	4	Glow plug		
	838954	4	Glow plug		SPEC.867947,867983.
31	941905	4	Spring washer		
32	955780	4	Nut		
33	1542408	4	Protecting casing		
34	1544108	1	Glow rail		
35	946834	1	Clamp		
36	354842	1	Bracket		EARLY TYPE
36A	965534	1	Bracket		LATE TYPE
36B	947827	1	Clamp		LATE TYPE
36C	955271	1	Screw		LATE TYPE
36D	941907	1	Spring washer		LATE TYPE
36E	955781	1	Nut		LATE TYPE

MD30A,TMD30A,TAMD30A,AQAD30A

REF	PART NO.	QTY	DESCRIPTION	SEE SEC.	NOTES
37	955268	2	Screw		
38	941907	1	Spring washer		(955894)
39	955119	4	Screw		
40	965534	1	Bracket		
41	955949	1	Lock washer		
42	846648	X	Extension cable		L = 3000 MM
	846649	X	Extension cable		L = 5000 MM
	846650	X	Extension cable		L = 7000 MM
42A	846639	X	· Cable		
42B	846647	1	· Pin connector		
42C	846612	1	· Sleeve connector		
42D		16	PIN	030-0300	
43	838926	1	Instrument panel		SEE GROUP 9
	858036	1	Instrument panel		SEE GROUP 9. SPEC.867947,867983.
43A		1	INSTRUMENT PANEL		SEE GROUP 9
44	840789	1	Rudder indicator kit		12V REPL BY 858884
45	828698	1	· Rudder indicator		
46	828542	1	· Front ring		
47	837772	1	· Rudder position sens		
48	19923	1	· Bulb		
49	808175	1	· Bulb socket		
50	945469	1	· Receptacle housing		
51	881485	3	· Cable terminal		
52	870980	1	Switch		
53	243700	1	· Handle		
54	955783	2	· Nut		
55	834400	1	Tank gauge		SEE GROUP 9. FOR DRINKING WATER.
	828716	1	Water level gauge		SEE GROUP 9. FOR DRINKING WATER.
	828717	1			SEE GROUP 9. FOR DRINKING WATER.
	834399	1	Tank gauge		SEE GROUP 9. FOR FUEL.
	828714	1	Fuel gauge kit		SEE GROUP 9. FOR FUEL.
	828715	1			SEE GROUP 9. FOR FUEL.
56			COOLING WATER LEVEL ALARM		SEE GROUP 9
57	829714	1	Seal		AQAD30A
58	853502	1	Fuse		AQAD30A
59	852986	1	Current bar		AQAD30A
60	941906	2	Spring washer		AQAD30A
61	955781	1	Nut		AQAD30A
	853573	1	Nut		AQAD30A
62	853572	1	Protective cap		AQAD30A
63	858078	1	Bracket		SPEC.867947,867983.
64	941908	1	Spring washer		SPEC.867947,867983.
65	955317	1	Screw		SPEC.867947,867983.
66	955268	1	Screw		SPEC.867947,867983.
67	838953	1	Resistor		SPEC.867947,867983.
68	955268	2	Screw		SPEC.867947,867983.
69	955296	1	Screw		SPEC.867947,867983.
70	855798	1	Protecting sleeve		
71	940199	1	Screw		
72	941907	1	Spring washer		
73	855314	1	Nut		