

MD1B,MD2B,MD3B

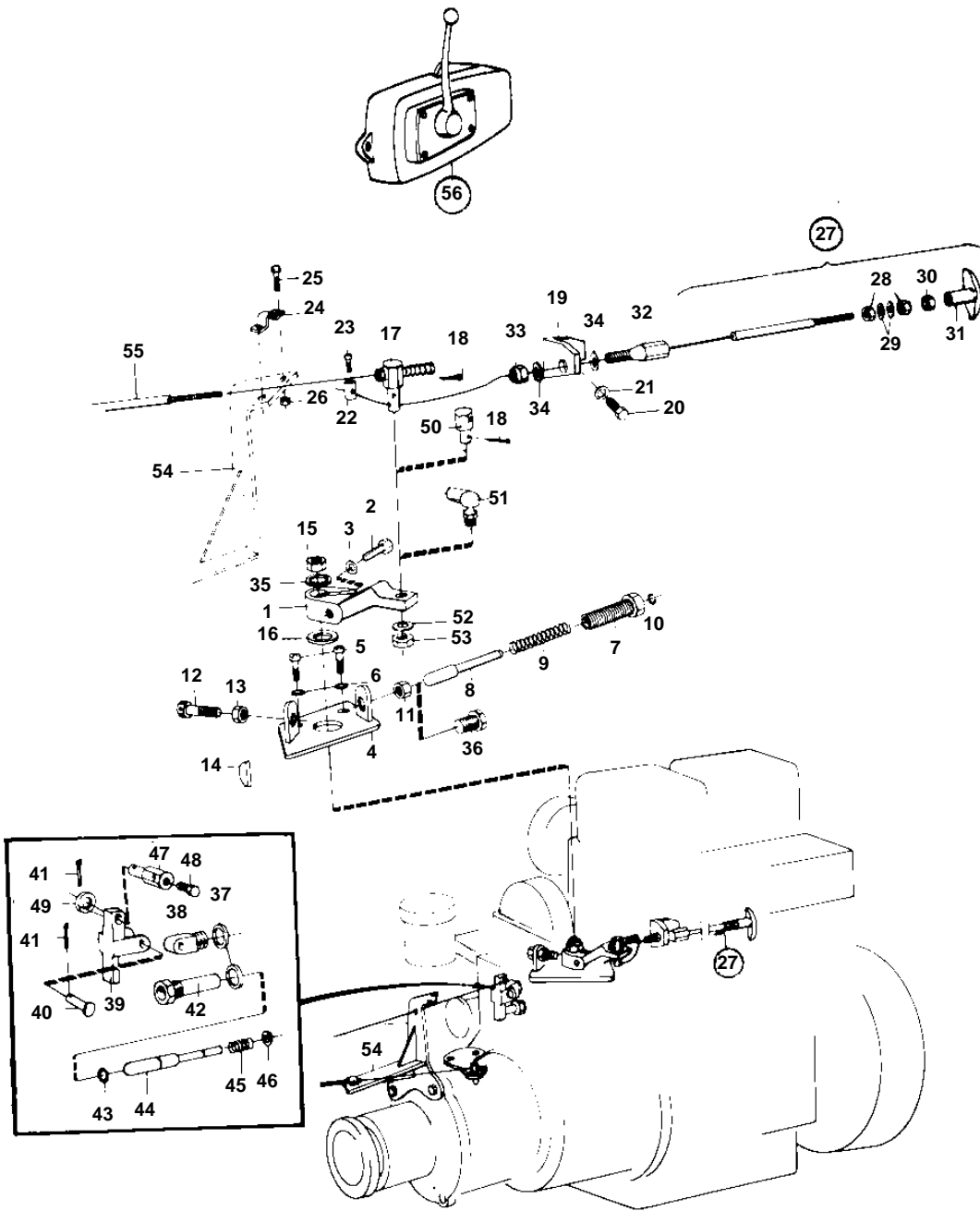

7160

MD1B,MD2B,MD3B

REF	PART NO.	QTY	DESCRIPTION	NOTES
1	833482	1	Lever	
2	959617	1	Screw	
3	941907	1	Spring washer	
4	833072	1	Bracket	
5	955270	2	Screw	
6	941906	2	Spring washer	
7	833076	1	Sleeve	MD1B SPEC 867091, 867142, MD1B 867229EARLY TYPE, MD2B SPEC 867094, 867122, 867230 MO-29258, 29309-29354. MD2B/HY. MD3B SPEC 867119, 867231 MO-5889. MD11C/HY, MD11C/HD-HY.
8	833077	1	Pin	MD1B SPEC 867091, 867142, MD1B 867229EARLY TYPE, MD2B SPEC 867094, 867122, 867230 MO-29258, 29309-29354. MD2B/HY. MD3B SPEC 867119, 867231 MO-5889. MD11C/HY, MD11C/HD-HY.
9	833078	1	Spring	MD1B SPEC 867091, 867142, MD1B 867229EARLY TYPE, MD2B SPEC 867094, 867122, 867230 MO-29258, 29309-29354. MD2B/HY. MD3B SPEC 867119, 867231 MO-5889. MD11C/HY, MD11C/HD-HY.
10	951667	1	Lock ring	MD1B SPEC 867091, 867142, MD1B 867229EARLY TYPE, MD2B SPEC 867094, 867122, 867230 MO-29258, 29309-29354. MD2B/HY. MD3B SPEC 867119, 867231 MO-5889. MD11C/HY, MD11C/HD-HY.
11	955792	1	Nut	
12	944323	1	Screw	
13	955782	1	Nut	
14	910112	1	Key	EARLY TYPE
15	963107	1	Nut	
16	955897	1	Washer	
17	833463	1	Cube	MD1B SPEC 867091, 867142, MD1B 867229EARLY TYPE, MD2B SPEC 867094, 867122, 867230 MO-29258, 29309-29354. MD2B/HY. MD3B SPEC 867119, 867231 MO-5889. MD11C/HY, MD11C/HD-HY.
18	907834	1	Cotter pin	
19	833492	1	Bracket	MD1B SPEC 867091, 867142, MD1B 867229EARLY TYPE, MD2B SPEC 867094, 867122, 867230 MO-29258, 29309-29354. MD2B/HY. MD3B SPEC 867119, 867231 MO-5889. MD11C/HY, MD11C/HD-HY.
20	959218	1	Screw	MD1B SPEC 867091, 867142, MD1B 867229EARLY TYPE, MD2B SPEC 867094, 867122, 867230 MO-29258, 29309-29354. MD2B/HY. MD3B SPEC 867119, 867231 MO-5889. MD11C/HY, MD11C/HD-HY.
21	941907	1	Spring washer	MD1B SPEC 867091, 867142, MD1B 867229EARLY TYPE, MD2B SPEC 867094, 867122, 867230 MO-29258, 29309-29354. MD2B/HY. MD3B SPEC 867119, 867231 MO-5889. MD11C/HY, MD11C/HD-HY.
22	21882	1	Retainer	MD1B SPEC 867091, 867142, MD1B 867229EARLY TYPE, MD2B SPEC 867094, 867122, 867230 MO-29258, 29309-29354. MD2B/HY. MD3B SPEC 867119, 867231 MO-5889. MD11C/HY, MD11C/HD-HY.
23	955224	1	Screw	MD1B SPEC 867091, 867142, MD1B 867229EARLY TYPE, MD2B SPEC 867094, 867122, 867230 MO-29258, 29309-29354. MD2B/HY. MD3B SPEC 867119, 867231 MO-5889. MD11C/HY, MD11C/HD-HY.
24	819067	1	Brace	
25	956078	2	Screw	
26	963104	2	Nut	
27	818470	1	Control cable	L = 6900 MM
	818478	1	Control	L = 3300 MM
28	955857	2	• Nut	
29	955950	2	• Lock washer	
30	955844	1	• Nut	
31	829241	1	• Handle	
32	829070	1	Cable lock	
33	950363	1	Nut	
34	955894	2	Washer	
35	955897	1	Washer	
36	955341	1	Screw	L = 35 MM
37	957175	2	Gasket	
38	833765	1	Retainer	
39	833764	1	Lever	
40	913125	1	Clevis pin	
41	907824	2	Cotter pin	
42	833763	1	Sleeve	

MD1B,MD2B,MD3B

REF	PART NO.	QTY	DESCRIPTION	NOTES
43	946781	1	O-ring	
44	833761	1	Pin	MD1B, MD2B, MD11C, MD11D.
	833762	1	Pin	MD3B SPEC 867231 MO 5890-. MD17C SPEC 867211, 867231. MD17C/HD-HY, MD17C/HD-BT. MD17D.
45	833078	1	Spring	
46	955961	1	Snap ring	
47	833133	1	Cube	
48	192244	1	Screw	L = 9,5 MM. MD1B, MD2B, MD3B.
49	955892	1	Washer	
50	833462	1	Cube	MD1B SPEC 867229LATE TYPE. MD2B SPEC 867230 MO 29259-29308, 29355-.
51	813042	1	Ball joint	MD3B, MD11C, MD11D, MD17C, MD17D.
52	941905	1	Spring washer	MD3B, MD11C, MD11D, MD17C, MD17D.
53	951784	1	Nut	MD3B, MD11C, MD11D, MD17C, MD17D.
54		1	BRACKET, REVERSE GEAR	SEE GROUP 4A
	829641	1	Bracket	SEE GROUP 4A
55		X	CONTROL CABLE	SEE GROUP 9
56		X	CONTROL	SEE GROUP 9