

D12D-A MG

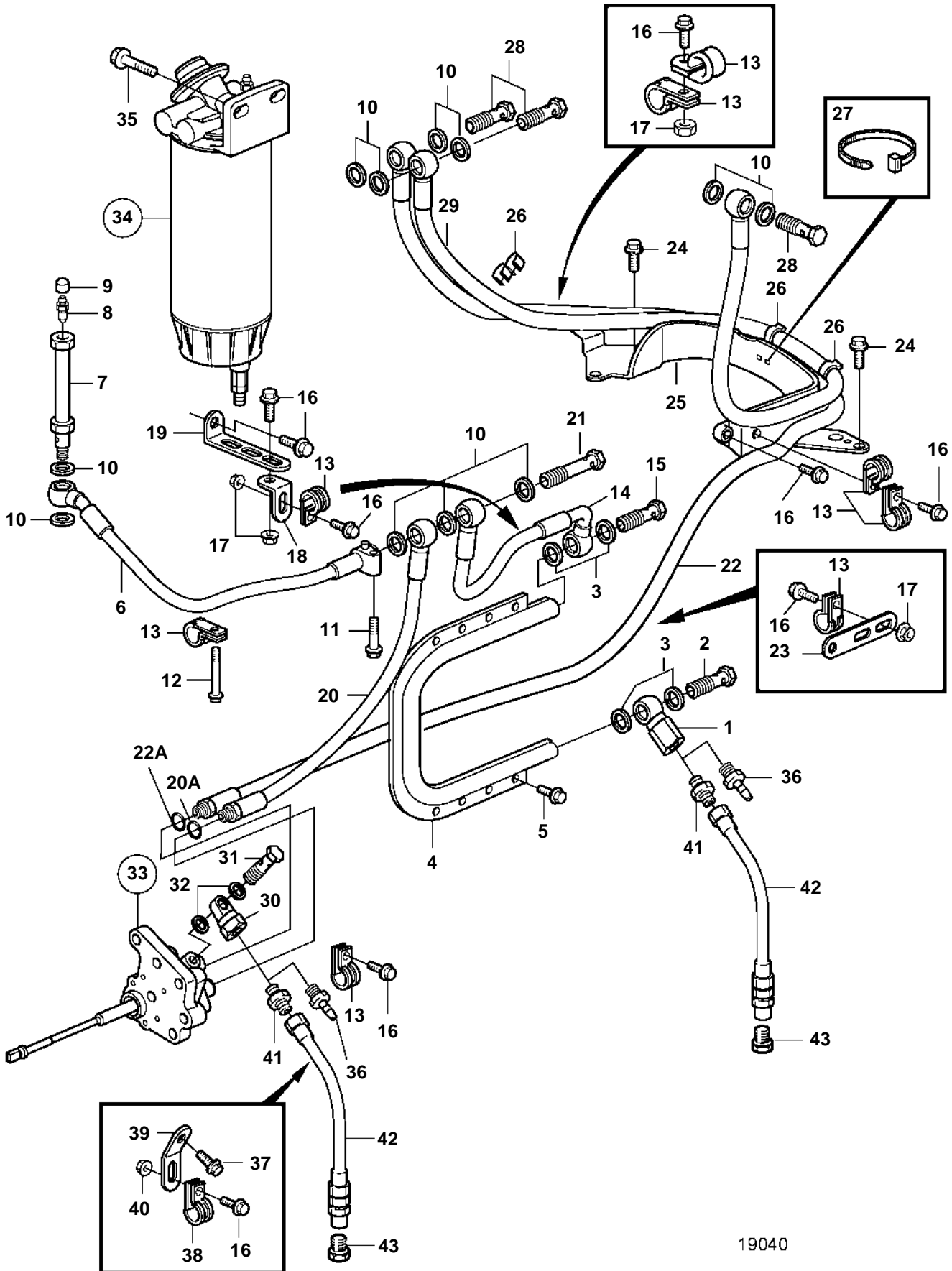

D12D-A MG

REF	PART NO.	QTY	DESCRIPTION	SEE SEC.	NOTES
1	3828976	1	Check valve		
2	25167	1	Hollow screw		
3	969011	4	Gasket		
4	8170282	1	Radiator		For electronic control unit.
5	946934	8	Flange screw		
6	3838162	1	Fuel hose		
7	3828271	1	Hollow screw		
8	1330191	1	Tap		
9	656456	1	Protecting cover		
10	11996	11	Gasket		
11	965183	1	Flange screw		
12	965181	1	Screw		
13	949747	8	Clamp		
14	3832768	1	Fuel hose		
15	25167	1	Hollow screw		
16	946440	9	Flange screw		
17	945408	4	Flange nut		
18	965553	1	Bracket		
19	965562	1	Bracket		
20	3826591	1	Fuel hose		
20A	976971	1	· O-ring		
21	8148244	1	Overflow valve		
22	3837665	1	Fuel hose		
22A	976971	1	· O-ring		
23	965541	1	Bracket		
24	946502	2	Screw		
25	3837245	1	Bracket		
26	9205207	1	Retainer		
27	948211	4	Strip clamp		
28	190713	3	Hollow screw		
29	3837666	1	Fuel hose		
30	3827418	1	Banjo nipple		
31	74033	1	Hollow screw		
32	947620	2	Gasket		
33	3092460	1	Fuel pump		SN-240248
				4295	
	20440371	1	Fuel pump		SN240249-
34	3832690	1	Fuel filter		
				4305	
35	946472	2	Screw		
36	3825000	2	Nipple		ALT
37	945444	1	Flange screw		
38	1545432	1	Clamp		
39	965571	1	Bracket		
40	945408	1	Flange nut		
41	977677	2	Nipple		ALT
42	3826595	2	Fuel hose		ALT
43	22753	2	Nipple		ALT