

MD30A

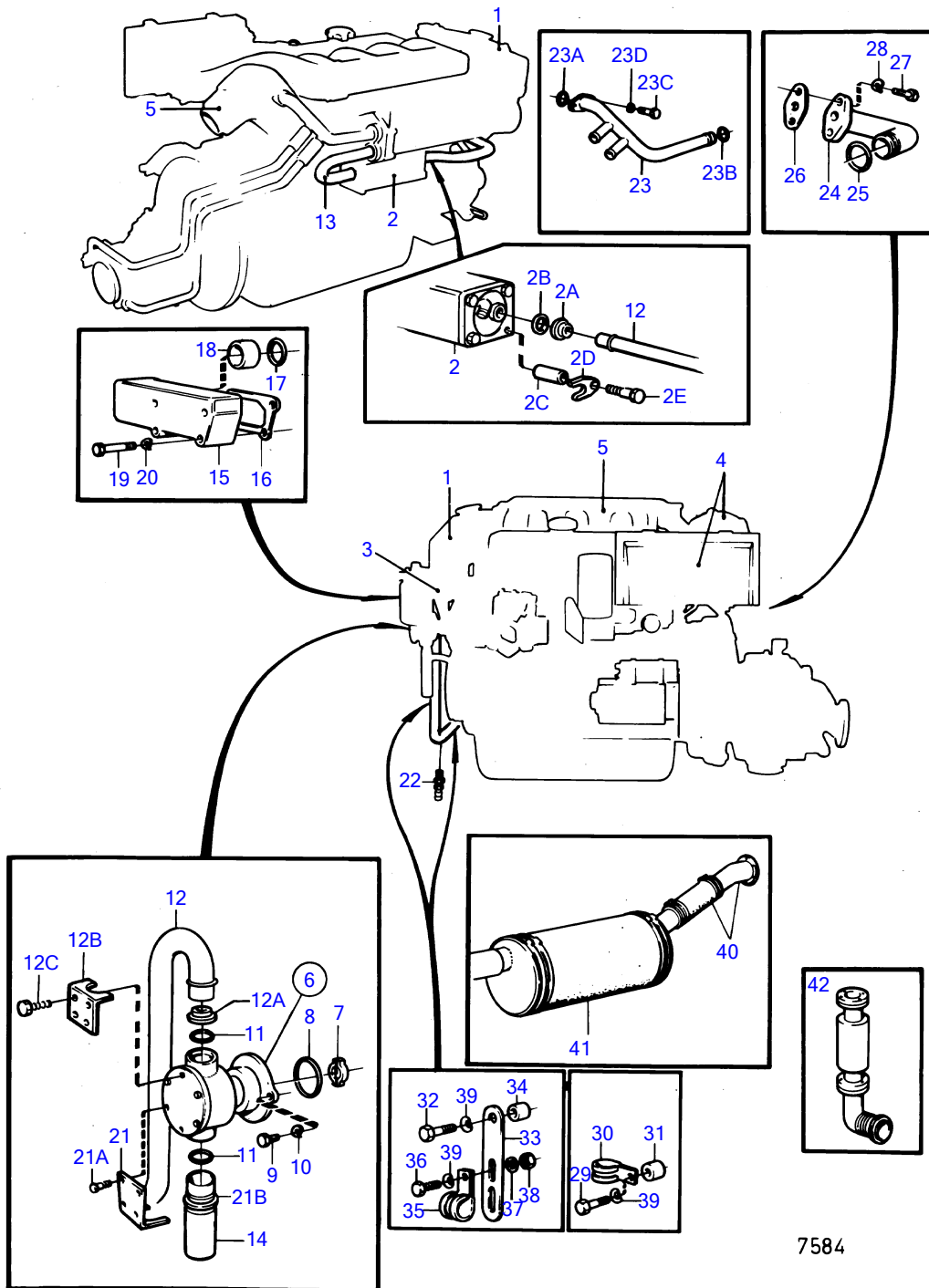

MD30A

| REF | PART NO. | QTY | DESCRIPTION   | SEE SEC. | NOTES               |
|-----|----------|-----|---|----------|---------------------|
| 1   |          | 1   | HEAT EXCHANGER AND THERMOSTAT WITH INSTALLATION COMPONENTS  | 18147    |                     |
| 2   |          | 1   | OIL COOLER  |          |                     |
|     |          |     | .   | 18151    |                     |
| 2A  | 847108   | 1   | Pipe retainer   |          | MO5312-             |
| 2B  | 949658   | 1   | O-ring  |          | (925061)<br>MO5312- |
| 2C  | 807182   | 1   | Spacer sleeve   |          | MO5312-             |
| 2D  | 838970   | 1   | Brace   |          | MO5312-             |
| 2E  | 955299   | 1   | Hexagon screw   |          | MO5312-             |
| 3   |          | 1   | CIRCULATION PUMP WITH INSTALLATION COMPONENTS   | 18149    |                     |
| 4   |          | 1   |   | 18152    |                     |
| 5   |          | 1   | INDUCTION- AND EXHAUST MANIFOLD WITH INSTALLATION COMPONENTS INDUCTION- AND EXHAUST MANIFOLD WITH INSTALLATION CO | 18157    |                     |
| 6   | 838314   | 1   | Sea water pump  |          |                     |
|     |          |     | .   | 18150    |                     |
|     |          |     | .   | 18150    |                     |
| 7   | 829433   | 1   | Dog   |          |                     |
| 8   | 947314   | 1   | O-ring  |          |                     |
| 9   | 955295   | 2   | Hexagon screw   |          |                     |
| 10  | 941907   | 2   | Spring washer   |          |                     |
| 11  | 949658   | 2   | O-ring  |          | (925061)            |
| 12  | 838971   | 1   | Coolant pipe  |          | (846944)<br>MO5312- |
| 12A | 847108   | 1   | Pipe retainer   |          | MO5312-             |
| 12B | 847107   | 1   | Lock brace  |          | MO5312-             |
| 12C | 963545   | 2   | Hexagon screw   |          |                     |
| 13  | 846046   | 1   | Coolant pipe  | 18147    |                     |
| 14  | 847105   | 1   | Pipe  |          |                     |
| 15  | 842697   | 1   | Riser   |          |                     |
| 16  | 1542187  | 1   | Gasket  |          |                     |
| 17  | 925067   | 2   | O-ring  |          |                     |
|     |          |     |   | 18147    |                     |
| 18  | 842965   | 1   | Pipe  | 18147    |                     |
| 19  | 955306   | 3   | Hexagon screw   |          | L = 80 MM           |
|     | 955305   | 1   | Hexagon screw   |          | L = 75 MM           |
| 20  | 941907   | 4   | Spring washer   |          |                     |
| 21  | 847107   | 1   | Lock brace  |          |                     |
| 21A | 963545   | 2   | Hexagon screw   |          |                     |
| 21B | 847108   | 1   | Pipe retainer   |          |                     |
| 22  | 949918   | 1   | Shut-off cock   |          |                     |
| 23  | 846770   | 1   | Tube  | 18147    |                     |
|     |          |     |   |          | SEE GROUP 4A        |
| 23A | 842913   | 1   | Sealing ring  | 18157    |                     |
| 23B | 858986   | 1   | Sealing ring  |          | (842744)            |
| 23  |          |     |   | 18147    |                     |
| 23C | 955271   | 2   | Hexagon screw   | 18157    |                     |
| 23D | 941906   | 2   | Spring washer   | 18157    |                     |
| 26  |          |     |   | 18158    |                     |
| 29  | 955302   | 1   | Hexagon screw   |          | SEE GROUP 2A        |
| 30  | 947827   | 1   | Clamp   |          |                     |
| 31  | 846339   | 1   | Spacer sleeve   |          |                     |
| 32  | 955306   | 1   | Hexagon screw   |          | SEE GROUP 2A        |
| 33  | 965534   | 1   | Bracket   |          |                     |
| 34  | 843075   | 1   | Spacer sleeve   |          |                     |
| 35  | 952635   | 1   | Clamp   |          |                     |

7744050-26-18154

7584

Upd:2010-07-01

MD30A

| REF | PART NO. | QTY | DESCRIPTION                  | SEE SEC. | NOTES        |
|-----|----------|-----|------------------------------|----------|--------------|
| 36  | 955271   | 1   | Hexagon screw                |          |              |
| 37  | 955892   | 1   | Washer                       |          |              |
| 38  | 955781   | 1   | Hexagon nut                  |          |              |
| 39  | 941907   | 2   | Spring washer                |          | SEE GROUP 2A |
| 40  |          | X   | WATER COOLED EXHAUST LINE    |          | SEE GROUP 9  |
| 41  |          | X   | WATER COOLED EXHAUST MUFFLER |          | SEE GROUP 9  |
| 42  |          | X   | DRY EXHAUST LINE             |          | SEE GROUP 9  |