

MD30A

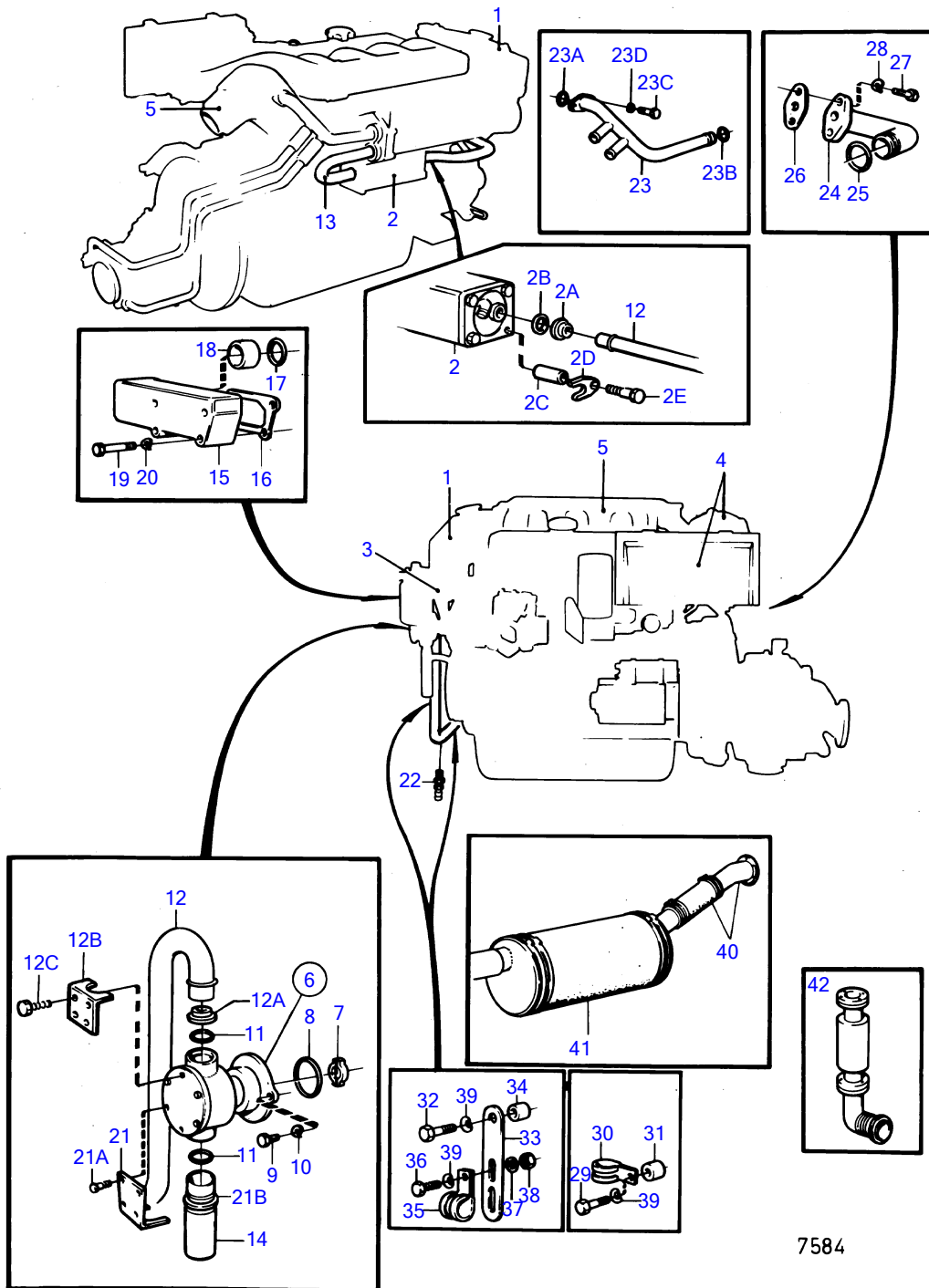

7584

MD30A

| REF | PART NO. | QTY | DESCRIPTION | SEE SEC. | NOTES |
|-----|----------|-----|---|----------|---------------------|
| 1 | | 1 | HEAT EXCHANGER AND THERMOSTAT WITH INSTALLATION COMPONENTS | 18147 | |
| 2 | | 1 | OIL COOLER | | |
| | | | . | 18151 | |
| 2A | 847108 | 1 | Pipe retainer | | MO5312- |
| 2B | 949658 | 1 | O-ring | | (925061) MO5312- |
| 2C | 807182 | 1 | Spacer sleeve | | MO5312- |
| 2D | 838970 | 1 | Brace | | MO5312- |
| 2E | 955299 | 1 | Hexagon screw | | MO5312- |
| 3 | | 1 | CIRCULATION PUMP WITH INSTALLATION COMPONENTS | 18149 | |
| 4 | | 1 | | 18152 | |
| 5 | | 1 | INDUCTION- AND EXHAUST MANIFOLD WITH INSTALLATION COMPONENTS INDUCTION- AND EXHAUST MANIFOLD WITH INSTALLATION CO | 18157 | |
| 6 | 838314 | 1 | Sea water pump | | |
| | | | . | 18150 | |
| | | | . | 18150 | |
| 7 | 829433 | 1 | Dog | | |
| 8 | 947314 | 1 | O-ring | | |
| 9 | 955295 | 2 | Hexagon screw | | |
| 10 | 941907 | 2 | Spring washer | | |
| 11 | 949658 | 2 | O-ring | | (925061) |
| 12 | 838971 | 1 | Coolant pipe | | (846944) MO5312- |
| 12A | 847108 | 1 | Pipe retainer | | MO5312- |
| 12B | 847107 | 1 | Lock brace | | MO5312- |
| 12C | 963545 | 2 | Hexagon screw | | |
| 13 | 846046 | 1 | Coolant pipe | 18147 | |
| 14 | 847105 | 1 | Pipe | | |
| 15 | 842697 | 1 | Riser | | |
| 16 | 1542187 | 1 | Gasket | | |
| 17 | 925067 | 2 | O-ring | | |
| | | | | 18147 | |
| 18 | 842965 | 1 | Pipe | 18147 | |
| 19 | 955306 | 3 | Hexagon screw | | L = 80 MM |
| | 955305 | 1 | Hexagon screw | | L = 75 MM |
| 20 | 941907 | 4 | Spring washer | | |
| 21 | 847107 | 1 | Lock brace | | |
| 21A | 963545 | 2 | Hexagon screw | | |
| 21B | 847108 | 1 | Pipe retainer | | |
| 22 | 949918 | 1 | Shut-off cock | | |
| 23 | 846770 | 1 | Tube | 18147 | |
| | | | | | SEE GROUP 4A |
| 23A | 842913 | 1 | Sealing ring | 18157 | |
| 23B | 858986 | 1 | Sealing ring | | (842744) |
| 23 | | | | 18147 | |
| 23C | 955271 | 2 | Hexagon screw | 18157 | |
| 23D | 941906 | 2 | Spring washer | 18157 | |
| 26 | | | | 18158 | |
| 29 | 955302 | 1 | Hexagon screw | | SEE GROUP 2A |
| 30 | 947827 | 1 | Clamp | | |
| 31 | 846339 | 1 | Spacer sleeve | | |
| 32 | 955306 | 1 | Hexagon screw | | SEE GROUP 2A |
| 33 | 965534 | 1 | Bracket | | |
| 34 | 843075 | 1 | Spacer sleeve | | |
| 35 | 952635 | 1 | Clamp | | |

7744050-26-18154

7584

Upd:2010-07-01

AD30A, AQAD30A, MD30A, TAMD30A, TMD30A, AD30, AQAD30, MD30, TAMD30, TMD30

VOLVO
PENTA

MD30A

| REF | PART NO. | QTY | DESCRIPTION | SEE SEC. | NOTES |
|-----|----------|-----|------------------------------|----------|--------------|
| 36 | 955271 | 1 | Hexagon screw | | |
| 37 | 955892 | 1 | Washer | | |
| 38 | 955781 | 1 | Hexagon nut | | |
| 39 | 941907 | 2 | Spring washer | | SEE GROUP 2A |
| 40 | | X | WATER COOLED EXHAUST LINE | | SEE GROUP 9 |
| 41 | | X | WATER COOLED EXHAUST MUFFLER | | SEE GROUP 9 |
| 42 | | X | DRY EXHAUST LINE | | SEE GROUP 9 |