

MD30A

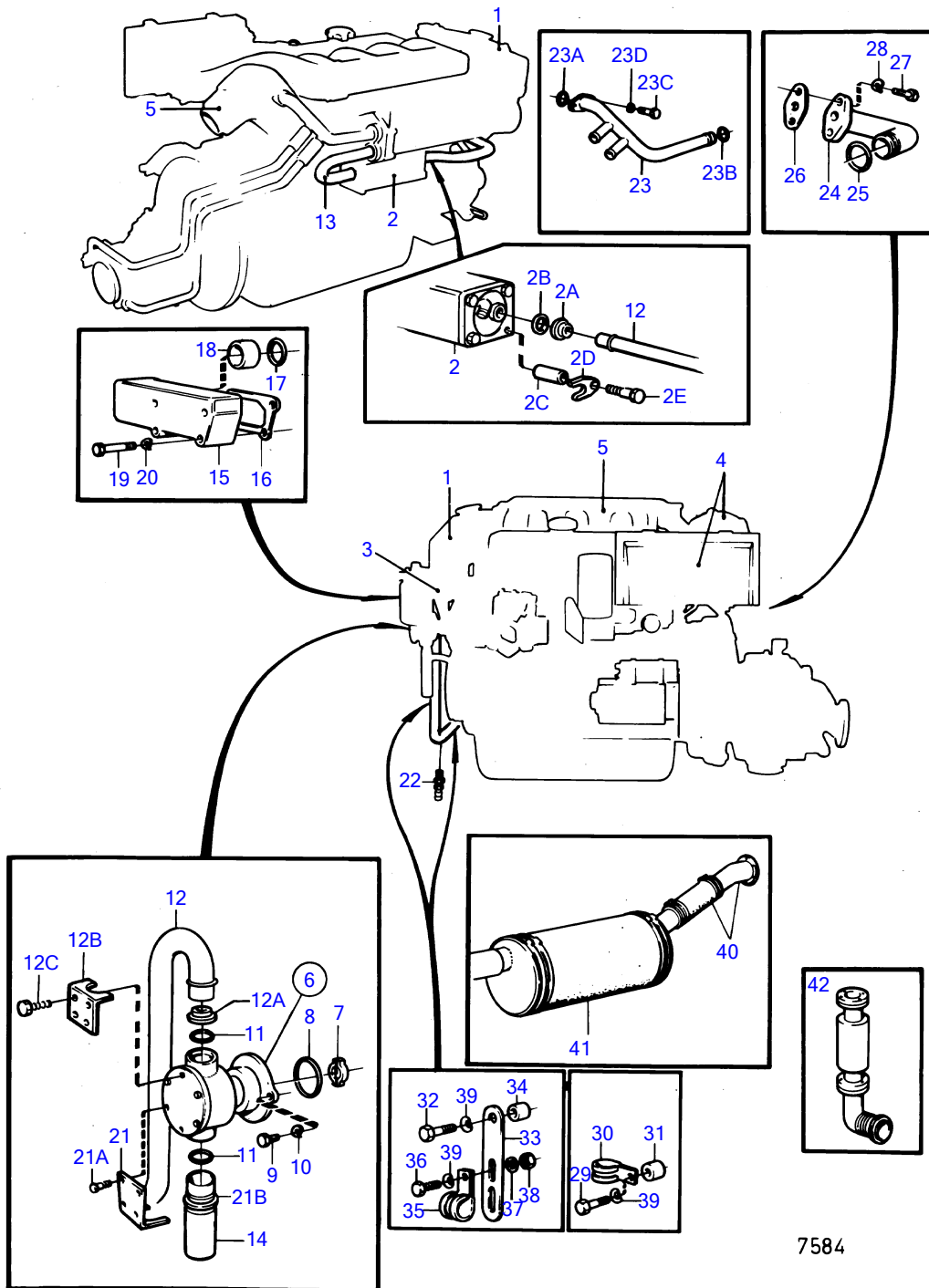

7584

## MD30A

REF	PART NO.	QTY	DESCRIPTION	SEE SEC.	NOTES
1		1	HEAT EXCHANGER AND THERMOSTAT WITH INSTALLATION COMPONENTS	18147	
2		1	OIL COOLER		
			.	18151	
2A	847108	1	Pipe retainer		MO5312-
2B	949658	1	O-ring		(925061) MO5312-
2C	807182	1	Spacer sleeve		MO5312-
2D	838970	1	Brace		MO5312-
2E	955299	1	Hexagon screw		MO5312-
3		1	CIRCULATION PUMP WITH INSTALLATION COMPONENTS	18149	
4		1		18152	
5		1	INDUCTION- AND EXHAUST MANIFOLD WITH INSTALLATION COMPONENTS INDUCTION- AND EXHAUST MANIFOLD WITH INSTALLATION CO	18157	
6	838314	1	Sea water pump		
			.	18150	
			.	18150	
7	829433	1	Dog		
8	947314	1	O-ring		
9	955295	2	Hexagon screw		
10	941907	2	Spring washer		
11	949658	2	O-ring		(925061)
12	838971	1	Coolant pipe		(846944) MO5312-
12A	847108	1	Pipe retainer		MO5312-
12B	847107	1	Lock brace		MO5312-
12C	963545	2	Hexagon screw		
13	846046	1	Coolant pipe	18147	
14	847105	1	Pipe		
15	842697	1	Riser		
16	1542187	1	Gasket		
17	925067	2	O-ring		
				18147	
18	842965	1	Pipe	18147	
19	955306	3	Hexagon screw		L = 80 MM
	955305	1	Hexagon screw		L = 75 MM
20	941907	4	Spring washer		
21	847107	1	Lock brace		
21A	963545	2	Hexagon screw		
21B	847108	1	Pipe retainer		
22	949918	1	Shut-off cock		
23	846770	1	Tube	18147	
					SEE GROUP 4A
23A	842913	1	Sealing ring	18157	
23B	858986	1	Sealing ring		(842744)
23				18147	
23C	955271	2	Hexagon screw	18157	
23D	941906	2	Spring washer	18157	
26				18158	
29	955302	1	Hexagon screw		SEE GROUP 2A
30	947827	1	Clamp		
31	846339	1	Spacer sleeve		
32	955306	1	Hexagon screw		SEE GROUP 2A
33	965534	1	Bracket		
34	843075	1	Spacer sleeve		
35	952635	1	Clamp		

7744050-26-18154

7584

Upd:2010-07-01

AD30A, AQAD30A, MD30A, TAMD30A, TMD30A, AD30, AQAD30, MD30, TAMD30, TMD30



MD30A

REF	PART NO.	QTY	DESCRIPTION	SEE SEC.	NOTES
36	955271	1	Hexagon screw		
37	955892	1	Washer		
38	955781	1	Hexagon nut		
39	941907	2	Spring washer		SEE GROUP 2A
40		X	WATER COOLED EXHAUST LINE		SEE GROUP 9
41		X	WATER COOLED EXHAUST MUFFLER		SEE GROUP 9
42		X	DRY EXHAUST LINE		SEE GROUP 9