

Lube Pump Salvage

3375206

Lube Pump Boring Tool

Engine Series: K19, NH, NT, V903

This is a precision boring tool designed to bore replacement bushings in the lubricating oil pumps and covers. A special setting fixture and tool bit allows the flexibility to bore the old style lube pumps as well as the single lube pumps.

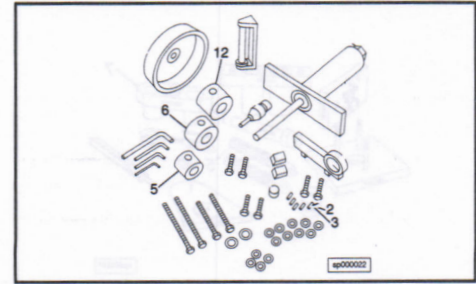

Ref. No.	Part No.	Description
2	3375225	Tool Bit (1/2 in.)
3	3375226	Tool Bit (3/8 in.)
5	3375221	Guide Bushing (NH Small Gear) (1.844 in.)
6	3375222	Guide Bushing (NT, K19 Large Gear) (2.411 in.)
12	3375412	Guide Bushing (V903) (2.408 in.)

3822290

Lube Pump Salvage Kit

Engine Series: K50

This special kit contains the fixture to align and guide a special size reamer to ream replacement bushings in the lubricating oil pump. The template is used to align the new grooved bushings used on later version lubricating oil pumps.

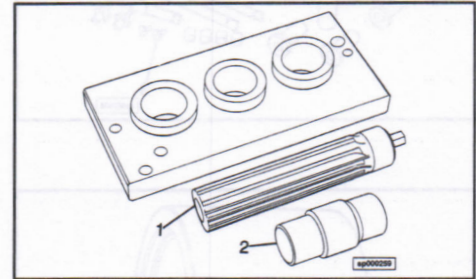

Ref. No.	Part No.	Description
1	3823382	Reamer
2	3824450	Bushing Driver
	3824423	Alignment Template

3822291

Lube Pump Salvage Kit

Engine Series: K38

This special fixture is used to align and guide the reamer to finish ream replacement bushings in the lube pump. A special template is also provided to align the new grooved bushings being used on later version lubricating oil pumps.

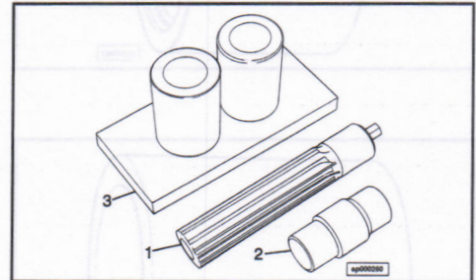

Ref. No.	Part No.	Description
1	3823382	Reamer
2	3824450	Bushing Driver
3	3823381	Fixture
	3824423	Alignment Template



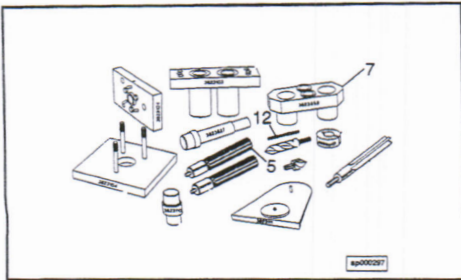

3823101
Lube Pump Salvage Kit

Engine Series: K50

This kit allows replacement of shaft bearings and also updates older pumps to the current style. (2-Gear Low Speed)

Ref. No.	Part No.	Description
	3823102	Shaft Bearing Reamer Kit (2-Gear Low Speed)
5	3823382	Bushing Reamer
7	3823859	Gear Pocket Spot Fixture
12	3823525	Straight Shank Drill

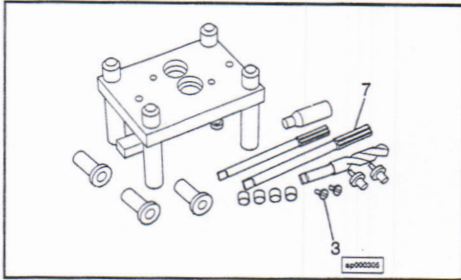

3823188
Lube Pump Salvage Kit

Engine Series: L10

This is a special fixture designed to salvage the lube pump by installing bushings into the lube pump body and cover.

Ref. No.	Part No.	Description
3	3822399	Lockscrew
7	3823195	Reamer (.5942)

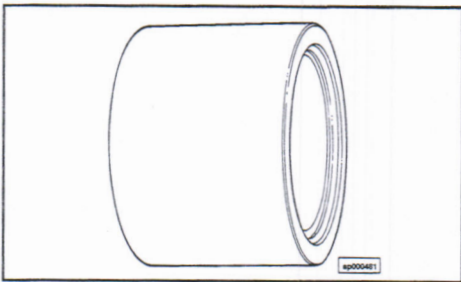

Mandrels

ST 511
Gear Mandrel

Engine Series: NH

This tool is used to press the gear onto the lube pump drive shaft to allow proper protrusion.

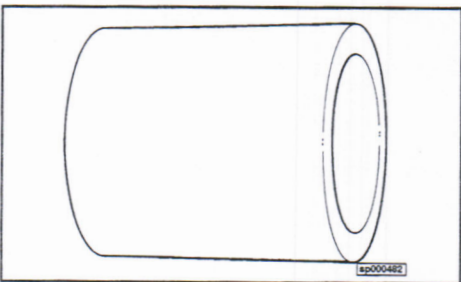

ST 512
Lube Pump Shaft Spacer

Engine Series: NH

This tool is used to press the gear shaft in the lubricating oil pump to the proper assembled height on older model engines H, NH, 4 7/8 and 5 1/8 bore engines.

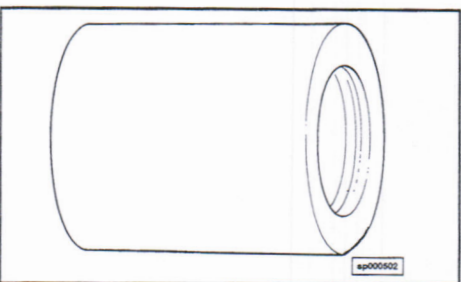

ST 722
Gear Mandrel

Engine Series: V903

This tool is used to install the idler gear shaft into the lubricating oil pump body to the proper assembled height. This tool applies to V6-200 and V8-265 and V903.

ST 994
Bushing Mandrel

Engine Series: NH, NT

This driver is used to remove or install the drive shaft bushings in the lubricating oil pump.

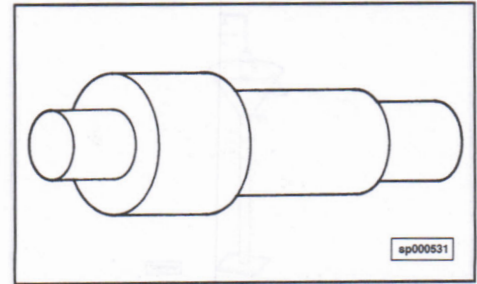

ST 1157
Gear Spacer Mandrel

Engine Series: NT

This driver serves 2 purposes. One end is used to install the idler shaft into the body to the proper assembled height and the other end is used when pressing the driven gear onto the shaft to the proper position. This tool applies to the single-double capacity lube pump.

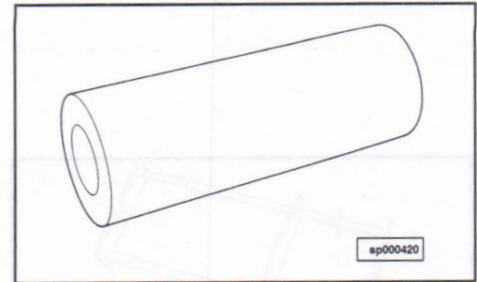

ST 1158
Bushing Mandrel

Engine Series: NT

This tool is used to install or remove the bushings from the single-double capacity lubricating oil pump.

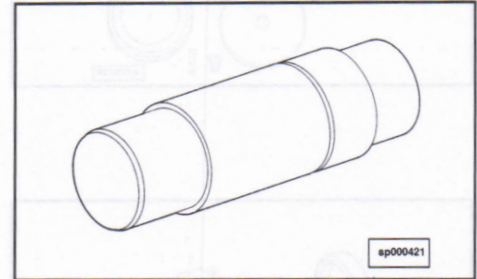

ST 1218
Lube Cooler O'ring Mandrel

Engine Series: C & J, NH, NT, V378, V555, V903, V504

These drivers are used to install the o'rings around the lubricating oil cooler tube bundle after the tube bundle has been installed in the cooler housing. These drivers assure that the o'ring is installed properly without twisting or damage to the o'ring.

Part No.	Description
ST 1218	Mandrel (5 inch cooler NH, NT, V903)
ST 1223	Lube Cooler O'ring Mandrel (4 inch cooler C & J, V378, V504, V555)

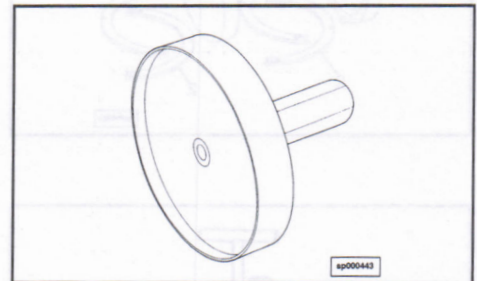

3377255
Gear Mandrel

Engine Series: V903

The deep end of this tool is used to press the drive gear onto the shaft to the proper height. The shallow end is used to install the main drive gear shaft to the proper location.

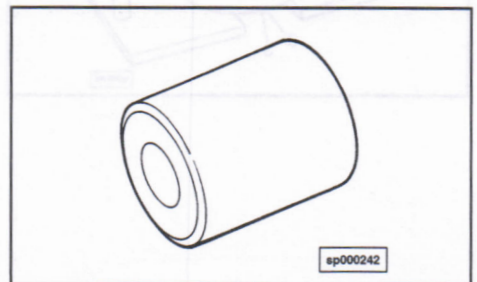

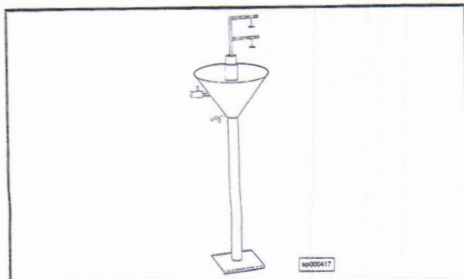

Miscellaneous

ST 1135 Lube Oil Sampling Filter

Engine Series: All

This special stand is often called a "mini patch" filter system. This unit is used to obtain sample of oil during engine testing of a rebuilt engine. A special mini patch filter is contained in the cap to trap contaminants. The mini patch can be removed for observation to check for foreign material in the oil galleries before final testing.

Part No.	Description
3376380	Orifice Block Kit (V28, K38 and K50)
ST 1135-12	Filter Disc Retainer Filter Disc
ST 1135-14	Gasket

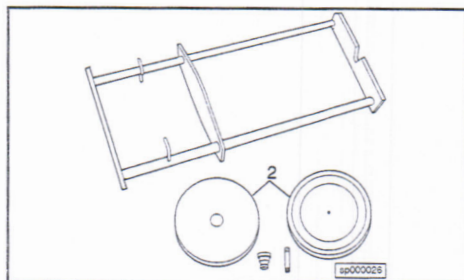

3375253 Oil Cooler Bundle Tester

3375253

Oil Cooler Bundle Tester

Engine Series: C & J, NH, NT, V555, V903

This kit contains 2 end plates with stepped inside diameters for testing the larger as well as the smaller tube bundles. The fixture is used to contain the end plates when applying low air pressure to test for air leaks while submerged in warm water.

Ref. No.	Part No.	Description
2	3375255	End Plate

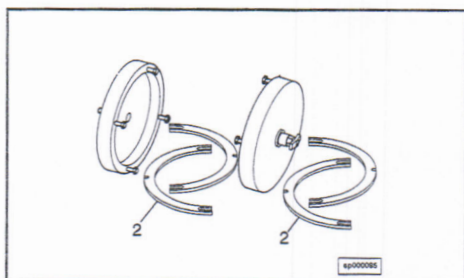

3375859

Oil Cooler Bundle Tester

Engine Series: V28

These special end plates attach to the tube bundle to seal the tube bundle. Apply low air pressure to one end and submerge in water to test for air leaks (air bubbles).

Ref. No.	Part No.	Description
2	3375858	Clamp

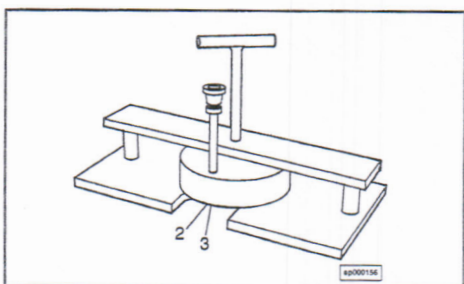

3376765

Oil Cooler Bundle Tester

Engine Series: NT

This special fixture is designed to check tube bundles for leaks when servicing the lubricating oil cooler NT Phase 3 series engines.

Ref. No.	Part No.	Description
2	3376767	O'ring Seal
3	3376768	Bundle End Plate

3376861
Oil Cooler Bundle Tester

Engine Series: L10

This kit contains 2 end plates and gaskets to seal the ends of the lube oil cooler to test for leaks.

Ref. No.	Part No.	Description
1	3376866	Gasket
3	3376889	3 Hole Plate

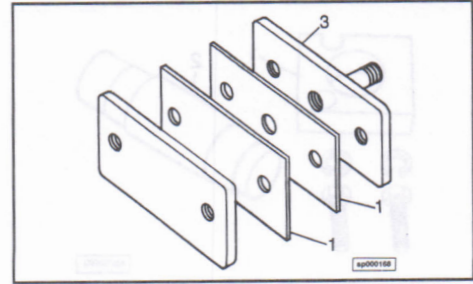

3823876
Lube Oil Cooler Test Kit

Engine Series: B and C Series

This is a special design aluminum plate to seal and pressurize the lube oil cooler to test for leaks. All o'rings and accessories are provided.

Ref. No.	Part No.	Description
1	3823877	O'ring Kit (Qty 3)
2	ST 990-40	Pressure Regulator
3	ST 1141-9	Pressure Gauge (0-160 psi)

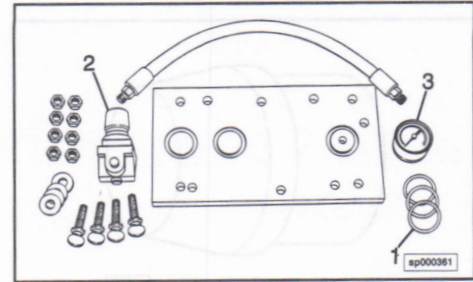

Removers and Installers

ST 1115
Disassembly Fixture

Engine Series: V28

This fixture is used to remove the lubricating oil pump front cover from the body.

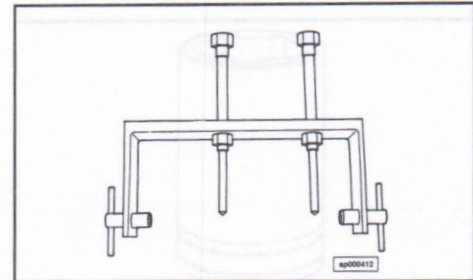

3375055
Pressure Regulator Removal Tool

Engine Series: K19

This combination of tools is used to remove the lubricating oil pump pressure regulator from the pump without removing the pump from the engine.

Ref. No.	Part No.	Description
1	3375056	Compressor Bar
2	3375057	Snap Ring Pliers

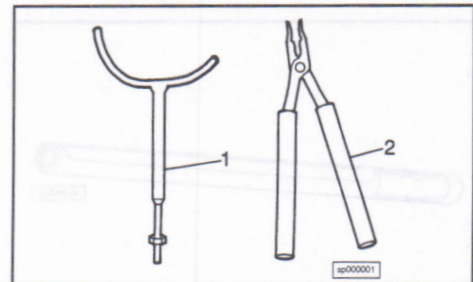

3375082
Lube Pump Gear Puller

Engine Series: NH, NT

These special pullers are used to remove the drive gears from the drive shaft.

Part No.	Description
3375082	Gear Puller (used to remove 143190 gear)
3375083	Lube Pump Gear Puller (used to remove 125988 gear)

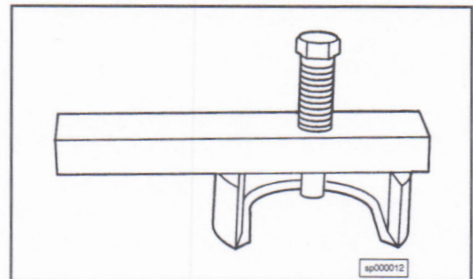

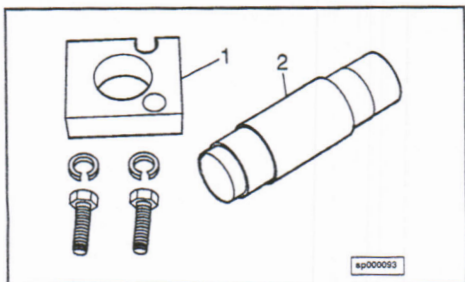

3376011
DFC Pressure Valve Fixture

Engine Series: NT

This fixture is used to install the high pressure limit valve into the DFC (Demand Flow Cooling) lubricating oil pump. This fixture allows the assembly to be easily installed to the proper depth in the pump body. This tool is used on Big Cam II.

Ref. No.	Part No.	Description
1	3376013	Locating Fixture
2	3376012	Mandrel

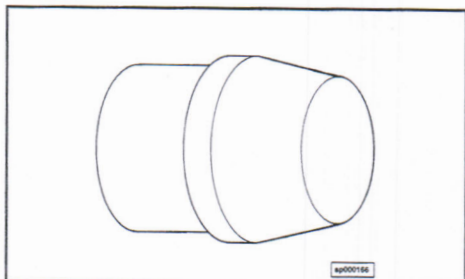

3376844
O'ring Expander

Engine Series: NT

This special pilot is designed to install the lube oil suction tube during assembly to prevent shearing of the o'ring on NT Big Cam III.

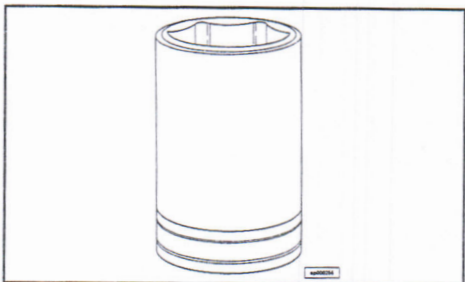

3377443
Filter Head Adapter Socket

Engine Series: Big Cam III & IV

This is a special machined socket to remove or install the filter head full flow adapter. (1 1/2 in.)

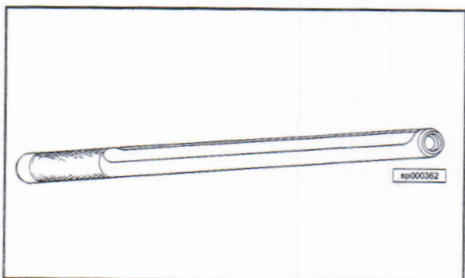

3823875
Dipstick Tube Installer

Engine Series: B and C Series

This tool is designed to install the dipstick tube easily and without damage to the stop flange.