

32 Loctite "RCA/680" Retaining Compound (92-809833)

- 7 Loctite "271" Adhesive Sealant (92-809819)
- 23 Soap (Purchase Locally)
- 36 P80 Rubber Lubricant (Purchase Locally)
- 82 Permabond 105 Cyanacrylate Adhesive (Purchase Locally)
- 95 2-4-C w/Teflon (92-850738A1)
- 96 Loctite Superbond 454 Gel (Purchase Locally)

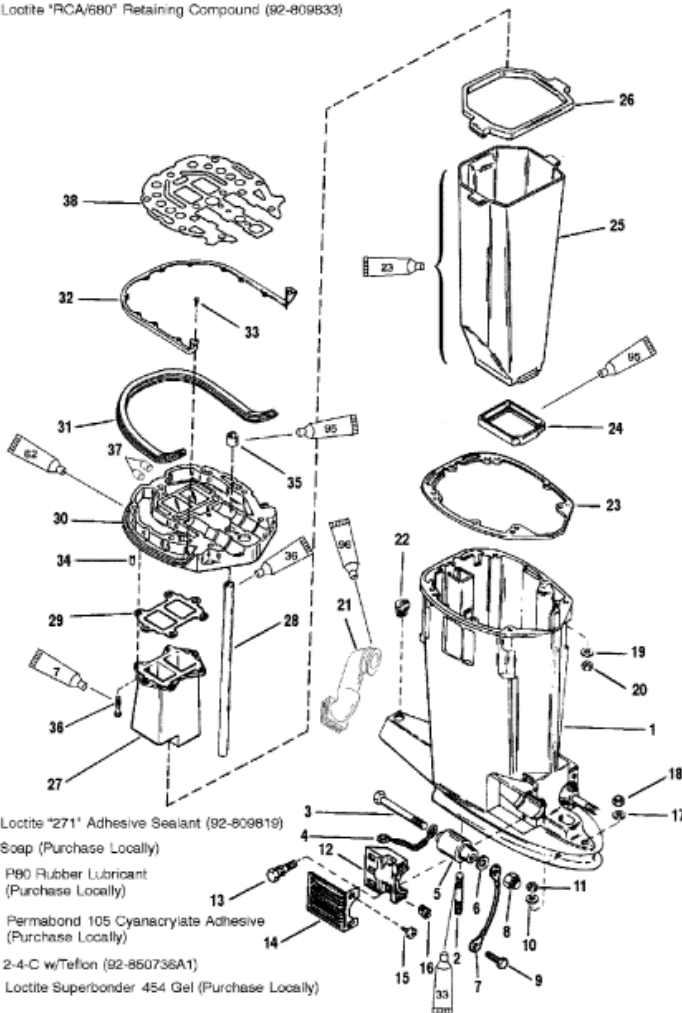

9317

Parts List

Ref	Class	Part	Description	Qty	Comment	Footnote
1	1530	8343T10	DRIVESHAFT HOUSING	1	(LONG) (BLACK)	
1	3503	813563T 1	DRIVESHAFT HOUSING	1	(X-LONG) (BLACK)	
2	16	56295	STUD, .437 x 2.69	2		
3	10	63474	SCREW, (.50-20 x 6)	2		
4		88238A10	GROUND WIRE ASSEMBLY	1		
5		77327	MOUNT	2		
6	12	49339	WASHER, (13/16)	2		
7		88238A10	GROUND WIRE ASSEMBLY	1		
8	11	28040	NUT	2		
9	10	41508	SCREW, (.250-20 x .50)	1		
10	12	45176	WASHER	2		
11	11	34933	NUT, (.437-20)	2		
12	54	67076	CLAMP	2		
13	10	66727	SCREW, (.3125-18 x 1.25)	4		
14		67077T	COVER	2		
15	10	88417	SCREW, (#12-24 x .620)	4		
16	11	35521	NUT	4		
17	12	48926	WASHER	1		
18	11	34933	NUT, (.437-20)	1		
19	12	20553	WASHER	4		
20	11	69254	NUT	4		
21		828212	IDLE EXHAUST BOOT	1		
22	19	64649	PLUG	1		
23	27	99173 2	GASKET	1		2
24		66350	SEAL (LOWER)	1		
25		18276	EXHAUST TUBE	1		
26		17726 1	SEAL (UPPER)	1		
27		812834	EXHAUST EXTENSION	1	(150)	
27		41942F 3	EXHAUST EXTENSION	1	(135)	
28	32	67295	TUBE	1	(LONG)	
28	32	74729	TUBE	1	(X-LONG)	
29	27	78246	GASKET	1	(USE WHERE APPLICABLE)	2
30		18233A 6	PLATE ASSEMBLY	1		
31		814701 2	SEAL	1		
32		68011	BRACKET	1		
33	10	812832	SCREW, (#10-16 x .500)	12		
34	17	43044	PIN, Dowel	2		
35	26	38970	SEAL	1		2
36	10	90192	SCREW, (.250-20 x .750)	6		
37	22	39072	PLUG	2	(USE WHERE APPLICABLE)	
38	27	18207 1	GASKET	1		2