

32 Loctite "RCA/680" Retaining Compound (92-809833)

- 7 Loctite "271" Adhesive Sealant (92-809819)
- 23 Soap (Purchase Locally)
- 36 P80 Rubber Lubricant (Purchase Locally)
- 82 Permabond 105 Cyanacrylate Adhesive (Purchase Locally)
- 95 2-4-C w/Teflon (92-850738A1)
- 96 Loctite Superbond 454 Gel (Purchase Locally)

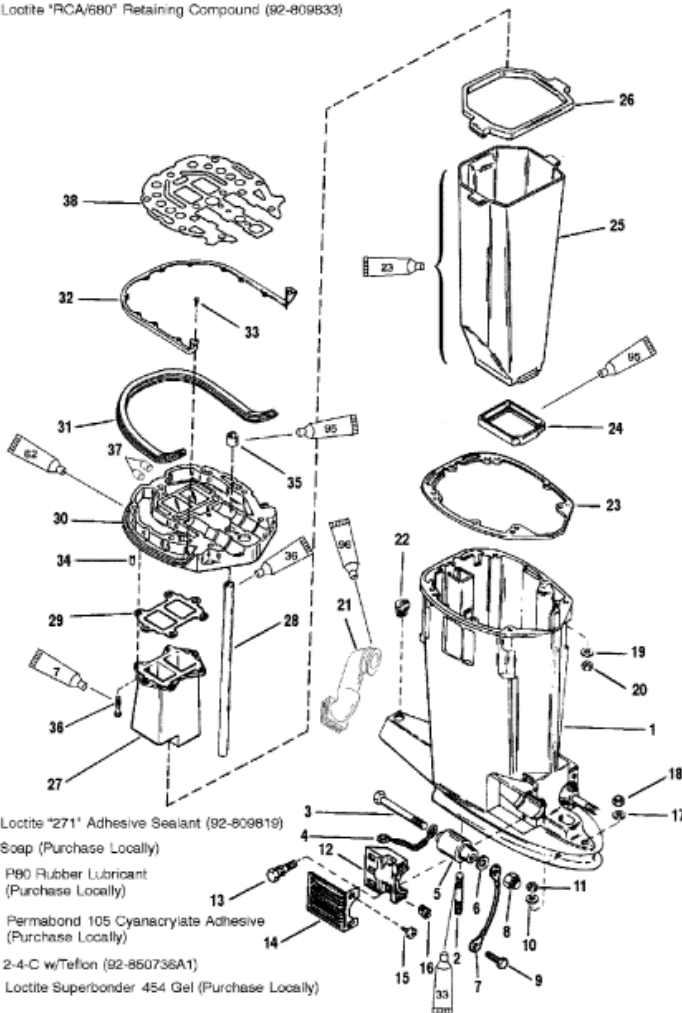

9317

Parts List

| Ref | Class | Part | Description | Qty | Comment | Footnote |
|-----|-------|-----------|--------------------------|-----|------------------------|----------|
| 1 | 1530 | 8343T10 | DRIVESHAFT HOUSING | 1 | (LONG) (BLACK) | |
| 1 | 3503 | 813563T 1 | DRIVESHAFT HOUSING | 1 | (X-LONG) (BLACK) | |
| 2 | 16 | 56295 | STUD, .437 x 2.69 | 2 | | |
| 3 | 10 | 63474 | SCREW, (.50-20 x 6) | 2 | | |
| 4 | | 88238A10 | GROUND WIRE ASSEMBLY | 1 | | |
| 5 | | 77327 | MOUNT | 2 | | |
| 6 | 12 | 49339 | WASHER, (13/16) | 2 | | |
| 7 | | 88238A10 | GROUND WIRE ASSEMBLY | 1 | | |
| 8 | 11 | 28040 | NUT | 2 | | |
| 9 | 10 | 41508 | SCREW, (.250-20 x .50) | 1 | | |
| 10 | 12 | 45176 | WASHER | 2 | | |
| 11 | 11 | 34933 | NUT, (.437-20) | 2 | | |
| 12 | 54 | 67076 | CLAMP | 2 | | |
| 13 | 10 | 66727 | SCREW, (.3125-18 x 1.25) | 4 | | |
| 14 | | 67077T | COVER | 2 | | |
| 15 | 10 | 88417 | SCREW, (#12-24 x .620) | 4 | | |
| 16 | 11 | 35521 | NUT | 4 | | |
| 17 | 12 | 48926 | WASHER | 1 | | |
| 18 | 11 | 34933 | NUT, (.437-20) | 1 | | |
| 19 | 12 | 20553 | WASHER | 4 | | |
| 20 | 11 | 69254 | NUT | 4 | | |
| 21 | | 828212 | IDLE EXHAUST BOOT | 1 | | |
| 22 | 19 | 64649 | PLUG | 1 | | |
| 23 | 27 | 99173 2 | GASKET | 1 | | 2 |
| 24 | | 66350 | SEAL (LOWER) | 1 | | |
| 25 | | 18276 | EXHAUST TUBE | 1 | | |
| 26 | | 17726 1 | SEAL (UPPER) | 1 | | |
| 27 | | 812834 | EXHAUST EXTENSION | 1 | (150) | |
| 27 | | 41942F 3 | EXHAUST EXTENSION | 1 | (135) | |
| 28 | 32 | 67295 | TUBE | 1 | (LONG) | |
| 28 | 32 | 74729 | TUBE | 1 | (X-LONG) | |
| 29 | 27 | 78246 | GASKET | 1 | (USE WHERE APPLICABLE) | 2 |
| 30 | | 18233A 6 | PLATE ASSEMBLY | 1 | | |
| 31 | | 814701 2 | SEAL | 1 | | |
| 32 | | 68011 | BRACKET | 1 | | |
| 33 | 10 | 812832 | SCREW, (#10-16 x .500) | 12 | | |
| 34 | 17 | 43044 | PIN, Dowel | 2 | | |
| 35 | 26 | 38970 | SEAL | 1 | | 2 |
| 36 | 10 | 90192 | SCREW, (.250-20 x .750) | 6 | | |
| 37 | 22 | 39072 | PLUG | 2 | (USE WHERE APPLICABLE) | |
| 38 | 27 | 18207 1 | GASKET | 1 | | 2 |